



Prices effective February 5, 2018

Resolve® System

Introduction	page 2
Resolve® System	3
Infrastructure	5
Work Surfaces	52
Storage	67
Display Components	94
Lighting	104
Indices	107
By Name	107
By Number	109
Appendices	
20-Day or Less/Assigned Lead-Time Order Information	
Keyed-Alike Information	
Vary Easy Program	
Fire Retardancy-Resolve System	
Stain-to-Match Program	
Customer's Own Material Order Information-Resolve System	
Design on Textile (DOT™) and Customer's Own Image (COI) Order Information	
Design on Textile (DOT) Collection	
Proprietary Textiles Application Chart-Workspaces	
Proprietary Textile Colors-Workspaces	
For the latest materials information, refer to the Materials pages on HermanMiller.com.	

Introduction

A Note on the Organization of This Book

There are a few signals that will help you understand the organization of this book. Once you know them, you should be able to find your way around easily.

Like a newspaper, this book is formatted with columns of text and illustrations that run vertically.

Information wraps from one column to the next and continues for as many pages as it needs to.

Black bars are clues.

A black bar at the top of a page signals the start of information about a product.

This information is divided into two sections, each signaled by a black bar. Product Information includes a description, additional notes, and dimensional drawings. Specification Information, which always begins at the top of a column, includes a series of steps. Each step represents a decision you need to make in order to complete your product number. Steps must be followed sequentially. The number of pages needed to complete information on a product varies; some will be complete in one page; others may fill three or four pages. Just continue going through the steps until you run into the next product, signaled by the black bar at the top of the page.

Black tabs running along the outside edge of the page help you locate what section you are in or what section you want to go to. You can thumb forwards or backwards to find a section; tabs and text appear on both sides of the page.

The additional pages in the back of the book include the appendices and indices. They are signaled by a long black bar running along the outside edge of the page.

The index is presented two ways.

The first index is in alphabetical order by product name. It can be helpful if you are new to the products and numbering scheme or if you are looking for a type of product, such as work chair or round table. The second index is by product number. It lists, in alphanumeric order, the base product number, typically a five-digit number.

This book is effective February 5, 2018, subject to change without notice. Products may be purchased from authorized Herman Miller dealers who will quote prices upon request. For more information about our products and services or to see a list of dealers, visit www.HermanMiller.com.

All prices are list prices in US Dollars. Additional services, such as planning services, design, storage, and installation, are not included and must be added to these prices when the additional services are requested.

Illustrations, specifications, and prices are based on the latest information at the time of publication. The right is reserved to make changes at any time without notice in prices, fabrics, finishes, materials, specifications, and models, and also to discontinue models and finishes.

Dimensions shown in the drawings are engineering drawing dimensions rounded up to the nearest 1/8". Product is shipped set up or knocked down. Products that include "Shipped knocked down" in the description require some assembly. If this statement does not appear in the description, the product is shipped assembled.

Service problems are normally handled by a Herman Miller authorized dealer. Where this cannot be accomplished on a local level, service problems should be referred to the Customer Care Representative for your region, Herman Miller, Inc., Zeeland, Michigan 49464.

20-Day or Less/Assigned Lead-Time Shipments

All products and options in this price book not designated by an Assigned Program icon  will ship in **20 business days or less** after being acknowledged by Herman Miller.

Products and options designated by an  are on the assigned lead-time program and may ship in 20 days, less than 20 days, or more than 20 days from order acknowledgement.

Infrastructure

Work Surfaces

Storage

Display Components

Lighting



Tall Pole

R1110.

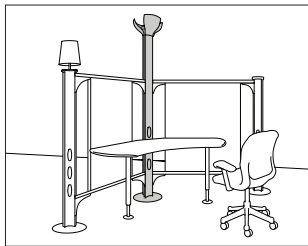

Product Information

Description

This 96"-high, 3-sided pole forms 120° connections between support arms. It attaches to trusses and allows overhead delivery of power and/or data. Each pole has 3 petals and a crown at the top and a 2" adjustable base that adjusts the pole height in 1/2" increments. The N, R, and P power options have 9 receptacle location covers; each side of the pole is prepunched to hold 3 duplex receptacles.

The pole is available nonpowered or powered. The powered pole has a 3-sided, 6-circuit electrical harness on the inside of the pole. The pole is UL listed; electrical components are UL listed and CSA certified.

The field-wired version of the tall pole (R1110.R) meets Chicago electrical code requirements. This version can also be used internationally and is compatible with most international electrical systems and components.

Notes

Order following products separately:

- Fixed truss (R1220.) or sliding truss (R1230.)
- Support arms (R1210.)

To manage data cables, order 1 of the following products separately:

- Cable bag (R1365.)
- Cable cover (R1361.)
- Cable management clips (R1362.)

To attach data ports to outside of pole, order data faceplate housing (R1360.) separately.

For powered pole, order 6-circuit duplex receptacle (R1311.) separately.

To add simplex receptacles to crown, order simplex receptacle (R1312.) separately.

To convert nonpowered pole with cutouts to powered pole, order tall pole power harness (R1380.) separately.

To pass power over the top of nonpowered pole, order power block (R1382.) separately.

To add duplex receptacle to field-wired pole (R1110.R), order receptacle box/cover (R1313.) separately. Receptacle box/cover accepts standard-size faceplates and duplex receptacles (supplied by electrician).

To supply power to field-wired pole (R1110.R) from the floor or wall, order power entry plate (R1325.) separately.

Nonpowered pole without cutouts (R1110.A) cannot be converted to a powered pole.

Dimensions

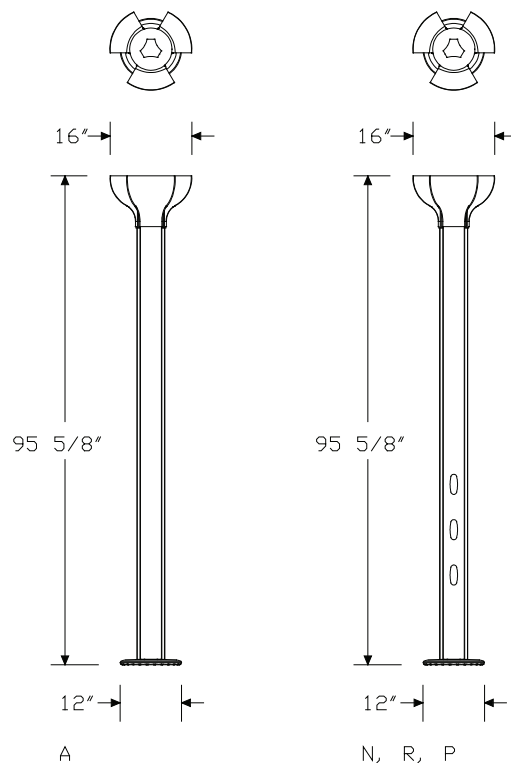

Specification Information

Step 1.

R1110.

Step 2. Power

- A** nonpowered, no cutouts
- N** nonpowered, with cutouts
- R** nonpowered, field wired (meets Chicago electrical code requirements)
- P** powered

Prices for Steps 1-2.

R1110. A	\$667
N	\$696
R	\$937
P	\$1113

Step 3. Pole/Crown Finish

8Q	folkstone grey	+\$0
LU	soft white	+\$0
CN	metallic champagne	+\$0
EH	metallic bronze	+\$0
MS	metallic silver	+\$0

Step 4. Base/Trim Finish

3G	brownstone	+\$0
8Q	folkstone grey	+\$0
CL	cool grey neutral	+\$0
LU	soft white	+\$0
WL	sandstone	+\$0
WN	warm grey neutral	+\$0

Short Pole

R1120.

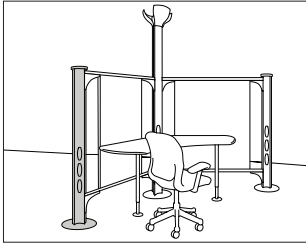

Product Information

Description

This 48"- or 60"-high, 3-sided pole forms 120° connections between support arms. Each pole has a top cap and a 2" adjustable base that adjusts the pole height in 1/2" increments. The N, R, and P power options have 9 receptacle location covers; each side of the pole is prepunched to hold 3 duplex receptacles.

The pole is available nonpowered or powered. The powered pole has a 3-sided, 6-circuit electrical harness on the inside of the pole. The pole is UL listed; electrical components are UL listed and CSA certified.

The field-wired version of the short pole (R1120.48R and R1120.60R) meets Chicago electrical code requirements. This version can also be used internationally and is compatible with most international electrical systems and components.

Notes

Standing-height monitor pod, standing-height café table, pole accent light, and 60"- and 69"-high boundary and display screens cannot be used with 48"-high short pole.

Order support arms (R1210.) separately.

To manage data cables, order 1 of the following products separately:

- Cable bag (R1365.)
- Cable cover (R1361.)
- Cable management clips (R1362.)

To attach data ports to outside of pole, order data faceplate housing (R1360.) separately.

For powered pole, order 6-circuit duplex receptacle (R1311.) separately.

To convert nonpowered pole with cutouts to powered pole, order short pole power harness (R1381.) separately.

To add duplex receptacle to field-wired pole (R1120.60R), order receptacle box/cover (R1313.) separately. Receptacle box/cover accepts standard-size faceplates and duplex receptacles (supplied by electrician).

To supply power to field-wired pole (R1120.60R), order power entry plate (R1325.) separately.

Order optional pole lamp (R6310.) or Chicago pole lamp (R6311.) separately.

Nonpowered pole without cutouts (R1120.A) cannot be converted to a powered pole.

Dimensions

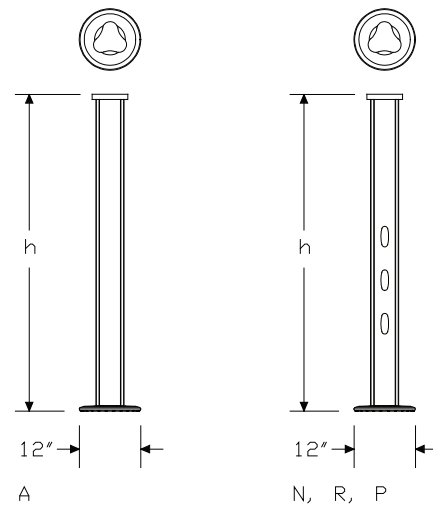

Specification Information				
Step 1.				
R1120.				
Step 2. Height				
48	48" high			
60	60" high			
Step 3. Power				
A	nonpowered, no cutouts			
N	nonpowered, with cutouts			
R	nonpowered, field wired (meets Chicago electrical code requirements)			
P	powered			
Prices for Steps 1-3.				
	A	N	R	P
R1120. 48	\$367	396	521	672
60	\$433	467	575	739
Step 4. Pole Finish				
8Q	folkstone grey			+\$0
LU	soft white			+\$0
CN	metallic champagne			+\$15
EH	metallic bronze			+\$15
MS	metallic silver			+\$15
Step 5. Base/Trim Finish				
3G	brownstone			+\$0
8Q	folkstone grey			+\$0
CL	cool grey neutral			+\$0
LU	soft white			+\$0
WL	sandstone			+\$0
WN	warm grey neutral			+\$0

In-Line Pole

R1140.

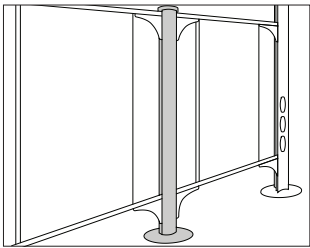

Product Information
Description
This 2-sided pole forms a 180° connection between support arms. It is available in a 48", 60", or 72" height and has a top cap and a 2" adjustable base that adjusts the pole height in 1/2" increments. The in-line pole does not accommodate power or data cables. The pole is UL listed.
Notes
Order support arms (R1210.) separately.
Dimensions

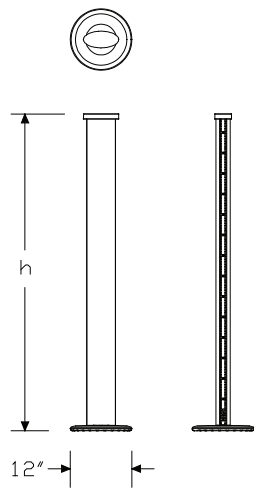

Specification Information
Step 1.
R1140.
Step 2. Height
48 48" high
60 60" high
72 72" high
Prices for Steps 1-2.
R1140. 48 \$325
60 \$397
72 \$425
Step 3. Pole Finish
8Q folkstone grey +\$0
LU soft white +\$0
CN metallic champagne +\$20
EH metallic bronze +\$20
MS metallic silver +\$20
Step 4. Base/Top Cap Finish
3G brownstone +\$0
8Q folkstone grey +\$0
CL cool grey neutral +\$0
LU soft white +\$0
WL sandstone +\$0
WN warm grey neutral +\$0

Resolve® Infrastructure

Seismic Clip

R1190.

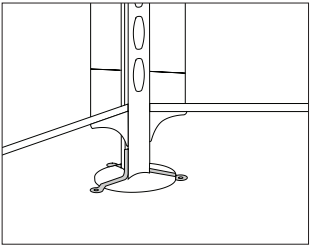

Resolve® Infrastructure

Product Information

Description
This clip secures a tall, short, or in-line pole to the floor in regions where seismic activity is a concern or where required by local code. 3 clips are required for each tall or short pole; 2 clips are required for each in-line pole. Hardware to secure the clips to the pole is included; hardware to secure the clips to the floor is not included. Package contains 6.

Notes
Seismic clips must be field installed.

Dimensions

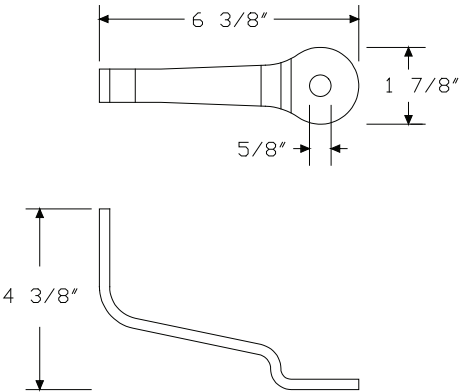

Specification Information

Step 1.		
R1190.		\$95
Step 2. Finish		
8Q	folkstone grey	+\$0
LU	soft white	+\$0
CN	metallic champagne	+\$0
EH	metallic bronze	+\$0
MS	metallic silver	+\$0

Support Arms

R1210.

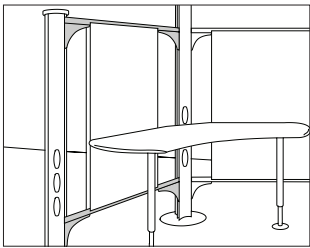

Product Information
Description
These arms connect to tall, short, or in-line poles to create boundaries and hold components and accessories. They are available in 48" or 60" lengths as measured from the center axis of the connecting poles. Package includes an upper support arm and lower support arm. Support arms are UL listed.
Notes
Order screens separately:
• Boundary screen (R1410.)
• Display screen (R1420.)
• Marker screen (R1450.)
Order arm-attached storage separately:
• Arm-attached cabinet (R3221.)
• Ladder shelf (R3312.)
• Tool rail (R3610.)
To distribute power and data on lower support arm, order power/data channel (R1351.) separately.
Dimensions

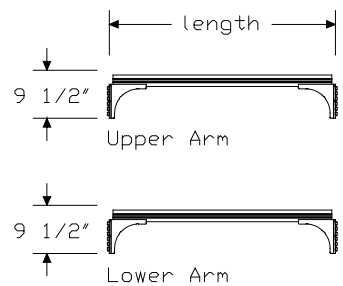

Specification Information
Step 1.
R1210.
Step 2. Length
48 48" long
60 60" long
Prices for Steps 1-2.
R1210. 48 \$254
60 \$297
Step 3. Finish
8Q folkstone grey +\$0
LU soft white +\$0
CN metallic champagne +\$0
EH metallic bronze +\$0
MS metallic silver +\$0

Resolve® Infrastructure

Fixed Truss

R1220.

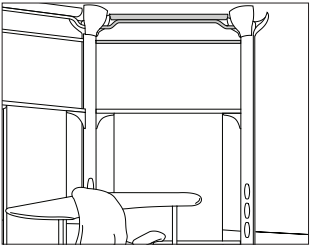

Resolve® Infrastructure

Product Information

Description

This truss attaches to 2 tall poles and delivers overhead power and/or data, creates boundaries, and can be used over an aisle. A steel barrier separates power and data cables in the trough. The truss is available nonpowered or powered and in 5 lengths. The powered truss has a 6-circuit electrical harness on the inside of the trough. The truss is UL listed; electrical components are UL listed and CSA certified.

Notes

To convert nonpowered truss to powered truss, order fixed truss power jumper conversion kit (R1345.) separately.
For cable capacity information, see Cable Capacity Charts in Omni.

Dimensions

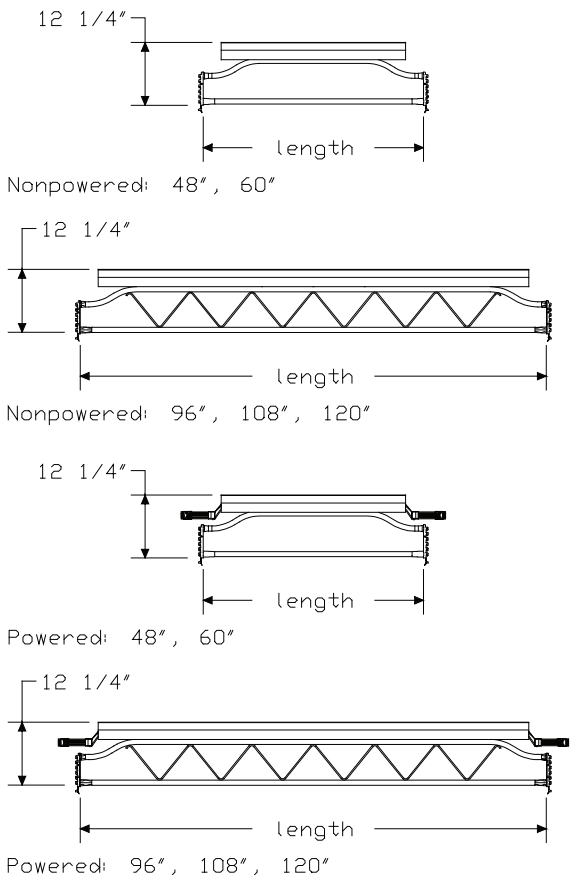

Specification Information

Step 1.

R1220.

Step 2. Length

048	48" long
060	60" long
096	96" long
108	108" long
120	120" long

Step 3. Power

N	nonpowered
P	powered

Prices for Steps 1-3.

	N	P
R1220. 048	\$456	685
060	\$526	785
096	\$803	1125
108	\$876	1218
120	\$946	1326

Step 4. Truss/Bracket Finish

8Q	folkstone grey	+\$0
LU	soft white	+\$0
CN	metallic champagne	+\$0
EH	metallic bronze	+\$0
MS	metallic silver	+\$0

Step 5. Trough Finish

3G	brownstone	+\$0
8Q	folkstone grey	+\$0
CL	cool grey neutral	+\$0
LU	soft white	+\$0
WL	sandstone	+\$0
WN	warm grey neutral	+\$0

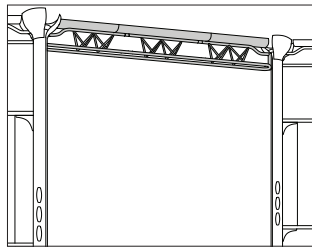

Product Information

Description

This truss joins 2 tall poles and connects 2 separate constellations. It delivers overhead power and/or data, creates boundaries, and can be used over an aisle. A steel barrier separates power and data cables in the trough. The truss has 3 adjustable lengths: 9' to 12', 12' to 16', or 16' to 20'; attachment brackets at each end rotate the truss 62° to the left and right of center.

The truss is available nonpowered or powered. The powered truss has a 6-circuit electrical harness on the inside of the trough. The truss is UL listed; electrical components are UL listed and CSA certified.

Notes

To convert nonpowered truss to powered truss, order sliding truss power jumper conversion kit (R1346.) separately.

For cable capacity information, see Cable Capacity Charts in Omni.

Dimensions

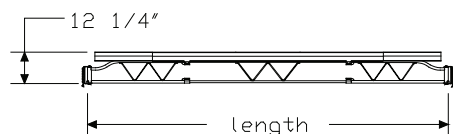

Nonpowered

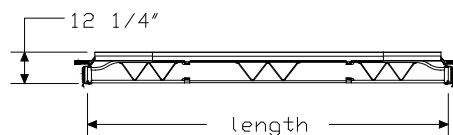

Powered

Specification Information

Step 1.

R1230.

Step 2. Length

0912	extends from 9' to 12'
1216	extends from 12' to 16'
1620	extends from 16' to 20'

Step 3. Power

N	nonpowered
P	powered

Prices for Steps 1-3.

	N	P
R1230. 0912	\$1855	2517
1216	\$2085	2749
1620	\$2317	2979

Step 4. Truss/Bracket Finish

8Q	folkstone grey	+\$0
LU	soft white	+\$0
CN	metallic champagne	+\$0
EH	metallic bronze	+\$0
MS	metallic silver	+\$0

Step 5. Trough Finish

3G	brownstone	+\$0
8Q	folkstone grey	+\$0
CL	cool grey neutral	+\$0
LU	soft white	+\$0
WL	sandstone	+\$0
WN	warm grey neutral	+\$0

Floor/Wall Power Entry

R1320.

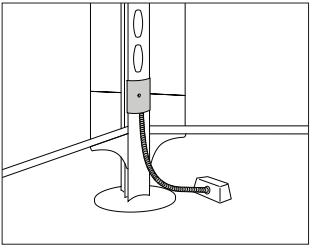

Resolve® Infrastructure

Product Information

Description
This power entry connects a building’s electrical supply from a wall, floor, or column to the power harness of a tall or short pole. It distributes up to 6 20-amp circuits and is available in 4 lengths, which can be field cut to the appropriate length. The power entry plugs directly into the pole’s electrical harness and uses 1 of the lowest receptacle openings. It is UL listed and CSA certified. Attachment hardware is included.

Notes
Licensed electrician must wire power entry.

Dimensions

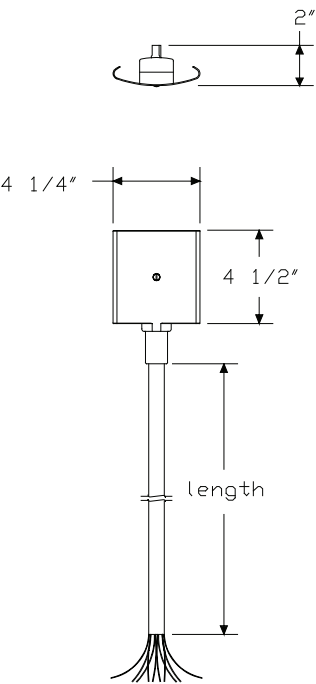

Specification Information

Step 1.		
R1320.		
Step 2. Length		
06	6' long	
12	12' long	
18	18' long	
24	24' long	
Prices for Steps 1-2.		
R1320. 06		\$238
12		\$306
18		\$375
24		\$444
Step 3. Receptacle Filler Finish		
3G	brownstone	+\$0
8Q	folkstone grey	+\$0
CL	cool grey neutral	+\$0
LU	soft white	+\$0
WL	sandstone	+\$0
WN	warm grey neutral	+\$0

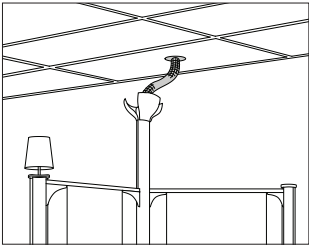

Product Information

Description

This power/data entry connects a ceiling's electrical supply to a power harness or power block at the top of a tall pole. It distributes up to 6 20-amp circuits. The entry is available in 3 mesh-wrap lengths and includes a ceiling bezel connector. The mesh wrap and ceiling bezel connector are off white. The entry is UL listed and CSA certified.

The entry is available nonpowered or powered. The powered entry includes a flex-conduit harness with a crown-mounting bracket and power whip that is 4' longer than the mesh wrap to allow flexibility during installation.

Notes

A licensed electrician must wire the power entry.

For cable capacity information, see Cable Capacity Charts in Omni.

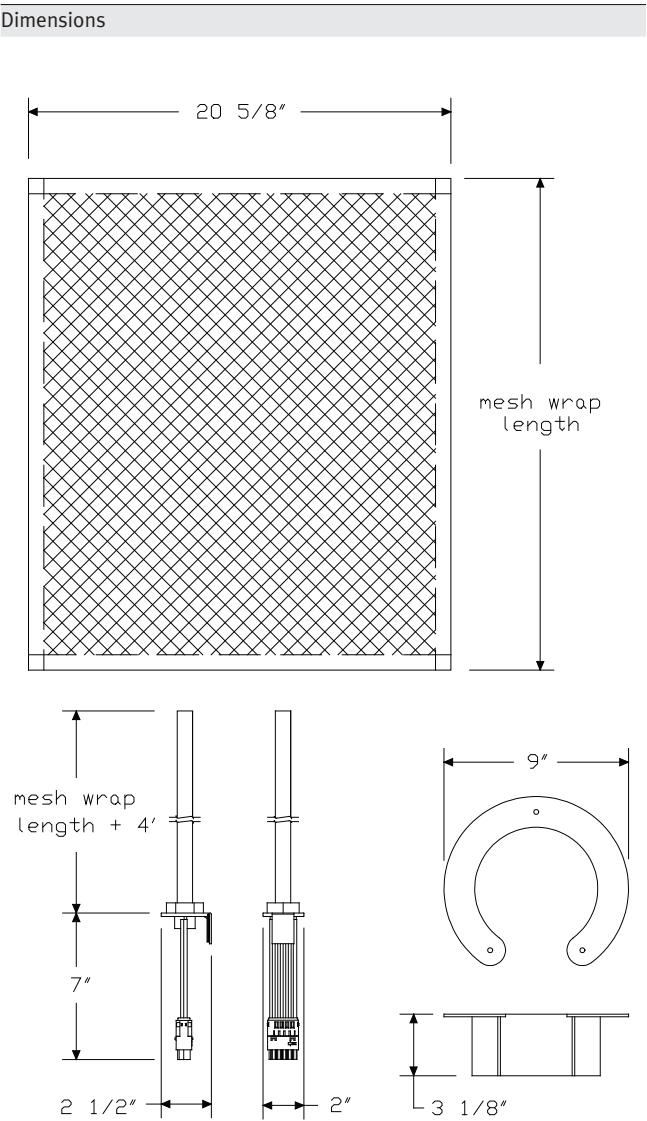

Specification Information

Step 1.

R1332.

Step 2. Mesh Wrap Length

02 2' long

04 4' long

06 6' long

Step 3. Power

N nonpowered

P powered

Prices for Steps 1-3.

	N	P
R1332. 02	\$171	402
04	\$203	497
06	\$232	558

Floor/Wall Power Entry,
New York City

R1321.

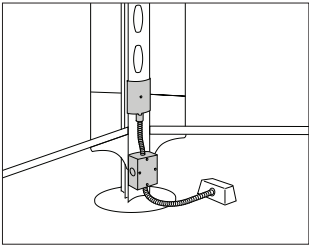

Product Information
Description
This power entry connects a building's electrical supply from a wall, floor, or column to the power harness of a tall or short pole with cutouts. It distributes up to 6 20-amp circuits. The power entry plugs directly into the pole's electrical harness and uses 1 of the lowest receptacle openings. It also includes an electrical box and cover that is connected by conduit. The power entry is UL listed. Attachment hardware is included.
Notes
Licensed electrician must wire power entry.
Dimensions

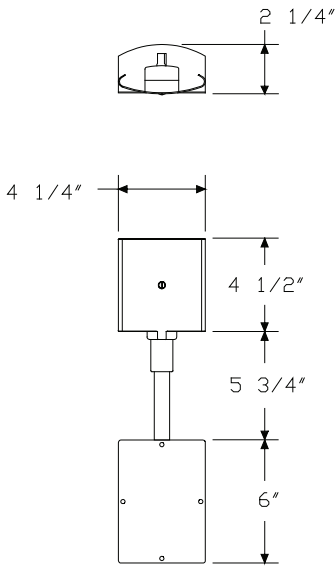

Specification Information
Step 1.
R1321.
Step 2. Electrical Box/Cover Finish
8Q folkstone grey
LU soft white
CN metallic champagne
EH metallic bronze
MS metallic silver
Step 3. Receptacle Filler Finish
3G brownstone
8Q folkstone grey
CL cool grey neutral
LU soft white
WL sandstone
WN warm grey neutral

Resolve® Infrastructure

Ceiling Power/Data Entry,
New York City

R1331.

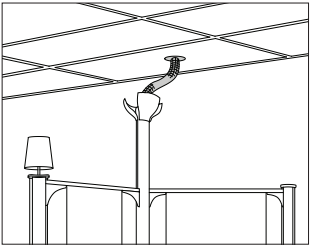

Resolve® Infrastructure

Product Information

Description
This power/data entry connects a ceiling’s electrical supply to a power harness at the top of a tall pole. It distributes up to 6 20-amp circuits. The entry includes a mesh wrap for wire/cable management, a ceiling bezel connector, and a power harness and junction box that mounts to the pole’s crown. The mesh wrap is available in 3 lengths. The entry is UL listed.

Notes
Licensed electrician must wire power entry.
For cable capacity information, see Cable Capacity Charts in Kiosk.

Dimensions

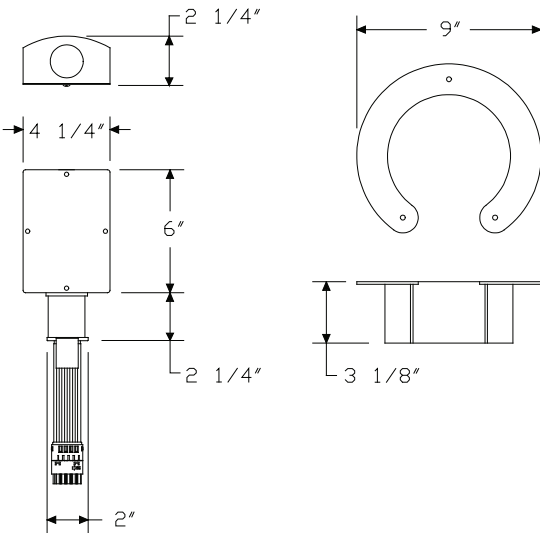
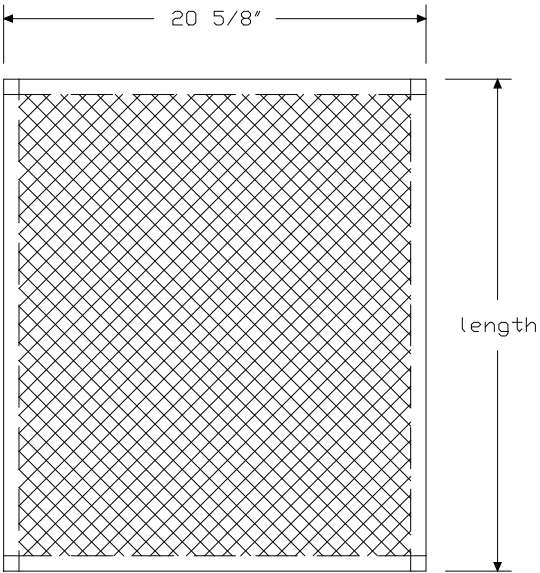

Specification Information		
Step 1.		
R1331.		
Step 2. Mesh Wrap Length		
02	2' long	
04	4' long	
06	6' long	
Prices for Steps 1-2.		
R1331. 02		\$501
04		\$557
06		\$612

Power Entry Plate

R1325.

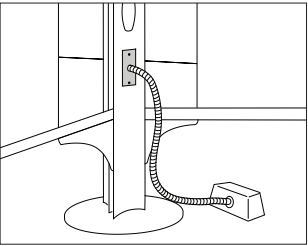

Resolve® Infrastructure

Product Information

Description
This plate covers receptacle openings on a field-wired tall or short pole. It includes a knockout that allows conduit to be routed into the pole. Package contains 6.

Notes
Specify power entry plate for use with poles that are field wired for international use or to meet Chicago electrical codes: tall pole (R1110.R) or short pole (R1120.60R).

Dimensions

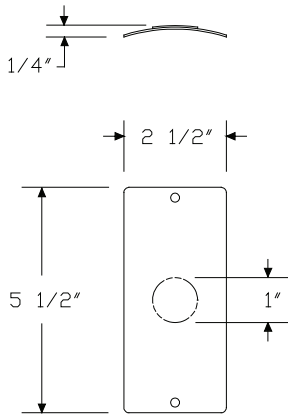

Specification Information

Step 1.		
R1325.		\$65
Step 2. Finish		
8Q	folkstone grey	+\$0
LU	soft white	+\$0
CN	metallic champagne	+\$0
EH	metallic bronze	+\$0
MS	metallic silver	+\$0

Receptacle Box/Cover

R1313.

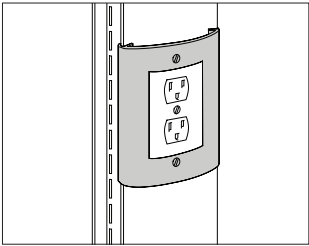

Product Information
Description
This product attaches to a field-wired tall or short pole. It includes an electrical junction box and cover that attach to a field-wired pole's receptacle opening. Package contains 6.
Notes
Specify receptacle box/cover for use with poles that are field wired for international use or to meet Chicago electrical codes: tall pole (R1110.R) or short pole (R1120.6oR).
Dimensions

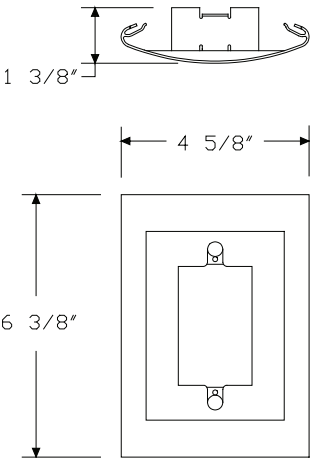

Specification Information
Step 1.
R1313.
\$388
Step 2. Box Finish
8Q folkstone grey
LU soft white
CN metallic champagne
EH metallic bronze
MS metallic silver
Step 3. Cover Finish
3G brownstone
8Q folkstone grey
CL cool grey neutral
LU soft white
WL sandstone
WN warm grey neutral

Resolve® Infrastructure

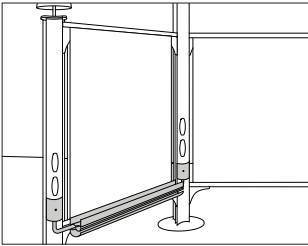

Resolve® Infrastructure

Product Information

Description

This channel mounts between 2 poles above the lower support arm and distributes power and data. It includes 3 channels: 1 for cables and power cords, 1 for an optional power harness, and 1 for data cables. The channel is available nonpowered or powered and in a 48" or 60" length. The powered center channel includes a power jumper with a flex-conduit harness; its direct connects on each end plug into the adjacent pole's electrical harness at the lowest receptacle opening. The channel is UL listed and CSA certified.

Notes

Specify length of channel to match length of support arms.
For cable capacity information, see Cable Capacity Charts in Omni.

Dimensions

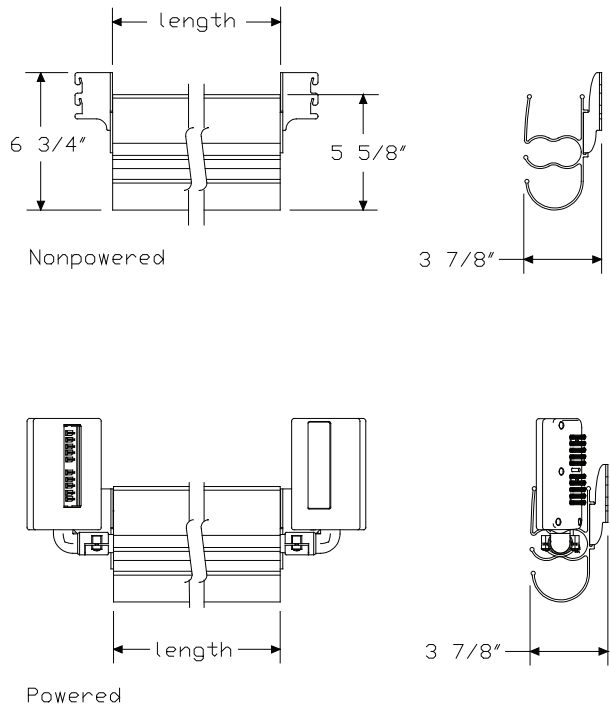

Specification Information

Step 1.

R1351.

Step 2. Length

048 48" long
060 60" long

Step 3. Power

N nonpowered
P powered

Prices for Steps 1-3.

	N	P
R1351. 048	\$161	354
060	\$177	417

Step 4. Bracket Finish

8Q	folkstone grey	+\$0
LU	soft white	+\$0
CN	metallic champagne	+\$0
EH	metallic bronze	+\$0
MS	metallic silver	+\$0

Step 5. Channel Finish

3G	brownstone	+\$0
8Q	folkstone grey	+\$0
CL	cool grey neutral	+\$0
LU	soft white	+\$0
WL	sandstone	+\$0
WN	warm grey neutral	+\$0

Power Jumper Conversion Kit,
Power/Data Channel

R1341.

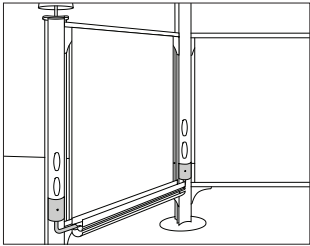

Product Information
<p>Description</p> <p>This kit converts a nonpowered power/data channel(s) to a powered power/data channel(s). It distributes up to 6 20-amp circuits and is available in 5 lengths. The kit includes a flex-conduit harness with direct connects on each end that plug into the adjacent tall or short pole's electrical harness at the lowest receptacle opening. It is UL listed and CSA certified.</p>
<p>Notes</p> <p>Specify length of conversion kit to match distance between the 2 connecting powered poles.</p> <p>When power is routed past a nonpowered in-line pole, specify length of conversion kit to match combined length of the 2 connecting power/data channels.</p>
<p>Dimensions</p>

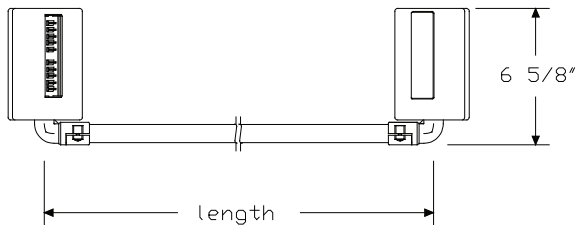

Specification Information		
Step 1.		
R1341.		
Step 2. Length		
048	48" long	
060	60" long	
096	96" long	
108	108" long	
120	120" long	
Prices for Steps 1-2.		
R1341. 048		\$196
060		\$246
096		\$349
108		\$382
120		\$417
Step 3. Finish		
3G	brownstone	+\$0
8Q	folkstone grey	+\$0
CL	cool grey neutral	+\$0
LU	soft white	+\$0
WL	sandstone	+\$0
WN	warm grey neutral	+\$0

Power Pass-Through Bracket

R1352.

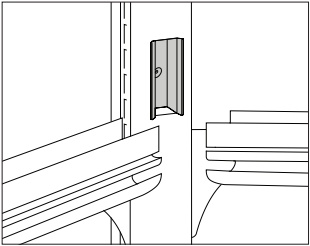

Resolve® Infrastructure

Product Information

Description
This mounting bracket fits into a nonpowered pole’s receptacle location. It allows power to pass from a powered pole, through a nonpowered pole, and onto another powered pole. The bracket provides a connection point for the 2 lower arm power harnesses in the powered poles. It is UL listed and CSA certified. Package contains 6.

Notes
Power pass-through bracket can only be used with nonpowered poles with cutouts. It cannot be used with powered poles, nonpowered poles without cutouts, or power harnesses.
Use of the power pass-through bracket does not create a powered pole.

Dimensions

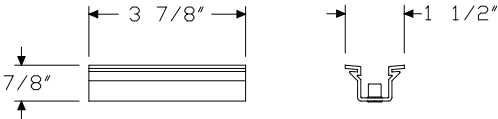

Specification Information

Step 1.
R1352. \$49

Power Jumper Conversion Kit,
Fixed Truss

R1345.

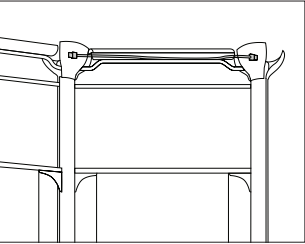

Product Information
Description
This kit converts a nonpowered fixed truss to a powered fixed truss. It distributes up to 6 20-amp circuits and is available in 5 lengths. The kit includes a flex-conduit harness with connectors on each end that plug into the top of the adjacent tall pole's power harness or power block. It is UL listed and CSA certified.
Notes
Specify length of conversion kit to match length of fixed truss.
Dimensions

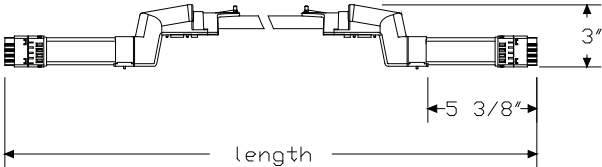

Specification Information
Step 1.
R1345.
Step 2. Length
048 48" long
060 60" long
096 96" long
108 108" long
120 120" long
Prices for Steps 1-2.
R1345. 048 \$215
060 \$243
096 \$299
108 \$318
120 \$352
Step 3. Harness End Finish
3G brownstone +\$0
8Q folkstone grey +\$0
CL cool grey neutral +\$0
LU soft white +\$0
WL sandstone +\$0
WN warm grey neutral +\$0

Power Jumper Conversion Kit,
Sliding Truss

R1346.

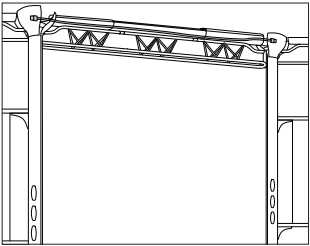

Resolve® Infrastructure

Product Information

Description
This kit converts a nonpowered sliding truss to a powered sliding truss. It distributes up to 6 20-amp circuits and is available in 3 lengths. The kit includes a flex-conduit harness with connectors on each end that plug into the top of the adjacent tall pole's power harness or power block. It is UL listed and CSA certified.

Notes
Specify length of conversion kit to match length of sliding truss.

Dimensions

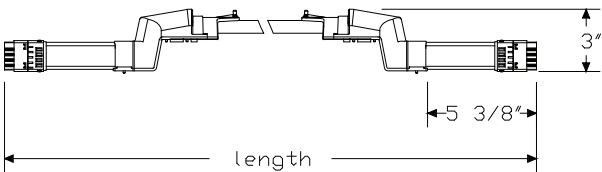

Specification Information

Step 1.
R1346.

Step 2. Length
0912 extends from 9' to 12'
1216 extends from 12' to 16'
1620 extends from 16' to 20'

Prices for Steps 1-2.	
R1346. 0912	\$478
1216	\$478
1620	\$478

Step 3. Harness End Finish		
3G	brownstone	+\$0
8Q	folkstone grey	+\$0
CL	cool grey neutral	+\$0
LU	soft white	+\$0
WL	sandstone	+\$0
WN	warm grey neutral	+\$0

Power Harness, Tall Pole

R1380.

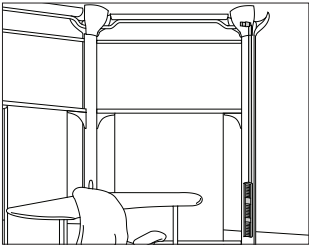

Product Information
Description
This harness converts a nonpowered tall pole with cutouts to a powered tall pole. It distributes up to 6 20-amp circuits and is UL listed and CSA certified.
Notes
Power harness is used with a nonpowered tall pole with cutouts (R1110.N) only.
Dimensions

Specification Information
Step 1.
R1380.
\$425

Resolve® Infrastructure

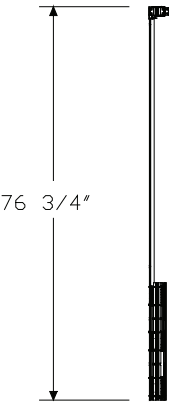

Power Harness, Short Pole

R1381.

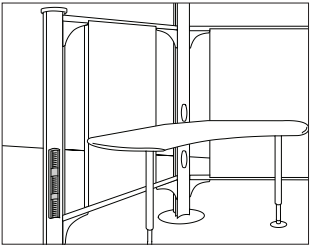

Resolve® Infrastructure

Product Information

Description
This harness converts a nonpowered short pole with cutouts to a powered short pole. It distributes up to 6 20-amp circuits and is UL listed and CSA certified.

Notes
Power harness is used with a nonpowered short pole with cutouts (R1120.N) only.

Dimensions

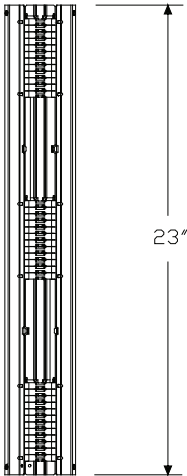

Specification Information

Step 1.
R1381. \$282

Power Block

R1382.

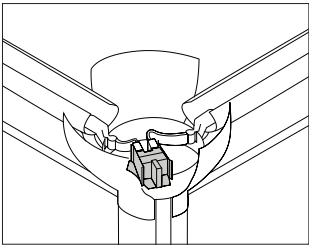

Product Information
<p>Description</p> <p>This power block fits into a nonpowered tall pole’s crown and passes power over the top of the pole. A crown with a power block accepts up to 4 connections. The power block distributes up to 6 20-amp circuits and is UL listed and CSA certified.</p>
<p>Notes</p> <p>Power block does not create a powered pole (receptacle locations in tall pole are not powered).</p> <p>Power block cannot be used with a powered pole or power harness.</p>
<p>Dimensions</p>

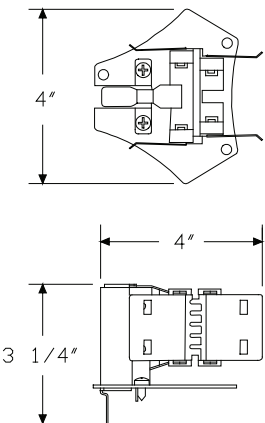

Specification Information	
Step 1.	
R1382.	\$196

Resolve® Infrastructure

Duplex Receptacle

R1311.

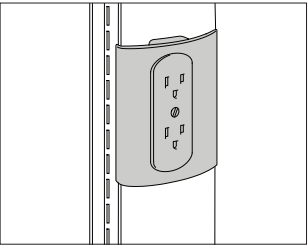

Product Information
Description
This duplex receptacle attaches to the power harness of a tall or short pole. It is UL listed and CSA certified. Attachment hardware is included. Package contains 6 duplex receptacles.
Notes
For information on receptacle types and wire usage, see Resolve Planning Guide.
Dimensions

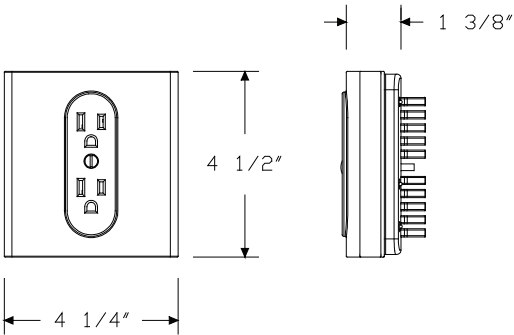

Specification Information
Step 1.
R1311.
Step 2. Circuit Type
A circuit a
B circuit b
C circuit c
CI circuit c, isolated ground
X circuit x
XI circuit x, isolated ground
YI circuit y, isolated ground
ZI circuit z, isolated ground
Prices for Steps 1-2.
R1311. A \$252
B \$252
C \$252
CI \$252
X \$252
XI \$252
YI \$252
ZI \$252
Step 3. Finish
3G brownstone +\$0
8Q folkstone grey +\$0
CL cool grey neutral +\$0
LU soft white +\$0
WL sandstone +\$0
WN warm grey neutral +\$0

Controlled Duplex Receptacle

R1311M

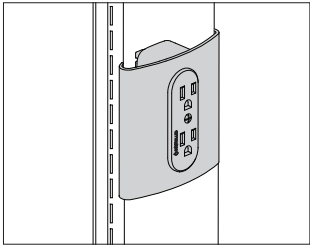

Product Information
Description This receptacle is to be used for ASHRAE90.1 and Title 24 compliance. A controlled receptacle should be used for any receptacles that are under automated control by the energy management system. This duplex receptacle attaches to the power harness of a tall or short pole. Package contains 6 duplex receptacles. Attachment hardware included. Receptacle is UL listed and CSA certified.
Notes
For information on receptacle types and wire usage, see Resolve® Planning Guide.
Dimensions

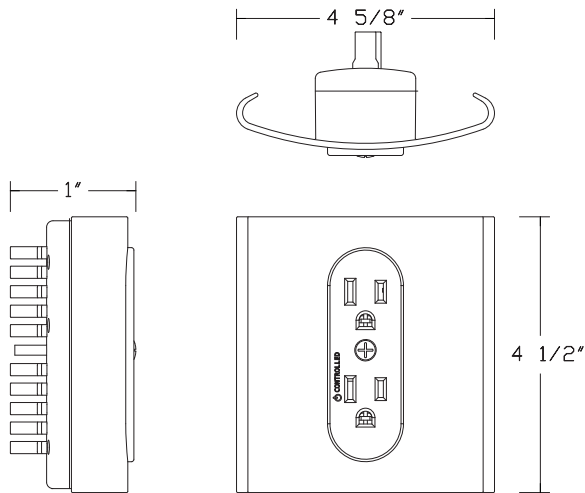

Specification Information
Step 1. R1311M. A
Step 2. Circuit Type
A circuit a A
B circuit b A
C circuit c A
CI circuit c, isolated ground A
X circuit x A
XI circuit x, isolated ground A
YI circuit y, isolated ground A
ZI circuit z, isolated ground A
Prices for Steps 1-2.
R1311M. A \$252
B \$252
C \$252
CI \$252
X \$252
XI \$252
YI \$252
ZI \$252
Step 3. Finish
3G brownstone +\$0
8Q folkstone grey +\$0
CL cool grey neutral +\$0
LU soft white +\$0
WL sandstone +\$0
WN warm grey neutral +\$0

Controlled Receptacle Decal

G9999.

(12 per sheet)

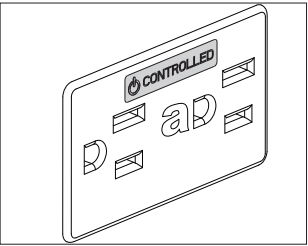

Product Information

Description

This decal is to be used for ASHRAE90.1 and Title 24 compliance. The decal is used to mark standard receptacles (new or existing) that are under automated control by the energy management system. 1 sheet includes 12 clear decals with white or black print.

Dimensions

Specification Information

Step 1.

G9999.

A

Step 2. Color

B

black print

A

W

white print

A

Prices for Steps 1-2.

G9999. B

W

\$8

\$8

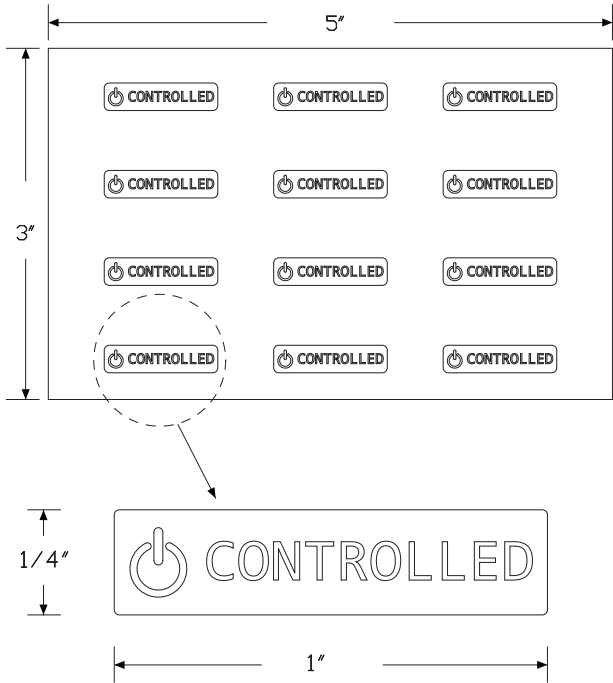

Simplex Receptacle

R1312.

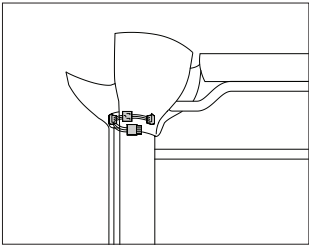

Product Information
Description
This harness has 3 simplex receptacles that access circuit A. It plugs into the top of the tall pole’s power harness or power block and fits into the crown. The receptacle harness is UL listed and CSA certified. Finish is black.
Dimensions

Specification Information
Step 1.
R1312.
\$88

Resolve® Infrastructure

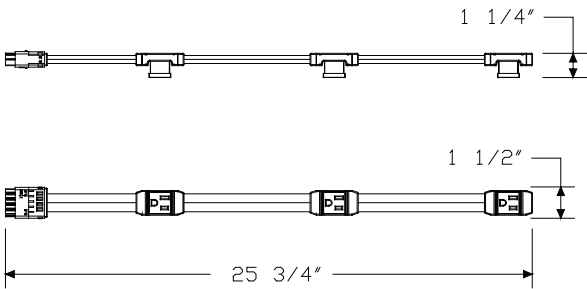

Data Faceplate HousingR1360.

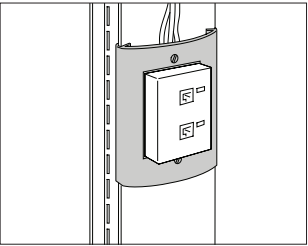

Resolve® Infrastructure

Product Information

Description

This housing snaps onto the face of a tall or short pole. It provides a frame to attach a NEMA single-gang telecommunications faceplate. Package contains 6.

Dimensions

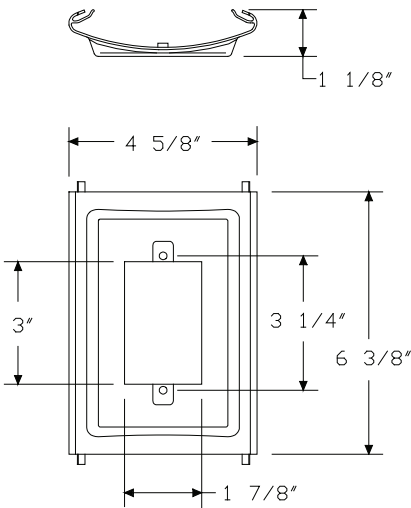

Specification Information

Step 1.

R1360.\$171

Step 2. Finish

3G	brownstone	+\$0
8Q	folkstone grey	+\$0
CL	cool grey neutral	+\$0
LU	soft white	+\$0
WL	sandstone	+\$0
WN	warm grey neutral	+\$0

Cable Cover

R1361.

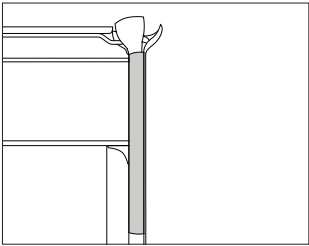

Product Information
Description
This 37"-high cover snaps onto a tall or short pole and covers data cables in the concave face of the pole. Package contains 3 covers.
Notes
Cover can be field cut to the appropriate length.
For cable capacity information, see Cable Capacity Charts in Omni.
Dimensions

Specification Information
Step 1.
R1361.37
\$174
Step 2. Finish
3G brownstone
8Q folkstone grey
CL cool grey neutral
LU soft white
WL sandstone
WN warm grey neutral

Resolve® Infrastructure

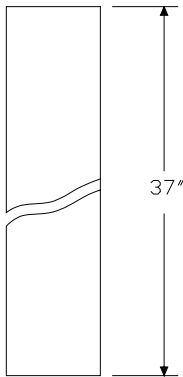
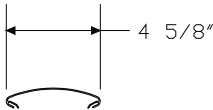

Cable Management Clip

R1362.

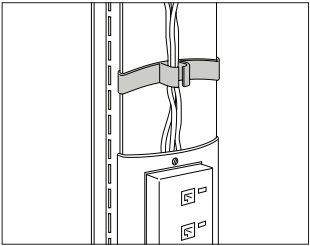

Resolve® Infrastructure

Product Information

Description
This clip snaps onto a tall or short pole and manages data cables in the concave face of the pole. Package contains 6 clips.
Notes
For cable capacity information, see Cable Capacity Charts in Omni.
Dimensions

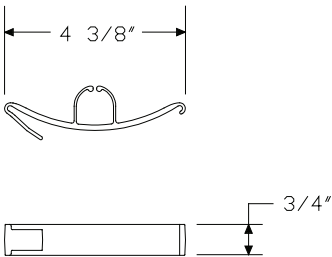

Specification Information

Step 1.		
R1362.		\$47
Step 2. Finish		
3G	brownstone	+\$0
8Q	folkstone grey	+\$0
CL	cool grey neutral	+\$0
LU	soft white	+\$0
WL	sandstone	+\$0
WN	warm grey neutral	+\$0

Cable Bag

R1365.

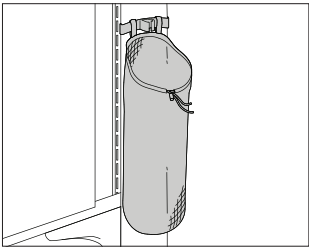

Product Information
Description
This mesh bag hangs from a tall or short pole and holds cords, cables, a multi-outlet strip, or other items. A cable management clip holds the bag in place against the pole; the bag can be adjusted vertically in 1" increments. The bag has a drawstring with a clear plastic cinch button that adjusts the size of the opening and secures cables entering the bag. A hook-and-loop-fastener opening in the back allows cords to enter or exit the back of the bag. Mesh color is grey. 1 cable management clip is included.
Dimensions

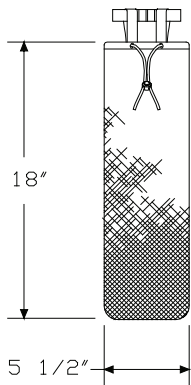

Specification Information		
Step 1.		
R1365.		\$81
Step 2. Clip Finish		
3G	brownstone	+\$0
8Q	folkstone grey	+\$0
CL	cool grey neutral	+\$0
LU	soft white	+\$0
WL	sandstone	+\$0
WN	warm grey neutral	+\$0

Resolve® Infrastructure

Communication Port Faceplate
Extender

G1189.

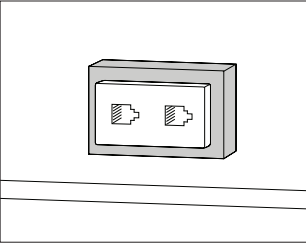

Product Information
Description
This faceplate fits over the communication port cutout of the following products: Action Office® Series 2 or Ethospace® cable management side cover; Action Office Series 2 cable management panel face; Ethospace cable access tile upper port; Resolve® data faceplate housing; or a Passage® voice/data outlet. It allows installation of specific cable communication modules without interfering with cable distribution capacity. Attachment hardware is included. Package contains 6.
Notes
Purchase preconfigured voice/data modules/faceplates separately from their manufacturers.
When specifying faceplate for Action Office Series 2 panel or Ethospace frame, order “J” or “G” power option with communication port locations.
When specifying faceplate for Action Office Series 2 cable management panel, order panel face side 1 (A1181.C) and side 2 (A1182.C) separately.
When specifying faceplate for Ethospace grooved face tile or frame with grooved side covers, order both reducer (G1189.A) and extender (G1189.B).
When specifying faceplate for Resolve data faceplate housing, order housing (R1360.) separately.
Dimensions

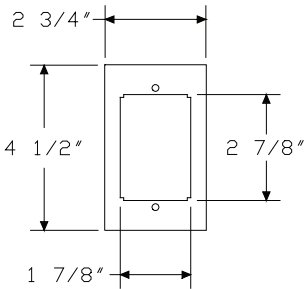

Specification Information		
Step 1.		
G1189.B		\$64
Step 2. Surface Finish		
8Q	folkstone grey	+\$0
91	white	+\$0
98	studio white A	+\$0
BU	black umber	+\$0
CL	cool grey neutral	+\$0
G1	graphite	+\$0
HF	inner tone light	+\$0
LU	soft white	+\$0
MT	medium tone	+\$0
SG	slate grey	+\$0
WL	sandstone	+\$0
WN	warm grey neutral	+\$0

Boundary Screen

R1410.

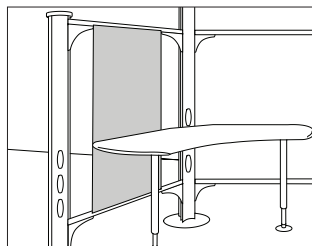

Product Information

Description

This fabric screen attaches to an upper and lower support arm using J-strips. It creates a boundary between workstations. The screen is available in combinations of 3 heights and 3 widths; the widths provide different degrees of enclosure. The upper and lower J-strip finish is clear. The screen is UL listed.

Notes

60"- and 69"-high screens cannot be used with 48"-high short pole.

Specify height of screen to match height of upper support arm.

Specify width of screen equal to or less than length of support arms.

For increased acoustical privacy, order acoustical insert (R1412.) separately.

Screen accepts Customer's Own Material (COM). Yardage is estimated for nondirectional, 60"-wide fabrics.

Height—Yardage

48"— $1\frac{1}{8}$

60"— $1\frac{1}{2}$

69"— $1\frac{7}{8}$

Textiles are cut parallel to the roll to match the appropriate screen height. Add 4 yards COM to total boundary screen order (required for lead-in material used in application process). For information on multiple quantities or directional fabrics, contact COM Department. See Order Information in Appendices.

Dimensions

48" Upper Support Arm Height

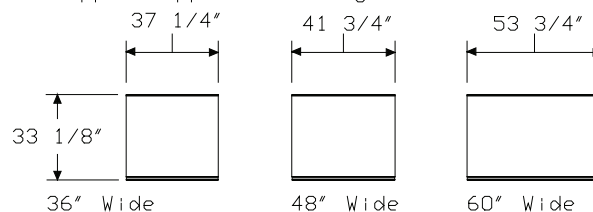

60" Upper Support Arm Height

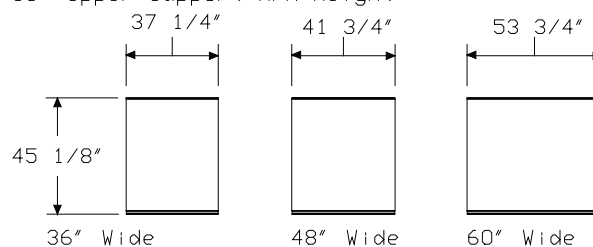

69" Upper Support Arm Height

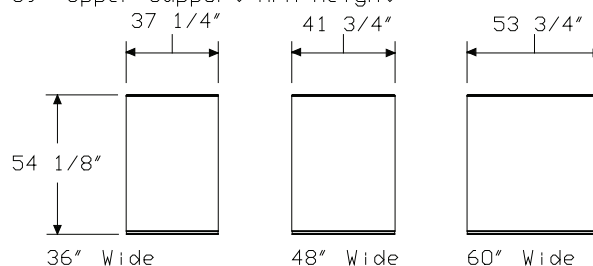

Specification Information

Step 1.

R1410.

Step 2. Upper Support Arm Height

- 48 48" upper support arm height
- 60 60" upper support arm height
- 69 69" upper support arm height

Step 3. Screen Width

- 36 36" wide
- 48 48" wide
- 60 60" wide

Prices for Steps 1-3.

	36	48	60
R1410. 48	\$106	140	174
60	\$140	183	227
69	\$177	227	282

Step 4. Fabric

See DOT® collection list for fabric numbers. First 2 digits of number indicate fabric line; remaining digits indicate image.

	48	60	69
Price Category 1	+\$0	0	0
Price Category 3	+\$25	31	37

Display Screen

R1420.

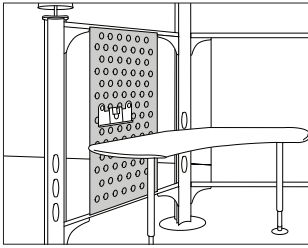

Product Information

Description

This screen attaches to an upper and lower support arm using J-strips. It has a bubbletack™ surface that is tackable and displays work and personal items. The screen also creates a boundary between workstations. It is available in combinations of 3 heights and 3 widths; the widths provide different degrees of enclosure. The upper and lower J-strip finish is clear. The screen is UL listed.

Notes

60"- and 69"-high screens cannot be used with 48"-high short pole.

Specify height of screen to match height of upper support arm.

Specify width of screen equal to or less than length of support arms.

For increased acoustical privacy, order acoustical insert (R1412.) separately.

Order accessories separately:

- Document holder (R7412.)
- Ledge (R7411.)
- Mirror (R7413.)
- Picture holder (R7410.)
- Utility hook (R7414.)

Dimensions

48" Upper Support Arm Height

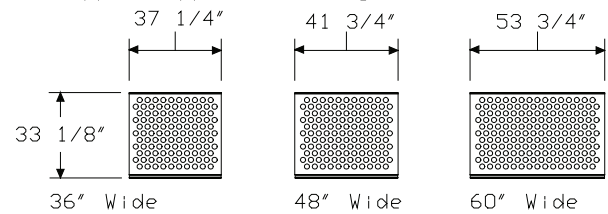

60" Upper Support Arm Height

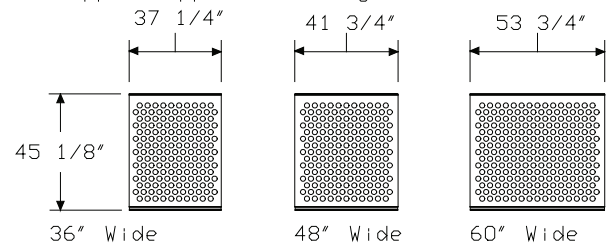

69" Upper Support Arm Height

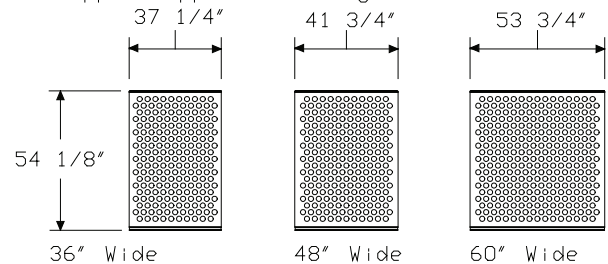

Specification Information

Step 1.

R1420.

Step 2. Upper Support Arm Height

- 48** 48" upper support arm height
- 60** 60" upper support arm height
- 69** 69" upper support arm height

Step 3. Screen Width

- 36** 36" wide
- 48** 48" wide
- 60** 60" wide

Prices for Steps 1-3.

	36	48	60
R1420. 48	\$297	387	483
60	\$387	515	642
69	\$490	642	802

Step 4. Fabric

*See application chart and textiles list for fabric usage and numbers.
First 2 digits of number indicate fabric line; remaining digit(s) indicate fabric color.*

Price Category 1 + \$0

Acoustical Insert

R1412.

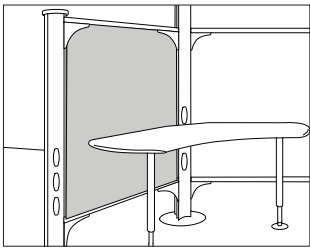

Product Information

Description

This sound-reducing insert is placed between 2 boundary or display screens mounted on a 4' or 5' support arm. It has a clear, sound-blocking Sound Transmission Class (STC) barrier that is positioned between 2 sound-absorbing Noise Reduction Coefficient (NRC) layers. The 3-piece insert is semi-translucent to light and attaches to the upper and lower support arms. The STC rating is 21; the NRC rating is .40. The insert is UL listed.

Notes

Specify height of insert to match height of support arms.

Specify width of insert to match width of corresponding boundary or display screen.

Acoustical insert is not available in 36" width.

For boundary or display screens shipped before June 6, 2005, please contact Herman Miller Options for appropriate insert widths. Call (800) 654 3910 for more information.

Dimensions

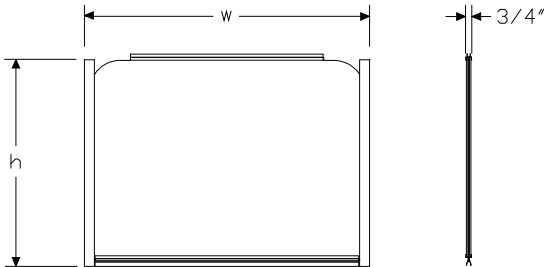

Specification Information

Step 1.

R1412.

Step 2. Upper Support Arm Height

48	48" upper support arm height
60	60" upper support arm height
69	69" upper support arm height

Step 3. Width

48	48" wide
60	60" wide

Prices for Steps 1-3.

	48	60
R1412. 48	\$340	418
60	\$450	548
69	\$548	691

Resolve® Infrastructure

Marker Screen

R1450.

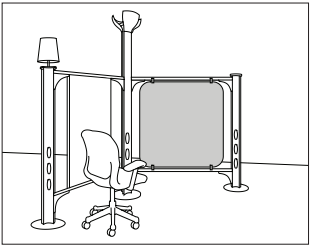

Resolve® Infrastructure

Product Information

Description
This 48"-wide, double-sided screen attaches to an upper and lower support arm. It is available in 2 heights and has a white erasable writing surface. The screen includes 1 holder for markers and erasers; the holder attaches to the pole. Attachment hardware is included.

Notes
Marker screen cannot be used with 48"-high short pole.
Specify height of screen to match height of upper support arm.

Dimensions

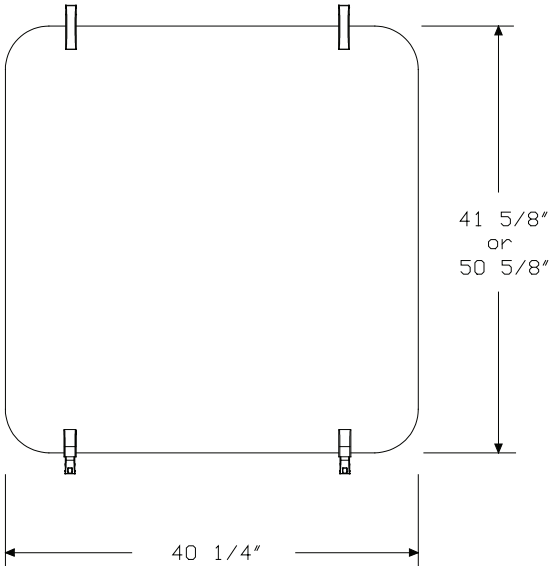

Specification Information

Step 1.		
R1450.		
Step 2. Upper Support Arm Height		
6048	60" upper support arm height	
6948	69" upper support arm height	
Prices for Steps 1-2.		
R1450. 6048		\$973
6948		\$1053
Step 3. Bracket Finish		
8Q	folkstone grey	+\$0
LU	soft white	+\$0
CN	metallic champagne	+\$0
EH	metallic bronze	+\$0
MS	metallic silver	+\$0
Step 4. Holder Finish		
3G	brownstone	+\$0
8Q	folkstone grey	+\$0
CL	cool grey neutral	+\$0
LU	soft white	+\$0
WL	sandstone	+\$0
WN	warm grey neutral	+\$0

Rolling Screen

R1441.

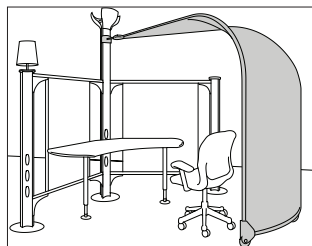

Product Information

Description

This screen attaches to a tall pole on one end, arcs over a workspace, and extends to the floor on the other end. It rolls left and right to allow easy positioning for individual privacy requirements. The fabric screen has a steel tube frame and color-matched wheels. It is available in 2 sizes and as a frame only or as a frame with standard fabrics.

Attachment hardware is included. Shipped knocked down.

The support arm length reference (48" or 60") gives the specifier an idea of the arc created when the rolling screen is used with either 48"- or 60"-long support arms.

Notes

For accurate planning information, see dimensional drawing and Resolve Planning Guide.

Fabric is shipped separately from frame; fabric must be field installed on frame.

When replacement fabric is needed, order replacement fabric for rolling screen (R1444.) separately.

Dimensions

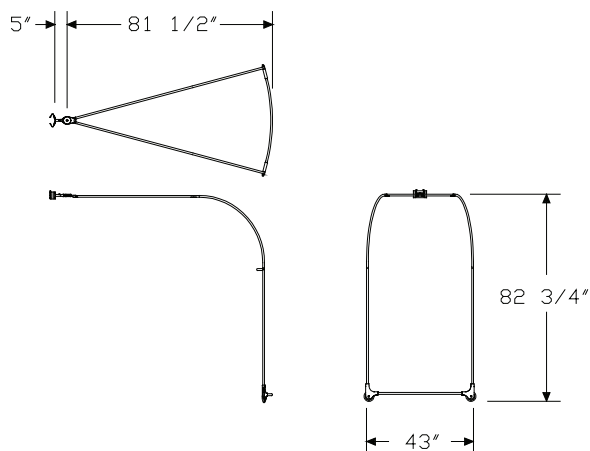

48" Support Arm Length Reference

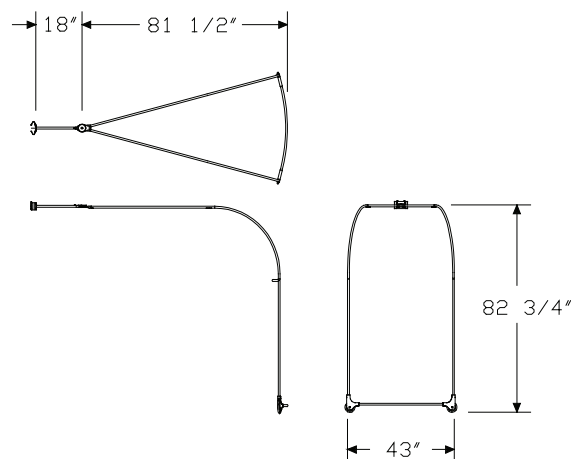

60" Support Arm Length Reference

Specification Information

Step 1.

R1441.

Step 2. Support Arm Length Reference

48 48" support arm length reference**60** 60" support arm length reference

Step 3. Assembly

N frame only**F** frame and screen fabric

Prices for Steps 1-3.

	N	F
R1441. 48	\$462	744
60	\$462	744

Step 4. Bracket Finish

8Q folkstone grey +\$0**LU** soft white +\$0**CN** metallic champagne +\$0**EH** metallic bronze +\$0**MS** metallic silver +\$0

Step 5. Trim Finish

3G brownstone +\$0**8Q** folkstone grey +\$0**CL** cool grey neutral +\$0**LU** soft white +\$0**WL** sandstone +\$0**WN** warm grey neutral +\$0

Step 6. Screen Fabric

*For frame and screen fabric (F)**See application chart and textiles list for fabric usage and numbers.**First 2 digits of number indicate fabric line; remaining digit(s) indicate fabric color.*

Price Category 1 +\$0

Step 7. Edge Band Fabric

*For frame and screen fabric (F)**See application chart and textiles list for fabric usage and numbers.**First 2 digits of number indicate fabric line; remaining digit(s) indicate fabric color.*

Price Category 1 +\$0

Nesting Rolling Screen

R1442.

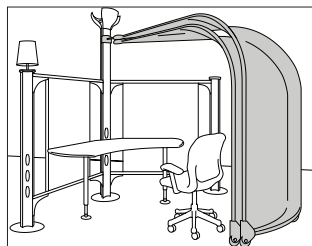

Product Information

Description

These 2 screens attach to a tall pole on one end, arc over a workspace, and extend to the floor on the other end. They nest together or roll apart and move left and right to allow easy positioning for individual privacy requirements. Each fabric screen has a steel tube frame and color-matched wheels. They are available in 2 sizes and as a frame only or as a frame with standard fabrics. Attachment hardware is included.

Shipped knocked down.

The support arm length reference (48" or 60") gives the specifier an idea of the arc created when the rolling screen is used with either 48"- or 60"-long support arms.

Notes

For accurate planning information, see dimensional drawing and Resolve Planning Guide.

Fabric is shipped separately from frame; fabric must be field installed on frame.

When replacement fabric is needed, order replacement fabric for rolling screen (R1444.) separately.

Dimensions

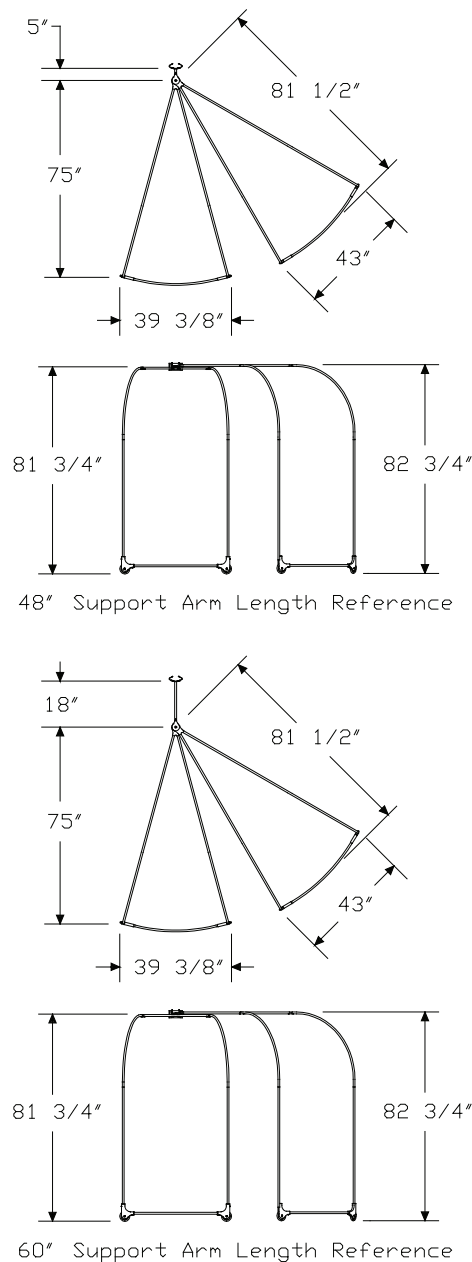

Specification Information			
Step 1.			
R1442.			
Step 2. Support Arm Length Reference			
48	48" support arm length reference		
60	60" support arm length reference		
Step 3. Assembly			
N	frame only		
F	frame and screen fabric		
Prices for Steps 1-3.			
		N	F
R1442. 48		\$923	1455
60		\$923	1455
Step 4. Bracket Finish			
8Q	folkstone grey		+\$0
LU	soft white		+\$0
CN	metallic champagne		+\$0
EH	metallic bronze		+\$0
MS	metallic silver		+\$0
Step 5. Trim Finish			
3G	brownstone		+\$0
8Q	folkstone grey		+\$0
CL	cool grey neutral		+\$0
LU	soft white		+\$0
WL	sandstone		+\$0
WN	warm grey neutral		+\$0
Step 6. Screen Fabric			
For frame and screen fabric (F)			
See application chart and textiles list for fabric usage and numbers.			
First 2 digits of number indicate fabric line; remaining digit(s) indicate fabric color.			
Price Category 1			+\$0
Step 7. Edge Band Fabric			
For frame and screen fabric (F)			
See application chart and textiles list for fabric usage and numbers.			
First 2 digits of number indicate fabric line; remaining digit(s) indicate fabric color.			
Price Category 1			+\$0

Replacement Fabric for Rolling Screen

R1444.

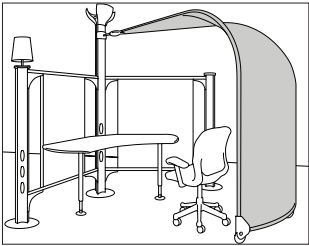

Product Information
Description
This screen fabric attaches to a rolling screen frame or a nesting rolling screen frame and replaces the existing fabric.
Notes
Order rolling screen frame (R1441.N) or nesting rolling screen frame (R1442.N) separately.

Specification Information
Step 1.
R1444.
Step 2. Screen Usage
A fabric for rolling screen or outside nesting rolling screen
B fabric for inside nesting rolling screen
Prices for Steps 1-2.
R1444. A \$347
B \$347
Step 3. Screen Fabric
See application chart and textiles list for fabric usage and numbers.
First 2 digits of number indicate fabric line; remaining digit(s) indicate fabric color.
Price Category 1 +\$0
Step 4. Edge Band Fabric
See application chart and textiles list for fabric usage and numbers.
First 2 digits of number indicate fabric line; remaining digit(s) indicate fabric color.
Price Category 1 +\$0

Canopy

R1430.

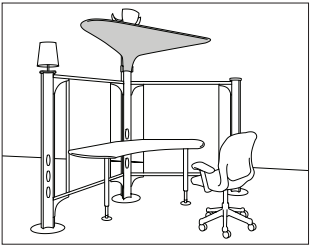

Resolve® Infrastructure

Product Information

Description
This canopy attaches to a tall pole and creates an overhead boundary. It is available as a frame only or as a frame with standard fabrics. Attachment hardware is included. Shipped knocked down.

Notes
Fabric is shipped separately from frame; fabric must be field installed on frame.
When replacement fabric is needed, order replacement fabric for canopy (R1432.) separately.

Dimensions

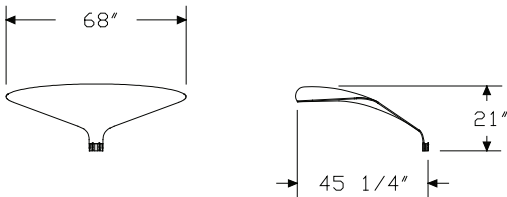

Specification Information

Step 1.		
R1430.		
Step 2. Assembly		
N	frame only	
F	frame and canopy fabric	
Prices for Steps 1-2.		
R1430. N		\$301
F		\$406
Step 3. Bracket Finish		
8Q	folkstone grey	+\$0
LU	soft white	+\$0
CN	metallic champagne	+\$0
EH	metallic bronze	+\$0
MS	metallic silver	+\$0
Step 4. Trim Finish		
3G	brownstone	+\$0
8Q	folkstone grey	+\$0
CL	cool grey neutral	+\$0
LU	soft white	+\$0
WL	sandstone	+\$0
WN	warm grey neutral	+\$0
Step 5. Canopy Fabric		
For frame and canopy fabric (F)		
See application chart and textiles list for fabric usage and numbers.		
First 2 digits of number indicate fabric line; remaining digit(s) indicate fabric color.		
Price Category 1		+\$0
Step 6. Edge Band Fabric		
For frame and canopy fabric (F)		
See application chart and textiles list for fabric usage and numbers.		
First 2 digits of number indicate fabric line; remaining digit(s) indicate fabric color.		
Price Category 1		+\$0

Replacement Fabric for Canopy

R1432.

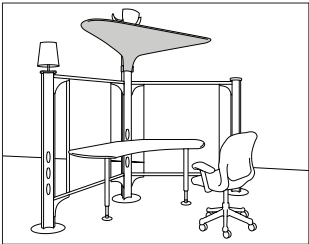

Product Information
Description
This canopy fabric attaches to a canopy frame and replaces the existing fabric.
Notes
Order canopy frame (R1430.N) separately.

Specification Information
Step 1.
R1432.
\$177
Step 2. Canopy Fabric
See application chart and textiles list for fabric usage and numbers.
First 2 digits of number indicate fabric line; remaining digit(s) indicate fabric color.
Price Category 1
+\$0
Step 3. Edge Band Fabric
See application chart and textiles list for fabric usage and numbers.
First 2 digits of number indicate fabric line; remaining digit(s) indicate fabric color.
Price Category 1
+\$0

Resolve® Infrastructure

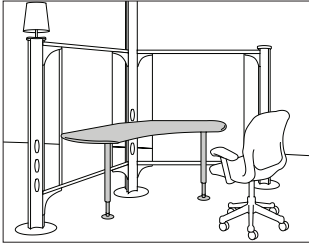

Product Information

Description

This 120° curved work surface attaches to a tall or short pole in the rear corner and has 2 pin-adjustable legs with 1" adjustable glides on the front (user) side. It can be installed from 22" to 32" in height. The work surface has a laminate, formcoat®, or veneer finish. The 3/4"-thick laminate surface has a square thermoplastic edge that matches the top color; the 1"-thick formcoat surface has a soft-curved front with an eased front edge; the veneer surface has a 7/8"-thick, 15-ply Baltic birch core and edge. It is predrilled for a pencil drawer: the 48"-wide work surface is predrilled in the center position; the 60"-wide work surface is predrilled in the left, right, and center positions. The center of the work surface's back edge is predrilled for a cable manager. Attachment hardware is included.

The formcoat finish is available as opaque or fleck. The opaque finish is nontransparent and has a solid-color appearance; the fleck finish is a nontransparent solid color with tiny flecks.

Notes

For additional support at left or right end of surface, order work surface bracket (R2190.) separately. Boomerang surface width must match adjacent support arm length (4' boomerang surface on 4' support arm; 5' boomerang surface on 5' support arm).

Order optional cable management products separately:

- Cable manager (R1364.)
- Cord holder (R1366.)

For accessory product applications, the following Compatibility Charts are available electronically for viewing and printing in Kiosk and HermanMiller.com: Keyboard Compatibility Charts, Pencil Drawer Compatibility Charts, and Work Organizer Compatibility Chart.

Dimensions

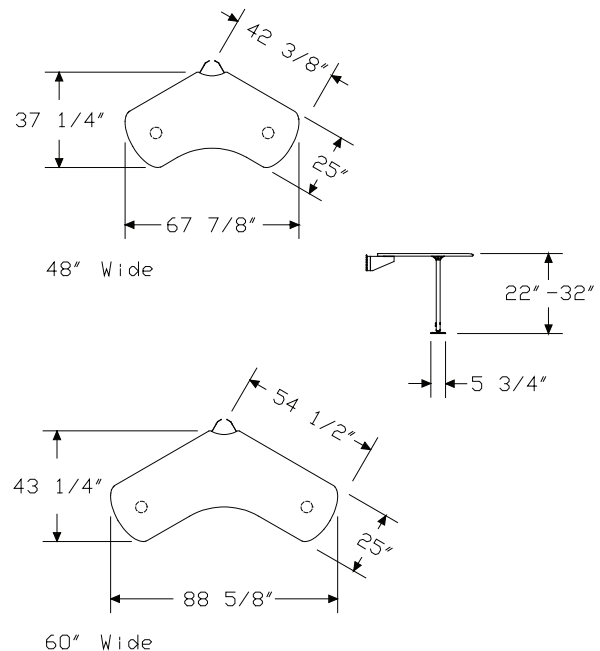

Boomerang™ Work Surface *continued*

Specification Information

Step 1.

R2100.

Step 2. Width

48 48" wide

60 60" wide

Step 3. Surface Material

L laminate

E formcoat®

W veneer A

Prices for Steps 1-3.

	L	E	W
R2100. 48	\$815	847	1373
60	\$981	1019	1646

Step 4. Top Finish

Solid-Color Laminate

For laminate (L)

8Q	folkstone grey	+\$0
91	white	+\$0
CL	cool grey neutral	+\$0
LU	soft white	+\$0
WL	sandstone	+\$0
WN	warm grey neutral	+\$0
X1	chalk white	+\$0

Opaque Formcoat®

For formcoat® (E)

8Q	folkstone grey	+\$0
91	white	+\$0
CL	cool grey neutral	+\$0
LU	soft white	+\$0
WL	sandstone	+\$0
WN	warm grey neutral	+\$0
X1	chalk white	+\$0

Wood Veneer

For veneer (W)

		48	60
2U	light brown walnut A	+\$110	140
40	dark brown walnut A	+\$110	140
ED	aged cherry A	+\$110	140
EK	medium red walnut A	+\$110	140
UL	natural maple A	+\$110	140
UX	walnut on cherry A	+\$110	140

Step 5. Bracket/Leg Finish

8Q	folkstone grey	+\$0
LU	soft white	+\$0
CN	metallic champagne	+\$0
EH	metallic bronze	+\$0
MS	metallic silver	+\$0

Step 6. Glide Finish

3G	brownstone	+\$0
8Q	folkstone grey	+\$0
CL	cool grey neutral	+\$0
LU	soft white	+\$0
WL	sandstone	+\$0
WN	warm grey neutral	+\$0

Resolve® Work Surfaces

Extended Boomerang™ Work Surface

R2104.
R2105.

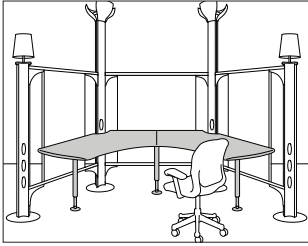

Product Information

Description

This 120° curved work surface attaches to 2 tall or short poles. It has 3 pin-adjustable legs with 1" height-adjustable glides. The work surface can be installed from 22" to 32" in height. It has 3 sides and a laminate, formcoat®, or veneer finish. The 3/4"-thick laminate surface has a square thermoplastic edge that matches the top color; the 1"-thick formcoat surface has a soft-curved front with an eased front edge; the veneer surface has a 7/8"-thick, 15-ply Baltic birch core and edge. It is predrilled for a pencil drawer: the 48"-wide work surface is predrilled in the center position; the 60"-wide work surface is predrilled on the left and right sides. The center of the work surface's back edge is predrilled for a cable manager. Attachment hardware is included. Shipped knocked down.

The formcoat finish is available as opaque or fleck. The opaque finish is nontransparent and has a solid-color appearance; the fleck finish is a nontransparent solid color with tiny flecks.

Notes

48"-wide left × 48"-wide right work surface with 48" center width (R2104.4848) has 2 pin-adjustable legs.

For additional support at left or right end of surface, order work surface bracket (R2190.) separately. Boomerang surface width must match adjacent support arm length (4' boomerang surface on 4' support arm; 5' boomerang surface on 5' support arm).

Order optional cable management products separately:

- Cable manager (R1364.)
- Cord holder (R1366.)

For accessory product applications, the following Compatibility Charts are available electronically for viewing and printing in Kiosk and HermanMiller.com: Keyboard Compatibility Charts, Pencil Drawer Compatibility Charts, and Work Organizer Compatibility Chart.

Dimensions

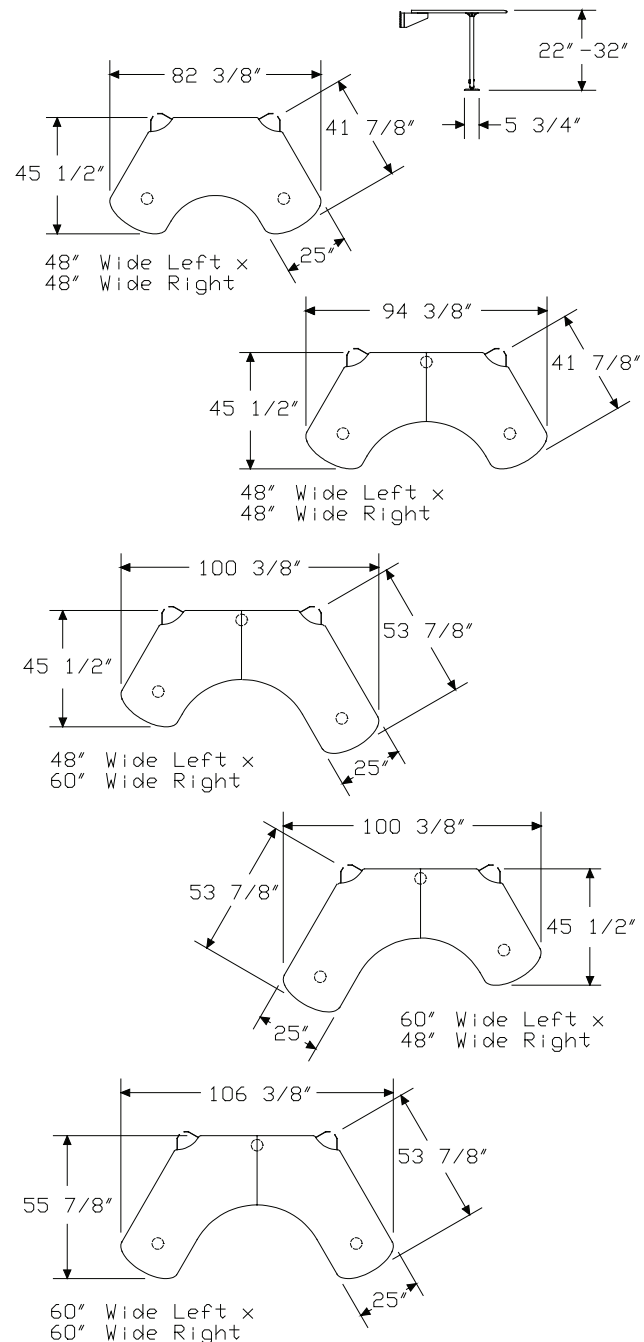

Extended Boomerang™ Work Surface *continued*

Specification Information

Step 1.

R210

Step 2. Center Width

4. 48" center width

5. 60" center width

Step 3. Extension Widths

For 48" center width (4.)

4848 48" wide left x 48" wide right

For 60" center width (5.)

4848 48" wide left x 48" wide right

4860 48" wide left x 60" wide right

6048 60" wide left x 48" wide right

6060 60" wide left x 60" wide right

Step 4. Surface Material

L laminate

E formcoat®

W veneer A

Prices for Steps 1-4.

	L	E	W
R2104. 4848	\$1399	1442	2244
R2105. 4848	\$1538	1552	2489
4860	\$1620	1660	2584
6048	\$1612	1660	2662
6060	\$1678	1728	2757

Step 5. Top Finish

Solid-Color Laminate

For laminate (L)

8Q	folkstone grey	+\$0
91	white	+\$0
CL	cool grey neutral	+\$0
LU	soft white	+\$0
WL	sandstone	+\$0
WN	warm grey neutral	+\$0
X1	chalk white	+\$0

Opaque Formcoat®

For formcoat® (E)

8Q	folkstone grey	+\$0
91	white	+\$0
CL	cool grey neutral	+\$0
LU	soft white	+\$0
WL	sandstone	+\$0
WN	warm grey neutral	+\$0
X1	chalk white	+\$0

Wood Veneer

For veneer (W)

		4. 5.4848	5.4860	5.6048	5.6060
2U	light brown	+\$200	220	230	240
	walnut A				
40	dark brown	+\$200	220	230	240
	walnut A				
ED	aged cherry A	+\$200	220	230	240
EK	medium red	+\$200	220	230	240
	walnut A				
UL	natural maple A	+\$200	220	230	240
UX	walnut on cherry A	+\$200	220	230	240

Step 6. Bracket/Leg Finish

8Q	folkstone grey	+\$0
LU	soft white	+\$0
CN	metallic champagne	+\$0
EH	metallic bronze	+\$0
MS	metallic silver	+\$0

Step 7. Glide Finish

3G	brownstone	+\$0
8Q	folkstone grey	+\$0
CL	cool grey neutral	+\$0
LU	soft white	+\$0
WL	sandstone	+\$0
WN	warm grey neutral	+\$0

Work Surface Bracket

R2190.

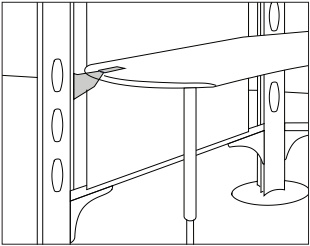

Product Information

Description
This bracket mounts to the underside of a boomerang™ work surface and an outbound tall, short, or in-line pole. Attachment hardware is included.

Notes
Use bracket with boomerang work surface (R2100.) or extended boomerang work surface (R2104. or R2105.).
Specify left or right orientation with user facing the boomerang surface.
Boomerang surface width must match adjacent support arm length (4' boomerang surface on 4' support arm; 5' boomerang surface on 5' support arm).

Dimensions

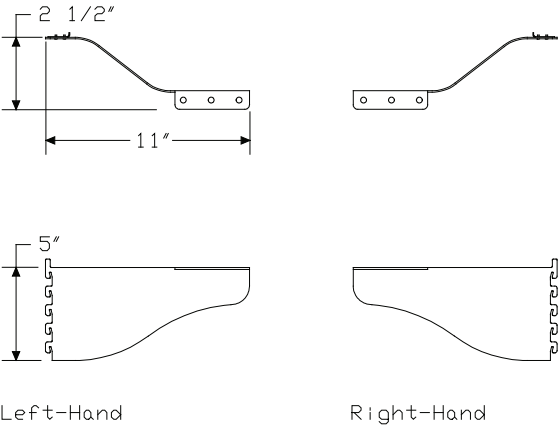

Specification Information

Step 1.		
R2190.		
Step 2. Position		
L	left-hand support	
R	right-hand support	
Prices for Steps 1-2.		
R2190. L		\$31
R		\$31
Step 3. Finish		
8Q	folkstone grey	+\$0
LU	soft white	+\$0
CN	metallic champagne	+\$0
EH	metallic bronze	+\$0
MS	metallic silver	+\$0

Freestanding Boomerang™ Work Surface R2650.

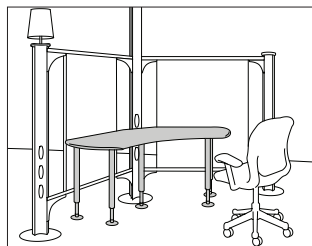

Product Information

Description

This freestanding 120° curved work surface has 5 pin-adjustable legs with adjustable glides. It can be installed from 22" to 32" in height. The work surface has a laminate, formcoat®, or veneer finish. The 3/4"-thick laminate surface has a square thermoplastic edge that matches the top color; the 1"-thick formcoat surface has a soft-curved front with an eased front edge; the veneer surface has a 7/8"-thick, 15-ply Baltic birch core and edge. It is predrilled for a pencil drawer: the 48"-wide work surface is predrilled in the center position; the 60"-wide work surface is predrilled in the left, right, and center positions. The center of the work surface's back edge is predrilled for a cable manager.

The formcoat finish is available as opaque or fleck. The opaque finish is nontransparent and has a solid-color appearance; the fleck finish is a nontransparent solid color with tiny flecks.

Notes

Order optional cable management products separately:

- Cable manager (R1364.)
- Cord holder (R1366.)

For accessory product applications, the following Compatibility Charts are available electronically for viewing and printing in Kiosk and HermanMiller.com: Keyboard Compatibility Charts, Pencil Drawer Compatibility Charts, and Work Organizer Compatibility Chart.

Dimensions

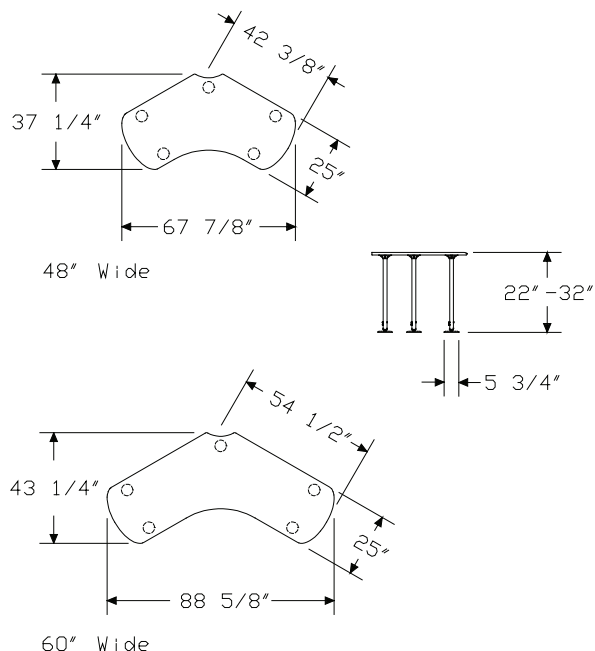

Freestanding Boomerang™ Work Surface *continued*

Specification Information				
Step 1.				
R2650.				
Step 2. Width				
48	48" wide			
60	60" wide			
Step 3. Surface Material				
L	laminate			
E	formcoat®			
W	veneer A			
Prices for Steps 1-3.				
		L	E	W
R2650. 48		\$972	1011	1349
60		\$1135	1177	1669
Step 4. Top Finish				
Solid-Color Laminate				
For laminate (L)				
8Q	folkstone grey			+\$0
91	white			+\$0
CL	cool grey neutral			+\$0
LU	soft white			+\$0
WL	sandstone			+\$0
WN	warm grey neutral			+\$0
X1	chalk white			+\$0
Opaque Formcoat®				
For formcoat® (E)				
8Q	folkstone grey			+\$0
91	white			+\$0
CL	cool grey neutral			+\$0
LU	soft white			+\$0
WL	sandstone			+\$0
WN	warm grey neutral			+\$0
X1	chalk white			+\$0

Wood Veneer				
<i>For veneer (W)</i>				
			48	60
2U	light brown walnut	+\$140		160
40	dark brown walnut	+\$140		160
ED	aged cherry A	+\$140		160
EK	medium red walnut	+\$140		160
UL	natural maple A	+\$140		160
UX	walnut on cherry	+\$140		160
Step 5. Leg Finish				
8Q	folkstone grey			+\$0
LU	soft white			+\$0
CN	metallic champagne			+\$0
EH	metallic bronze			+\$10
MS	metallic silver			+\$0
Step 6. Glide Finish				
3G	brownstone			+\$0
8Q	folkstone grey			+\$0
CL	cool grey neutral			+\$0
LU	soft white			+\$0
WL	sandstone			+\$0
WN	warm grey neutral			+\$0

Freestanding Extended Boomerang™ Work Surface

R2654.
R2655.

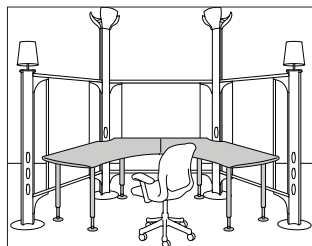

Product Information

Description

This freestanding, 120° curved work surface has 6 pin-adjustable legs with 1" height-adjustable glides. It can be installed from 22" to 32" in height. The work surface has 3 sides and a laminate, formcoat®, or veneer finish. The 3/4"-thick laminate surface has a square thermoplastic edge that matches the top color; the 1"-thick formcoat surface has a soft-curved front with an eased front edge; the veneer surface has a 7/8"-thick, 15-ply Baltic birch core and edge. It is predrilled for a pencil drawer: the 48"-wide work surface is predrilled in the center position; the 60"-wide work surface is predrilled on the left and right sides. The center of the work surface's back edge is predrilled for a cable manager. Shipped knocked down.

The formcoat finish is available as opaque or fleck. The opaque finish is nontransparent and has a solid-color appearance; the fleck finish is a nontransparent solid color with tiny flecks.

Notes

Order optional cable management products separately:

- Cable manager (R1364.)
- Cord holder (R1366.)

For accessory product applications, the following Compatibility Charts are available electronically for viewing and printing in Kiosk and HermanMiller.com: Keyboard Compatibility Charts, Pencil Drawer Compatibility Charts, and Work Organizer Compatibility Chart.

Dimensions

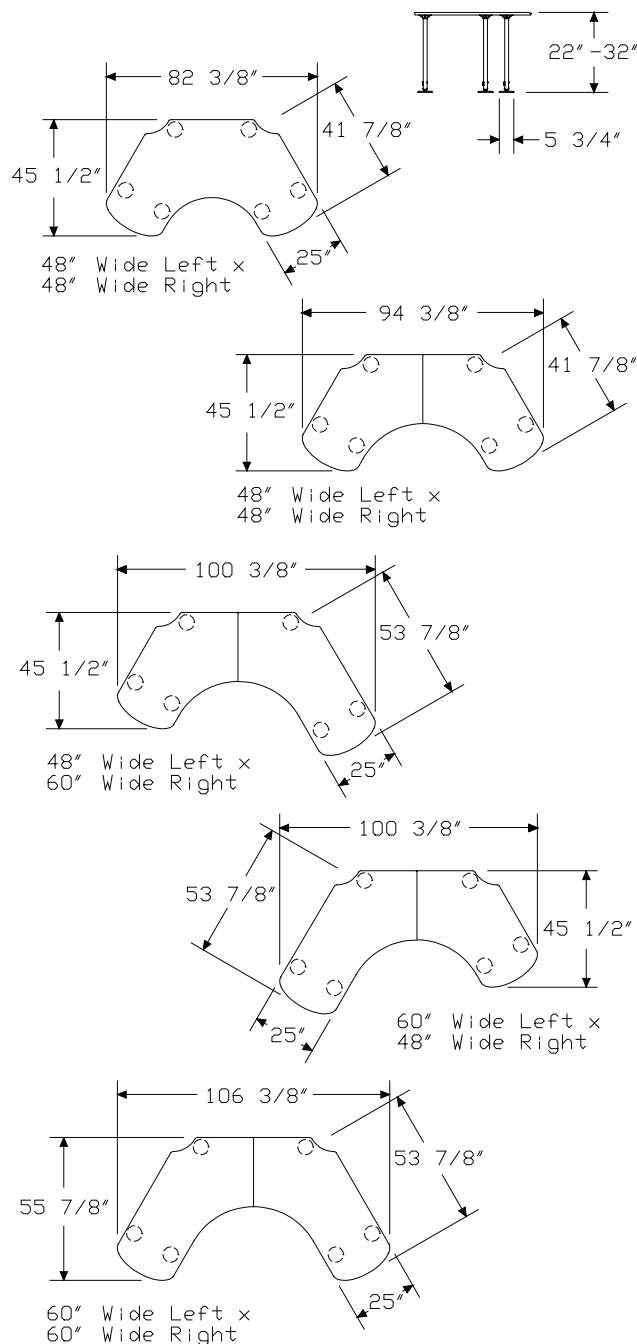

Resolve® Work Surfaces

Freestanding Extended Boomerang™ Work Surface *continued*

Specification Information				
Step 1.				
R265				
Step 2. Center Width				
4.	48" center width			
5.	60" center width			
Step 3. Extension Widths				
For 48" center width (4.)				
4848	48" wide left x 48" wide right			
For 60" center width (5.)				
4848	48" wide left x 48" wide right			
4860	48" wide left x 60" wide right			
6048	60" wide left x 48" wide right			
6060	60" wide left x 60" wide right			
Step 4. Surface Material				
L	laminate			
E	formcoat®			
W	veneer A			
Prices for Steps 1-4.				
		L	E	W
R2654. 4848		\$1561	1623	2273
R2655. 4848		\$1693	1708	2502
4860		\$1749	1837	2592
6048		\$1767	1783	2592
6060		\$1814	1904	2682
Step 5. Top Finish				
Solid-Color Laminate				
For laminate (L)				
8Q	folkstone grey			+\$0
91	white			+\$0
CL	cool grey neutral			+\$0
LU	soft white			+\$0
WL	sandstone			+\$0
WN	warm grey neutral			+\$0
X1	chalk white			+\$0

Opaque Formcoat®				
<i>For formcoat® (E)</i>				
8Q	folkstone grey			+\$0
91	white			+\$0
CL	cool grey neutral			+\$0
LU	soft white			+\$0
WL	sandstone			+\$0
WN	warm grey neutral			+\$0
X1	chalk white			+\$0

Wood Veneer				
<i>For veneer (W)</i>				
		4. 5.4848	5.4860	5.6048 5.6060
2U	light brown walnut	+\$200	220	230 230 240
40	dark brown walnut	+\$200	220	230 230 240
ED	aged cherry A	+\$200	220	230 230 240
EK	medium red walnut	+\$200	220	230 230 240
UL	natural maple A	+\$200	220	230 230 240
UX	walnut on cherry	+\$200	220	230 230 240

Step 6. Leg Finish				
8Q	folkstone grey			+\$0
LU	soft white			+\$0
CN	metallic champagne			+\$0
EH	metallic bronze			+\$10
MS	metallic silver			+\$0

Step 7. Glide Finish				
3G	brownstone			+\$0
8Q	folkstone grey			+\$0
CL	cool grey neutral			+\$0
LU	soft white			+\$0
WL	sandstone			+\$0
WN	warm grey neutral			+\$0

Input Table

R2600.

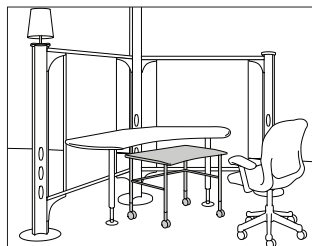

Product Information

Description

This mobile table holds a keyboard, mouse, or other work items. It has 2 locking casters in the front (user side) and 2 nonlocking casters in the rear. The seated-height table has pin-adjustable legs that adjust from 22" to 32" high. The table holds up to 25 pounds and has a laminate, formcoat®, or veneer finish. The laminate surface has a square thermoplastic edge that matches the top color; the formcoat surface has an eased front edge; the veneer surface has a 7/8"-thick, 15-ply Baltic birch core and edge. Casters are black.

The formcoat finish is available as opaque or fleck. The opaque finish is nontransparent and has a solid-color appearance; the fleck finish is a nontransparent solid color with tiny flecks.

Notes

Order optional swivel tray set (R3620.) separately.

Dimensions

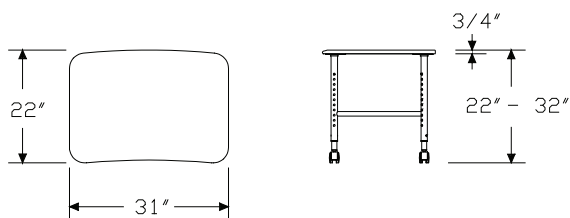

Specification Information

Step 1.

R2600.

Step 2. Height

A seated height

Step 3. Surface Material

L laminate

E formcoat®

W veneer ☐

Prices for Steps 1-3.

	L	E	W
R2600. A	\$632	645	971

Step 4. Top Finish

Solid-Color Laminate

For laminate (L)

8Q	folkstone grey	+\$0
91	white	+\$0
CL	cool grey neutral	+\$0
LU	soft white	+\$0
WL	sandstone	+\$0
WN	warm grey neutral	+\$0
X1	chalk white	+\$0

Opaque Formcoat®

For formcoat® (E)

8Q	folkstone grey	+\$0
91	white	+\$0
CL	cool grey neutral	+\$0
LU	soft white	+\$0
WL	sandstone	+\$0
WN	warm grey neutral	+\$0
X1	chalk white	+\$0

Wood Veneer

For veneer (W)

2U	light brown walnut <input type="checkbox"/>	+\$85
40	dark brown walnut <input type="checkbox"/>	+\$85
ED	aged cherry <input type="checkbox"/>	+\$85
EK	medium red walnut <input type="checkbox"/>	+\$85
UL	natural maple <input type="checkbox"/>	+\$85
UX	walnut on cherry <input type="checkbox"/>	+\$85

Resolve® Work Surfaces

Step 5. Leg Finish		
8Q	folkstone grey	+\$0
LU	soft white	+\$0
CN	metallic champagne	+\$0
EH	metallic bronze	+\$10
MS	metallic silver	+\$0

Equipment Table

R2720.

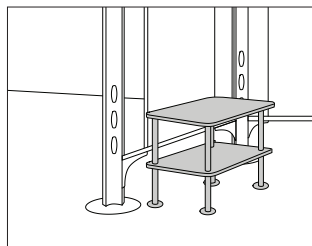

Product Information

Description

This 28"-high rectangular table holds a printer, scanner, fax machine, or other work items, and includes a secondary shelf for additional storage. The tabletop and shelf are 22" deep × 31" wide. The table has 4 legs with glides or casters and a laminate, formcoat®, or veneer finish. The laminate surface has a square thermoplastic edge that matches the top color; the formcoat surface has a square front edge; the veneer surface has a 7/8"-thick, 15-ply Baltic birch core and edge. Glide finishes accent the leg finish; casters are black. Shipped knocked down.

The formcoat finish is available as opaque or fleck. The opaque finish is nontransparent and has a solid-color appearance; the fleck finish is a nontransparent solid color with tiny flecks.

Notes

Order optional swivel tray set (R3620.) separately.

Order optional cable management products separately:

- Cable bag (R1365.)
- Cable manager (R1364.)
- Cord holder (R1366.)

Dimensions

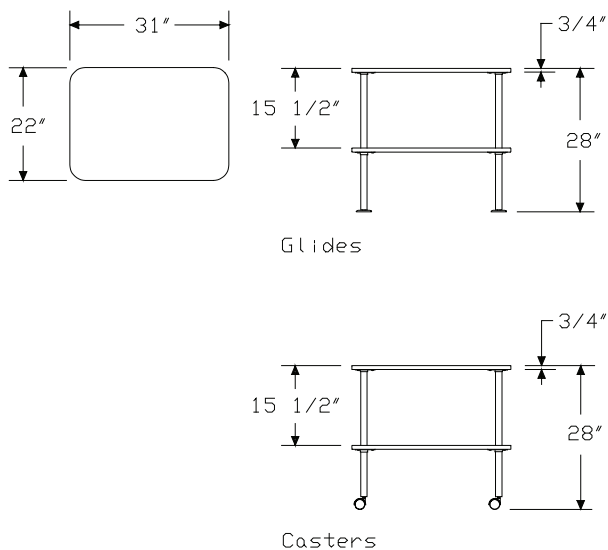

Specification Information

Step 1.

R2720.

Step 2. Casters/Glides

- A** glides
B casters

Step 3. Surface Material

- L** laminate
T formcoat®
W veneer **A**

Prices for Steps 1-3.

	L	T	W
R2720. A	\$703	718	1060
B	\$703	718	1060

Step 4. Top/Shelf Finish

Solid-Color Laminate

For laminate (L)

8Q	folkstone grey	+\$0
91	white	+\$0
CL	cool grey neutral	+\$0
LU	soft white	+\$0
WL	sandstone	+\$0
WN	warm grey neutral	+\$0
X1	chalk white	+\$0

Opaque Formcoat®

For formcoat® (T)

8Q	folkstone grey	+\$0
91	white	+\$0
CL	cool grey neutral	+\$0
LU	soft white	+\$0
WL	sandstone	+\$0
WN	warm grey neutral	+\$0
X1	chalk white	+\$0

For veneer (W)

2U	light brown walnut	+\$100
40	dark brown walnut	+\$100
ED	aged cherry A	+\$100
EK	medium red walnut	+\$100
UL	natural maple A	+\$100
UX	walnut on cherry	+\$100

Resolve® Work Surfaces

Step 5. Leg Finish		
8Q	folkstone grey	+\$0
LU	soft white	+\$0
CN	metallic champagne	+\$0
EH	metallic bronze	+\$10
MS	metallic silver	+\$0
Step 6. Glide Finish		
<i>For glides (A)</i>		
3G	brownstone	+\$0
8Q	folkstone grey	+\$0
CL	cool grey neutral	+\$0
LU	soft white	+\$0
WL	sandstone	+\$0
WN	warm grey neutral	+\$0

Cable Manager

R1364.

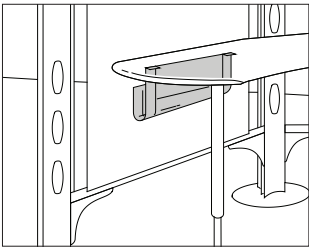

Product Information
Description
This 18"-wide cable manager hangs from the underside of a work surface. It holds and routes cords and cables and can hold a multi-outlet strip or other items. 2 metal brackets provide support to the mesh holder. Mesh color and brackets are grey. Attachment hardware is included.
Dimensions

Specification Information
Step 1.
R1364.
\$93

Resolve® Work Surfaces

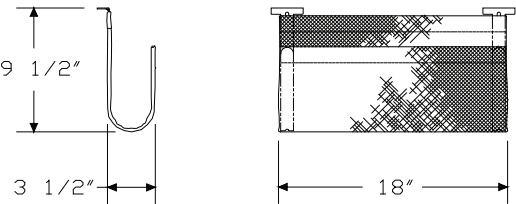

Cord Holder

R1366.

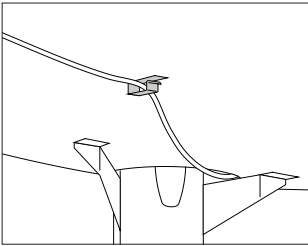

Product Information

Description
This plastic holder attaches to the underside of a work surface to manage cords and cables. It attaches with heavy-duty double-sided tape. Color is folkstone grey. Package contains 6.

Dimensions

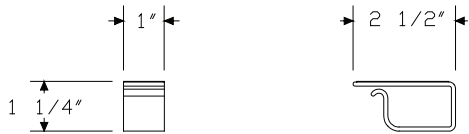

Specification Information

Step 1.
R1366. \$28

Resolve® Work Surfaces

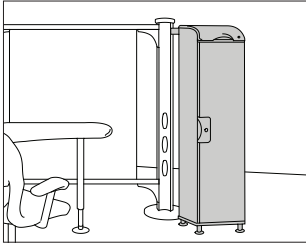

Product Information

Description

This 48"- or 60"-high cabinet attaches to a tall or short pole. It has 4 legs with 1" height-adjustable glides and several interior components including shelves, 6"-deep drawers, and file frames for letter-size hanging files. The interior components are available in prearranged configurations or can be ordered separately. The top of the cabinet includes a lockable lid for secured storage of personal items. The cabinet has a lockable, steel door. Attachment hardware is included. 48" cabinet attaches to a tall or short pole. 60" cabinet attaches to a 60"-high short pole or to a tall pole (60" cabinet cannot attach to a 48"-high short pole). Cabinet must attach to pole for stability; it cannot be used as a freestanding unit.

Notes

To order individual components, specify N for interior configuration and order components separately:

- Cabinet drawer (R3232.)
- Cabinet file frame (R3231.)
- Cabinet shelf (R3230.)

To convert pole-attached cabinet to arm-attached cabinet, order cabinet arm attachment bracket (R3294.) separately.

For keyed-alike locks, order lock plugs separately. See Keyed-Alike Information in Appendices.

Dimensions

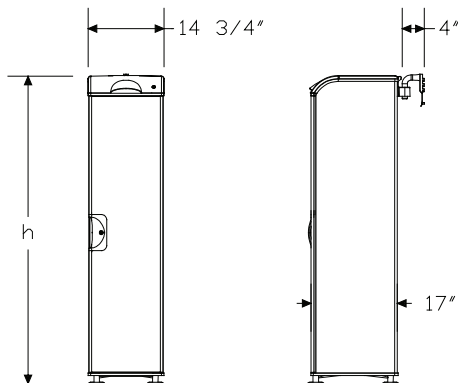

Specification Information

Step 1.

R3211.

Step 2. Cabinet Height

48	48"-high cabinet
60	60"-high cabinet

Step 3. Door

L	left-hinged door
R	right-hinged door

Step 4. Interior Configuration

For 48"-high cabinet (48)

N	no interior components
A	2 shelves
B	4 file frames
C	2 file frames, 1 shelf, 1 drawer
D	2 file frames, 1 shelf, 2 drawers

For 60"-high cabinet (60)

N	no interior components
A	3 shelves
B	5 file frames
C	4 file frames, 1 shelf, 1 drawer
D	3 file frames, 1 shelf, 3 drawers
E	2 file frames, 1 shelf, 3 drawers
F	2 file frames, 1 shelf, 1 drawer

Prices for Steps 1-4.

	N	A	B	C	D	E
R3211. 48 L	\$912	976	1168	1136	1201	—
R	\$912	976	1168	1136	1201	—
60 L	\$1013	1109	1335	1364	1431	1364
R	\$1013	1109	1335	1364	1431	1364
						F
R3211. 60 L						\$1237
R						\$1237

Step 5. Cabinet/Door Finish

8Q	folkstone grey	+\$0
LU	soft white	+\$0
CN	metallic champagne	+\$0
EH	metallic bronze	+\$0
MS	metallic silver	+\$0

Resolve® Storage

Step 6. Lid/Top/Interior/Base Finish		
3G	brownstone	+\$0
8Q	folkstone grey	+\$0
CL	cool grey neutral	+\$0
LU	soft white	+\$0
WL	sandstone	+\$0
WN	warm grey neutral	+\$0
Step 7. Lock Option		
KA	keyed alike	-\$10
KD	keyed differently	+\$0

Cabinet, Arm Attached

R3221.
R3222.

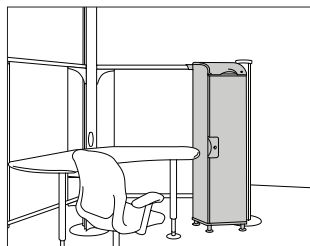

Product Information

Description

This 48"- or 60"-high cabinet has 4 legs with 1" height-adjustable glides and attaches to an upper support arm. It has several interior components including shelves, 6"-deep drawers, and file frames for letter-size hanging files. The interior components are available in prearranged configurations or can be ordered separately. The top of the cabinet includes a lockable lid for secured storage of personal items. The cabinet has a lockable, steel door. Attachment hardware is included.

48" cabinet attaches to a 48" upper support arm height; 60" cabinet attaches to a 48", 60", or 69" upper support arm height. Cabinet must attach to support arm for stability; it cannot be used as a freestanding unit.

Notes

Specify height of cabinet's attachment bracket to match height of upper support arm.

To order individual components, specify N for interior configuration and order components separately:

- Cabinet drawer (R3232.)
- Cabinet file frame (R3231.)
- Cabinet shelf (R3230.)

When placing 2 cabinets back to back, specify N (no attachment bracket) for attachment bracket. Order cabinet back-to-back attachment bracket (R3291.) separately.

To convert arm-attached cabinet to pole-attached cabinet, order cabinet pole attachment bracket (R3293.) separately.

To attach cabinet to different upper support arm height, order cabinet arm attachment bracket (R3294.) separately.

For keyed-alike locks, order lock plugs separately. See Keyed-Alike Information in Appendices.

Dimensions

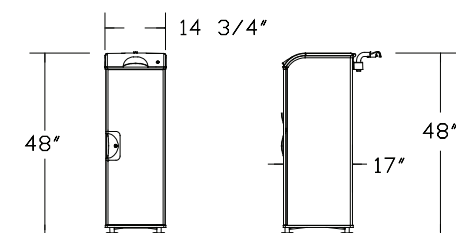

48" Upper Support Arm Height

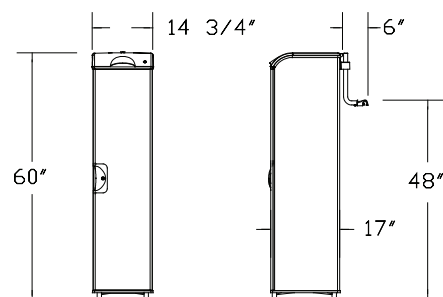

48" Upper Support Arm Height

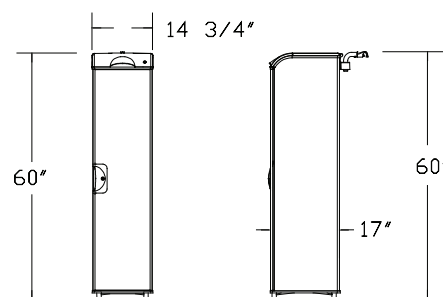

60" Upper Support Arm Height

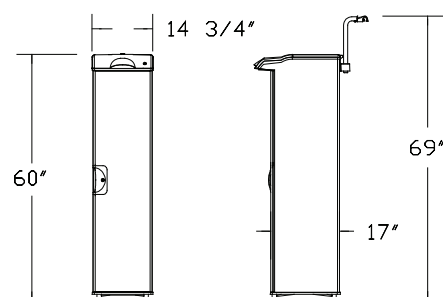

69" Upper Support Arm Height

Specification Information

Step 1.

R322

Step 2. Cabinet Height

1. 48"-high cabinet
2. 60"-high cabinet

Step 3. Upper Support Arm Height

*For 48"-high cabinet (1.)***48** 48" upper support arm height*For 60"-high cabinet (2.)*

48 48" upper support arm height

60 60" upper support arm height

69 69" upper support arm height

Step 4. Attachment Bracket

S single bracket

N no attachment bracket

Step 5. Door

L left-hinged door

R right-hinged door

Step 6. Interior Configuration

For 48"-high cabinet (1.)

N no interior components

A 2 shelves

B 4 file frames

C 2 file frames, 1 shelf, 1 drawer

D 2 file frames, 1 shelf, 2 drawers

For 60"-high cabinet (2.)

N no interior components

A 3 shelves

B 5 file frames

C 4 file frames, 1 shelf, 1 drawer

D 3 file frames, 1 shelf, 3 drawers

E 2 file frames, 1 shelf, 3 drawers

F 2 file frames, 1 shelf, 1 drawer

Prices for Steps 1-6.

	LN	LA	LB	LC	LD	LE
R3221. 48 S	\$912	976	1168	1136	1201	—
N	\$873	937	1130	1098	1162	—

	LF	RN	RA	RB	RC	RD
R3221. 48 S	—	\$912	976	1168	1136	1201
N	—	\$873	937	1130	1098	1162

	LN	LA	LB	LC	LD	LE
R3222. 48 S	\$1013	1109	1335	1364	1431	1364
N	\$976	1071	1295	1329	1392	1329
60 S	\$1013	1109	1335	1364	1431	1364
N	\$976	1071	1295	1329	1392	1329
69 S	\$1013	1109	1335	1364	1431	1364
N	\$976	1071	1295	1329	1392	1329

	LF	RN	RA	RB	RC	RD
R3222. 48 S	\$1237	1013	1109	1335	1364	1431
N	\$1201	976	1071	1295	1329	1392
60 S	\$1237	1013	1109	1335	1364	1431
N	\$1201	976	1071	1295	1329	1392
69 S	\$1237	1013	1109	1335	1364	1431
N	\$1201	976	1071	1295	1329	1392

	RE	RF
R3222. 48 S	\$1364	1237
N	\$1329	1201
60 S	\$1364	1237
N	\$1329	1201
69 S	\$1364	1237
N	\$1329	1201

Step 7. Cabinet/Door Finish

8Q	folkstone grey	+\$0
LU	soft white	+\$0
CN	metallic champagne	+\$0
EH	metallic bronze	+\$0
MS	metallic silver	+\$0

Step 8. Lid/Top/Interior/Base Finish

3G	brownstone	+\$0
8Q	folkstone grey	+\$0
CL	cool grey neutral	+\$0
LU	soft white	+\$0
WL	sandstone	+\$0
WN	warm grey neutral	+\$0

Step 9. Lock Option		
KA	keyed alike	-\$10
KD	keyed differently	+\$0

Cabinet Shelf

R3230.

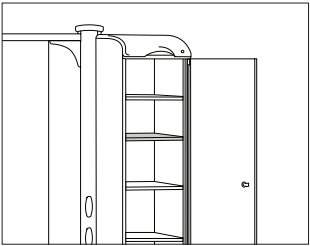

Product Information

Description
This shelf fits inside a pole- or arm-attached cabinet and stores books, binders, and other items. It adjusts vertically in 2" increments.

Dimensions

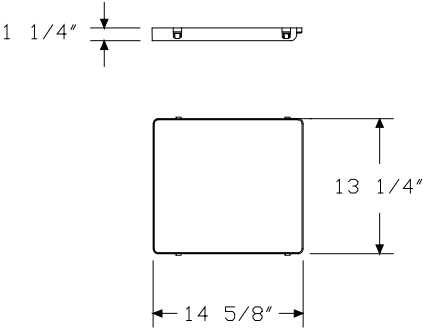

Specification Information

Step 1.
R3230. \$58

Step 2. Finish		
3G	brownstone	+\$0
8Q	folkstone grey	+\$0
CL	cool grey neutral	+\$0
LU	soft white	+\$0
WL	sandstone	+\$0
WN	warm grey neutral	+\$0

Resolve® Storage

Cabinet File Frame

R3231.

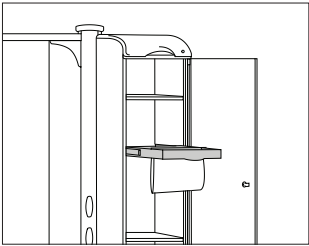

Product Information
Description
This file frame fits inside a pole- or arm-attached cabinet and holds letter-size hanging files. It adjusts vertically in 2" increments.
Dimensions

2 1/2" 2 3/4"

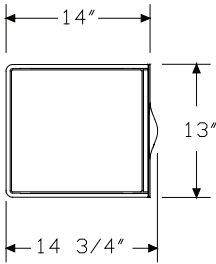

Specification Information
Step 1.
R3231.
Step 2. Finish
3G brownstone
8Q folkstone grey
CL cool grey neutral
LU soft white
WL sandstone
WN warm grey neutral

\$144
+\$0
+\$0
+\$0
+\$0
+\$0
+\$0

Resolve® Storage

Cabinet Drawer

R3232.

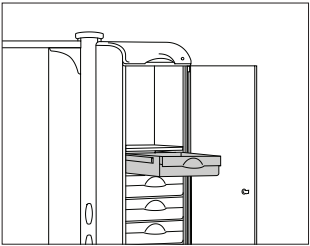

Product Information

Description
This 6"-high drawer fits inside a pole- or arm-attached cabinet and holds papers, supplies, and other small items. It adjusts vertically in 2" increments.

Dimensions

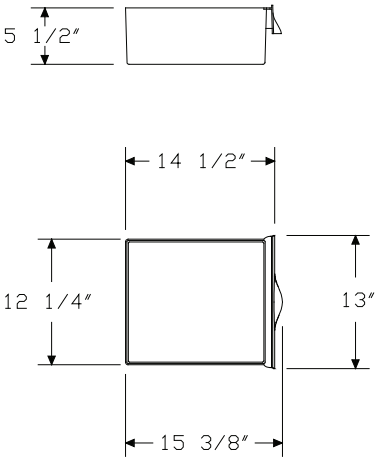

Specification Information

Step 1.
R3232. \$173

Step 2. Finish		
3G	brownstone	+\$0
8Q	folkstone grey	+\$0
CL	cool grey neutral	+\$0
LU	soft white	+\$0
WL	sandstone	+\$0
WN	warm grey neutral	+\$0

Resolve® Storage

Back-to-Back Attachment Bracket, R3291. Cabinets

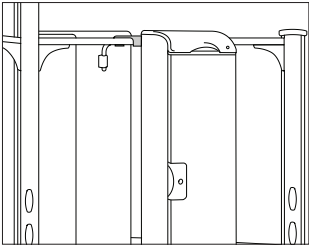

Product Information
Description
This bracket attaches 2 arm-attached cabinets back to back. 1 bracket is required for each application.
Dimensions

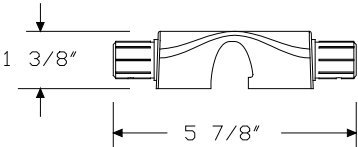

Specification Information
Step 1.
R3291. \$77
Step 2. Finish
8Q folkstone grey +\$0
LU soft white +\$0
CN metallic champagne +\$0
EH metallic bronze +\$0
MS metallic silver +\$0

Resolve® Storage

Pole Attachment Bracket,
Cabinet

R3293.

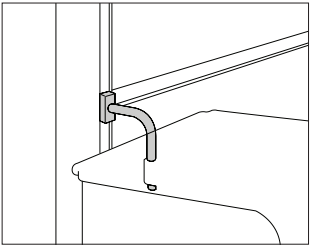

Product Information

Description
This bracket converts an arm-attached cabinet to a pole-attached cabinet.

Dimensions

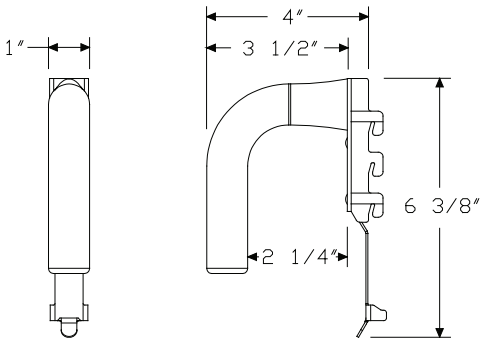

Specification Information

Step 1.
R3293.60 \$103

Step 2. Finish		
8Q	folkstone grey	+\$0
CN	metallic champagne	+\$0
EH	metallic bronze	+\$0
LU	soft white	+\$0
MS	metallic silver	+\$0

Arm Attachment Bracket, Cabinet R3294.

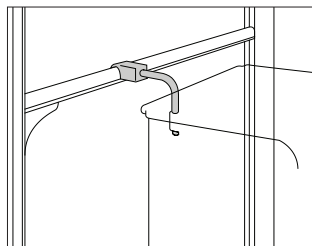

Product Information

Description

This bracket converts a pole-attached cabinet to an arm-attached cabinet. It also can change an existing arm-attached cabinet's attachment height.

Dimensions

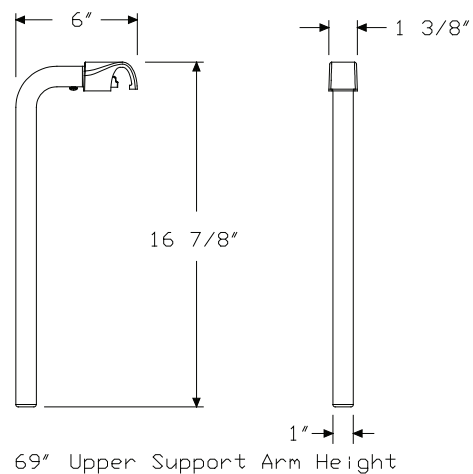
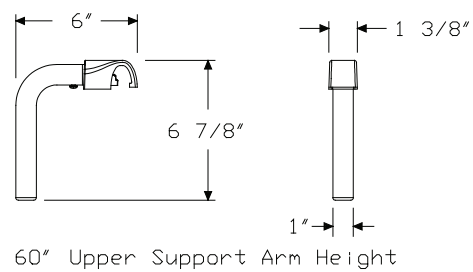
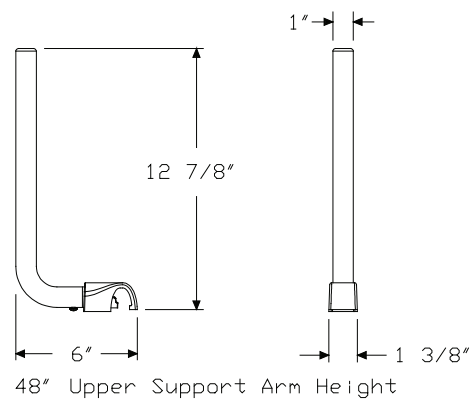

Arm Attachment Bracket, Cabinet

continued

Resolve® Storage

Specification Information		
Step 1.		
R3294.		
Step 2. Upper Support Arm Height		
48	48" upper support arm height	
60	60" upper support arm height	
69	69" upper support arm height	
Prices for Steps 1-2.		
R3294. 48		\$103
60		\$101
69		\$98
Step 3. Finish		
8Q	folkstone grey	+\$0
LU	soft white	+\$0
CN	metallic champagne	+\$0
EH	metallic bronze	+\$0
MS	metallic silver	+\$0

Ladder Shelf

R3312.

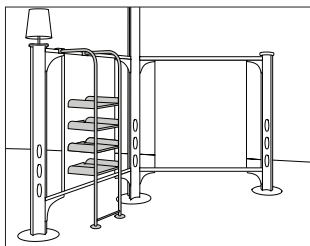

Product Information

Description

This storage unit has adjustable, open shelves and attaches to an upper support arm. It holds binders, books, reference materials, and other items. The ladder shelf has two 2½" height-adjustable glides.

Attachment hardware is included.

The 48"-high unit includes 3 shelves; the 60"-high unit includes 4 shelves; and the 69"-high unit includes 5 shelves. The shelves adjust vertically in 1" increments and can be specified with 3½"- or 6"-high shelf sides.

Notes

Specify height of ladder shelf's attachment bracket to match height of upper support arm.

When placing 2 ladder shelves back to back, specify N (no attachment bracket) for attachment bracket. Order ladder shelf back-to-back attachment bracket (R3391.) separately.

Order optional add-on ladder shelves (R3320.) separately.

Dimensions

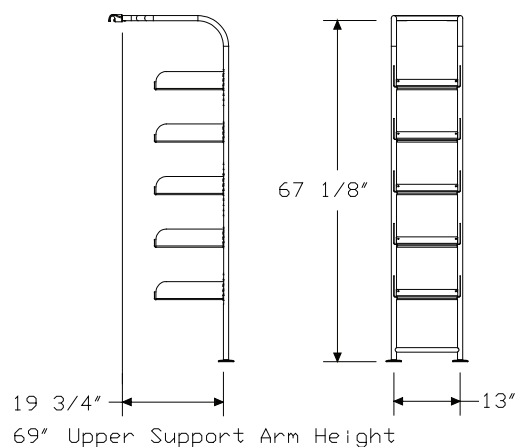
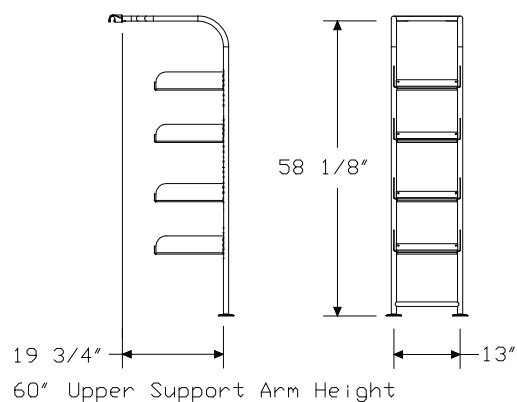
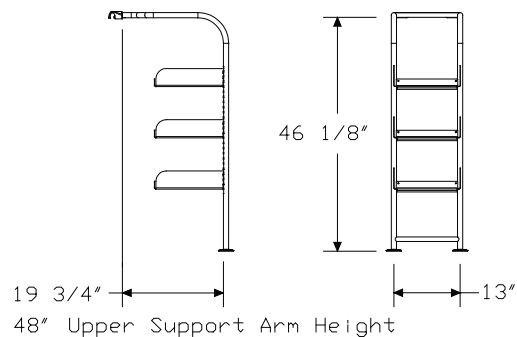

Resolve® Storage

Specification Information

Step 1.
R3312.

Step 2. Upper Support Arm Height

- 48** 48" upper support arm height
- 60** 60" upper support arm height
- 69** 69" upper support arm height

Step 3. Shelf Height

- 3** 3½"-high shelf
- 6** 6"-high shelf

Step 4. Attachment Bracket

- S** single bracket
- N** no attachment bracket

Prices for Steps 1-4.

	S	N
R3312. 48 3	\$616	547
6	\$764	693
60 3	\$724	653
6	\$909	842
69 3	\$831	764
6	\$1028	960

Step 5. Frame/Shelf Finish

- 8Q** folkstone grey +\$0
- LU** soft white +\$0
- CN** metallic champagne +\$0
- EH** metallic bronze +\$0
- MS** metallic silver +\$0

Step 6. Base/Glide Finish

- 3G** brownstone +\$0
- 8Q** folkstone grey +\$0
- CL** cool grey neutral +\$0
- LU** soft white +\$0
- WL** sandstone +\$0
- WN** warm grey neutral +\$0

Add-On Ladder Shelf

R3320.

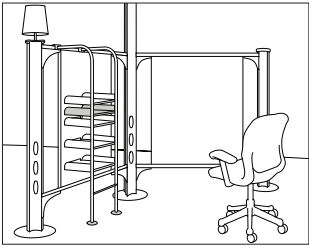

Product Information
Description
This shelf can be added to a ladder shelf for additional shelving. It adjusts vertically in 1" increments and can be specified with 3 1/2"- or 6"-high shelf sides.
Dimensions

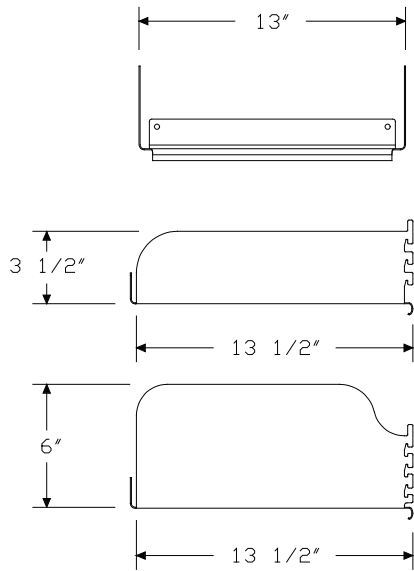

Specification Information
Step 1.
R3320.
Step 2. Shelf Height
3 3 1/2"-high shelf
6 6"-high shelf
Prices for Steps 1-2.
R3320. 3 \$93
6 \$124
Step 3. Finish
8Q folkstone grey +\$0
LU soft white +\$0
CN metallic champagne +\$0
EH metallic bronze +\$0
MS metallic silver +\$0

Resolve® Storage

Ladder Shelf DividerR3390.

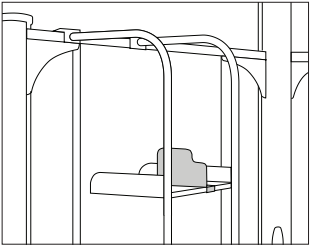

Product Information

Description
This shelf divider attaches to a ladder shelf or add-on ladder shelf to separate or support binders, books, reference materials, and other items. Package contains 6.

Dimensions

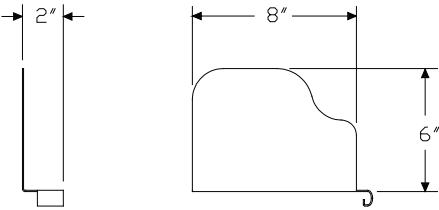

Specification Information

Step 1.
R3390. \$322

Step 2. Finish		
8Q	folkstone grey	+\$0
LU	soft white	+\$0
CN	metallic champagne	+\$0
EH	metallic bronze	+\$0
MS	metallic silver	+\$0

Back-to-Back Attachment
Brackets, Ladder Shelves

R3391.

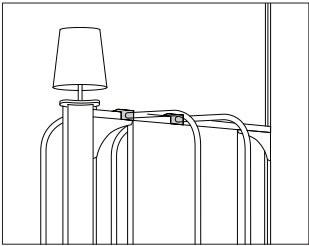

Product Information
Description
This bracket attaches 2 ladder shelves back to back. 2 brackets are required for each application. Package contains 2.
Dimensions

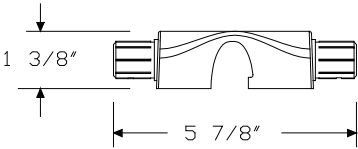

Specification Information		
Step 1.		
R3391.		\$102
Step 2. Finish		
8Q	folkstone grey	+\$0
LU	soft white	+\$0
CN	metallic champagne	+\$0
EH	metallic bronze	+\$0
MS	metallic silver	+\$0

Resolve® Storage

Pole Shelf

R7310.

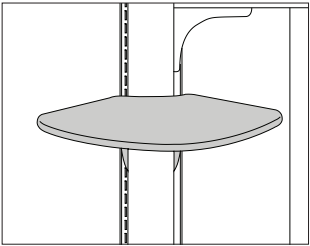

Product Information

Description

This shelf attaches to a tall or short pole and holds display items, small electronics, and other items. It is available in 2 sizes: the 9"-deep shelf holds 25 pounds; the 13"-deep shelf holds up to 50 pounds. The shelf has a laminate, formcoat®, or veneer finish. Attachment brackets are included.

The formcoat finish is available as opaque or fleck. The opaque finish is nontransparent and has a solid-color appearance; the fleck finish is a nontransparent solid color with tiny flecks. The veneer shelf has a 1/2"-thick, 9-ply Baltic birch core and edge.

Notes

Order optional bud vase (R7421.) separately.

Dimensions

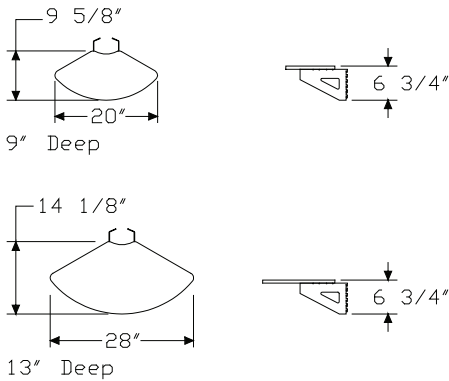

Specification Information

Step 1.

R7310.

Step 2. Depth

- 09** 9" deep
- 13** 13" deep

Step 3. Surface Material

- L** laminate
- T** formcoat®
- W** veneer A

Prices for Steps 1-3.

	L	T	W
R7310. 09	\$205	188	313
13	\$227	205	344

Step 4. Shelf Finish

Solid-Color Laminate

For laminate (L)

8Q	folkstone grey	+\$0
91	white	+\$0
CL	cool grey neutral	+\$0
LU	soft white	+\$0
WL	sandstone	+\$0
WN	warm grey neutral	+\$0
X1	chalk white	+\$0

Opaque Formcoat®

For formcoat® (T)

8Q	folkstone grey	+\$0
91	white	+\$0
CL	cool grey neutral	+\$0
LU	soft white	+\$0
WL	sandstone	+\$0
WN	warm grey neutral	+\$0
X1	chalk white	+\$0

Pole Shelf *continued*

Wood Veneer

For veneer (W)

		09	13
2U	light brown walnut	+\$25	30
40	dark brown walnut	+\$25	30
ED	aged cherry A	+\$25	30
EK	medium red walnut	+\$25	30
UL	natural maple A	+\$25	30
UX	walnut on cherry	+\$25	30

Step 5. Bracket Finish

8Q	folkstone grey	+\$0
LU	soft white	+\$0
CN	metallic champagne	+\$0
EH	metallic bronze	+\$0
MS	metallic silver	+\$0

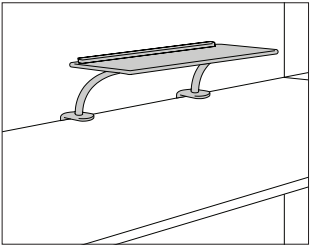

Product Information

Description
This shelf attaches to the back edge of a work surface and holds binders, books, files, small electronics, and personal items. It is available in 2 sizes: the 18"-wide shelf holds up to 54 pounds; the 30"-wide shelf holds up to 90 pounds. Each shelf has a raised back edge to prevent items from sliding off the back. The shelf has a laminate, formcoat®, or veneer surface finish. Attachment hardware adjusts to fit surfaces 3/4" to 1 1/4" thick. Attachment hardware requires at least 1 1/2" of clearance behind the back edge of the surface.
The formcoat finish is available as opaque or fleck. The opaque finish is nontransparent and has a solid-color appearance; the fleck finish is a nontransparent solid color with tiny flecks. The veneer shelf has a 1/2"-thick, 9-ply Baltic birch core and edge.
Back edge colors are predetermined:

- Laminate shelves have a folkstone grey (8Q) edge, except for WL. Sandstone laminate (WL) has a sandstone (WL) edge.
- Opaque formcoat shelves have a folkstone grey (8Q) edge, except for WL. Sandstone opaque formcoat (WL) has a sandstone (WL) edge.
- Fleck formcoat shelves have a sandstone (WL) edge.
- Veneer shelves have a sandstone (WL) edge.

Notes
Order bookshelf dividers (G7332.) separately; dividers can only be used on formcoat bookshelves (G7314.T).

Dimensions

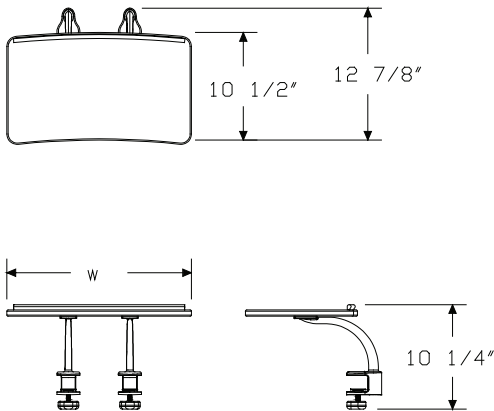

Specification Information

Step 1.
G7314.

Step 2. Width	
18	18" wide
30	30" wide

Step 3. Surface Material	
L	laminate
T	formcoat®
W	veneer

Prices for Steps 1-3.			
	L	T	W
G7314. 18	\$216	228	340
30	\$251	266	394

Step 4. Shelf Finish

Solid-Color Laminate		
For laminate (L)		
8Q	folkstone grey	+\$0
91	white	+\$0
CL	cool grey neutral	+\$0
LU	soft white	+\$0
WL	sandstone	+\$0
WN	warm grey neutral	+\$0
X1	chalk white	+\$0

Opaque Formcoat®		
For formcoat® (T)		
8Q	folkstone grey	+\$0
91	white	+\$0
CL	cool grey neutral	+\$0
LU	soft white	+\$0
WL	sandstone	+\$0
WN	warm grey neutral	+\$0
X1	chalk white	+\$0

Wood Veneer

For veneer (W)

		18	30
2U	light brown walnut <input type="checkbox"/> A	+\$25	30
40	dark brown walnut <input type="checkbox"/> A	+\$25	30
ED	aged cherry <input type="checkbox"/> A	+\$25	30
EK	medium red walnut <input type="checkbox"/> A	+\$25	30
UL	natural maple <input type="checkbox"/> A	+\$25	30
UX	walnut on cherry <input type="checkbox"/> A	+\$25	30

Step 5. Bracket Finish

		L	T	W
8Q	folkstone grey	+\$0	0	0
LU	soft white	+\$0	0	0
CN	metallic champagne	+\$0	0	10
EH	metallic bronze	+\$0	0	10
MS	metallic silver	+\$0	0	10

Bookshelf Divider

G7332.

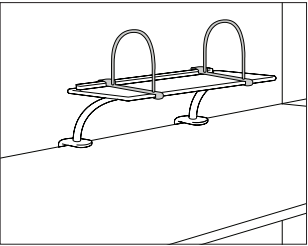

Product Information
Description
This divider fits on a formcoat® bookshelf and secures binders, books, and other items. Package contains 2.
Notes
Dividers cannot be used on laminate version of bookshelf; use on formcoat version only (G7314.T).
Dimensions

Specification Information		
Step 1.		
G7332.		\$26
Step 2. Finish		
3G	brownstone	+\$0
8Q	folkstone grey	+\$0
91	white	+\$0
CL	cool grey neutral	+\$0
LU	soft white	+\$0
WL	sandstone	+\$0
WN	warm grey neutral	+\$0

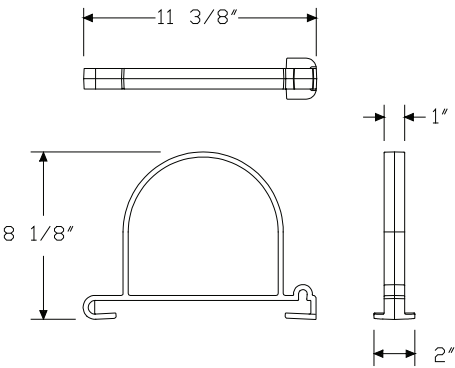

Tool Rail

R3610.

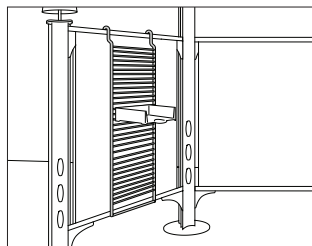

Product Information

Description

This tool rail hangs from an upper support arm and rests against the lower support arm. It holds work tools.

Notes

Specify height of tool rail to match height of upper support arm.

Tool rails cannot be located back to back; units must be horizontally offset by 1".

Dimensions

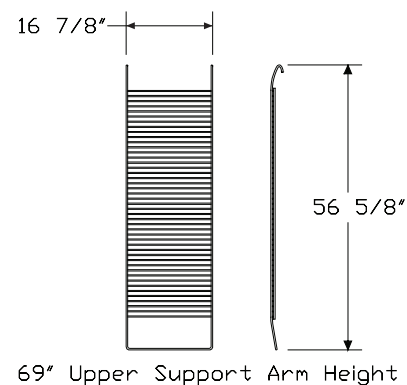
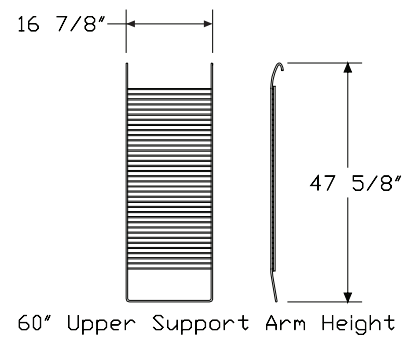
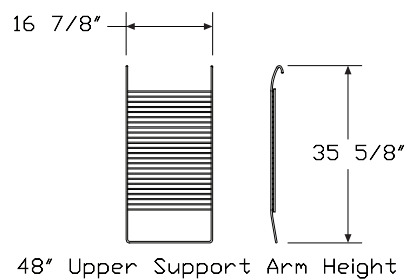

Resolve® Storage

Specification Information		
Step 1.		
R3610.		
Step 2. Upper Support Arm Height		
48	48" upper support arm height	
60	60" upper support arm height	
Prices for Steps 1-2.		
R3610. 48		\$185
60		\$257
Step 3. Finish		
8Q	folkstone grey	+\$0
LU	soft white	+\$0
CN	metallic champagne	+\$0
EH	metallic bronze	+\$0
MS	metallic silver	+\$0

Swivel Tray Set

R3620.

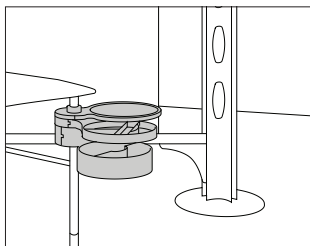

Product Information

Description

This set of storage components attaches to the leg of an input table or equipment table, or to the underside of a work surface, input table, or equipment table. It includes a 9" diameter café tray, pencil tray, and storage tray. The trays swivel to accommodate various work needs and swivel under the table or work surface for storage. Attachment hardware is included.

Dimensions

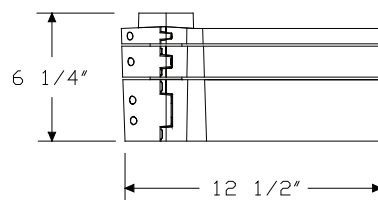
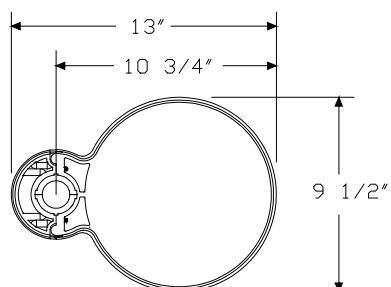

Input Table Leg Attachment

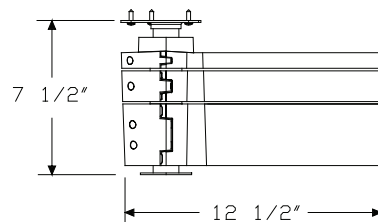
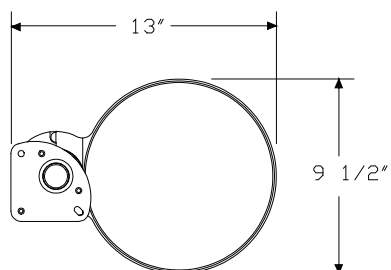

Underside of Work Surface or
Input Table Attachment

Resolve® Storage

Specification Information		
Step 1.		
R3620.		
Step 2. Attachment		
1	input table leg attachment	
2	underside of work surface attachment	
Prices for Steps 1-2.		
R3620. 1		\$140
2		\$140
Step 3. Finish		
3G	brownstone	+\$0
8Q	folkstone grey	+\$0
CL	cool grey neutral	+\$0
LU	soft white	+\$0
WL	sandstone	+\$0
WN	warm grey neutral	+\$0

Coat Hook

R7420.

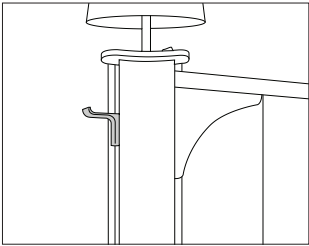

Product Information
Description
This hook attaches to a tall or short pole and holds coats, hats, and umbrellas. Package contains 6.
Dimensions

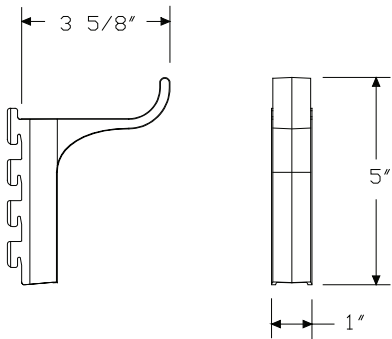

Specification Information		
Step 1.		
R7420.		\$73
Step 2. Finish		
3G	brownstone	+\$0
8Q	folkstone grey	+\$0
CL	cool grey neutral	+\$0
LU	soft white	+\$0
WL	sandstone	+\$0
WN	warm grey neutral	+\$0

Resolve® Storage

Bud Vase

R7421.

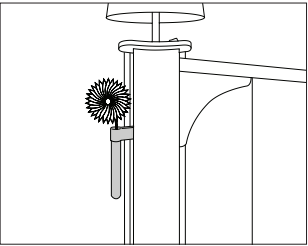

Product Information

Description

This vase attaches to a tall or short pole, bookshelf, or pole shelf. It is clear plastic and is top-shelf dishwasher safe. Package contains 6. Attachment bracket is included.

Dimensions

Specification Information

Step 1.

R7421. \$197

Step 2. Bracket Finish

3G	brownstone	+\$0
8Q	folkstone grey	+\$0
CL	cool grey neutral	+\$0
LU	soft white	+\$0
WL	sandstone	+\$0
WN	warm grey neutral	+\$0

Resolve® Display Components

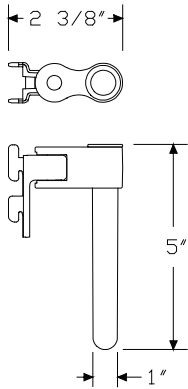

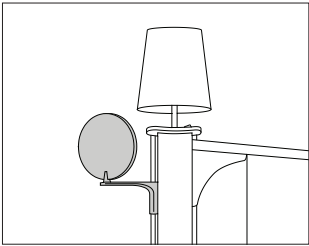

Product Information
Description
This 6"-diameter disk attaches to a tall, short, or in-line pole and provides workstation identification or displays messages on 1 side. Package contains 6 disks and 12 perforated sheets to create your own signage.
Notes
Additional perforated sheets for creating signage are available through Sales Source.
Dimensions

Specification Information		
Step 1.		
R7422.		\$197
Step 2. Finish		
3G	brownstone	+\$0
8Q	folkstone grey	+\$0
CL	cool grey neutral	+\$0
LU	soft white	+\$0
WL	sandstone	+\$0
WN	warm grey neutral	+\$0

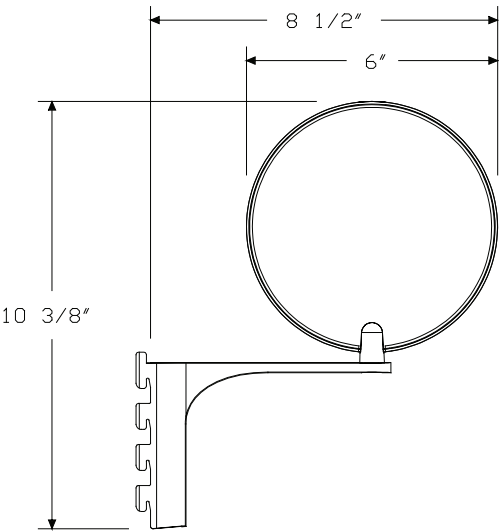

Marker Board

R7424.

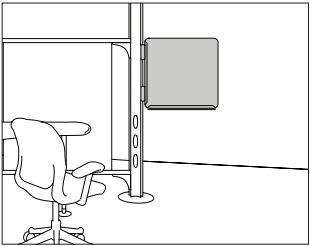

Product Information
Description
This 24" high × 24" wide double-sided marker board attaches to a tall or short pole. It has a white erasable writing surface and a tray along the bottom of each side for markers and erasers. The marker board swivels for proper positioning.
Notes
Markers and erasers are not included.
Dimensions

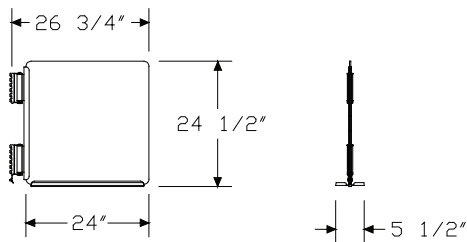

Specification Information		
Step 1.		
R7424.2424		\$415
Step 2. Bracket Finish		
8Q	folkstone grey	+\$0
LU	soft white	+\$0
CN	metallic champagne	+\$0
EH	metallic bronze	+\$0
MS	metallic silver	+\$0
Step 3. Tray/Trim Finish		
3G	brownstone	+\$0
8Q	folkstone grey	+\$0
CL	cool grey neutral	+\$0
LU	soft white	+\$0
WL	sandstone	+\$0
WN	warm grey neutral	+\$0

Flag Arm

R7423.

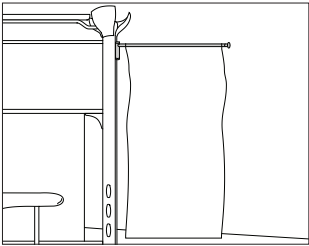

Product Information
Description
This 1"-diameter arm attaches to a tall pole and holds a flag. Attachment hardware is included.
Notes
Order flag separately:
• Flag (R7100.)
Dimensions

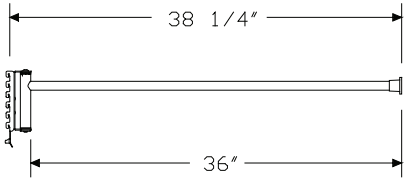

Specification Information
Step 1.
R7423.
\$180
Step 2. Arm Finish
8Q folkstone grey
LU soft white
CN metallic champagne
EH metallic bronze
MS metallic silver
Step 3. Cap Finish
3G brownstone
8Q folkstone grey
CL cool grey neutral
LU soft white
WL sandstone
WN warm grey neutral

Resolve® Display Components

Flag

R7100.

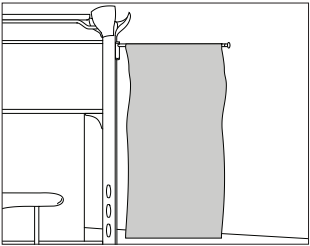

Product Information

Description
This fabric flag hangs on a flag arm. It is 35" wide × 75" long and includes a weight in the bottom hem. Attachment hardware is included.

Notes
Order flag arm (R7423.) separately.
Flag accepts Customer's Own Material (COM). For nondirectional fabrics, order minimum of 2¼ yards. For information on multiple quantities or directional fabrics, contact COM Department. See Order Information in Appendices.

Dimensions

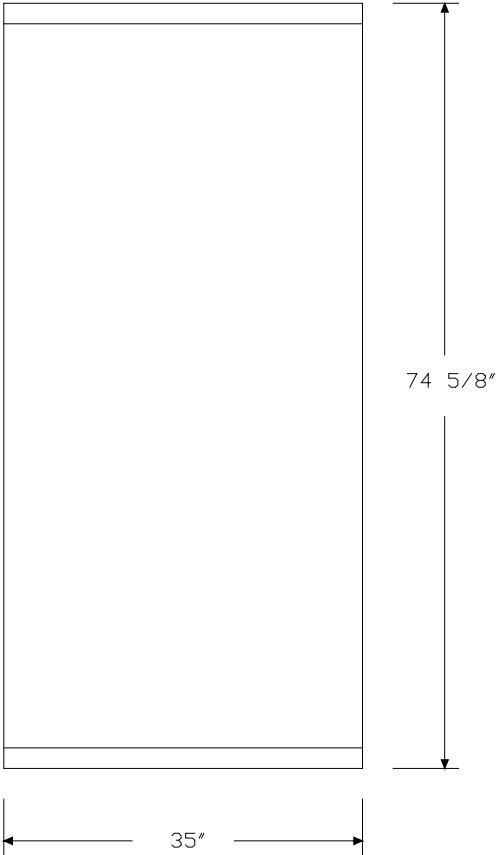

Specification Information

Step 1.
R7100.3575 \$160

Step 2. Fabric
See application chart and textiles list for fabric usage and numbers. First 2 digits of number indicate fabric line; remaining digit(s) indicate fabric color.

Price Category 1 +\$0

Picture Holder

R7410.

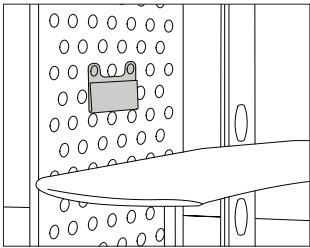

Product Information
Description This holder attaches to a display screen. It has 1 sleeve that holds two 5" × 7" pictures or photographs weighing up to 3 pounds. The holder has locators for easy attachment to and removal from the bubbletack™ display screen. Finish is translucent acrylic. Package contains 6.
Notes Order display screen (R1420.) separately.
Dimensions

Specification Information	
Step 1.	
R7410.	\$366

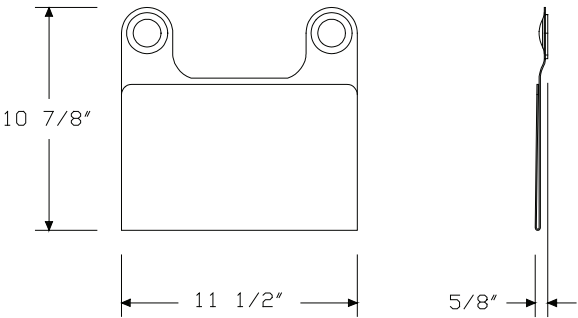

Ledge

R7411.

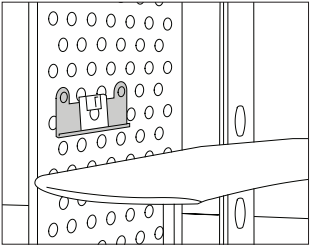

Product Information

Description
This 1"-deep ledge attaches to a display screen and holds disks, CDs, small note pads, pictures, and other lightweight items weighing up to 3 pounds. It has locators for easy attachment to and removal from the bubbletack™ display screen. The ledge is translucent acrylic. Package contains 6.

Notes

Order display screen (R1420.) separately.

Dimensions

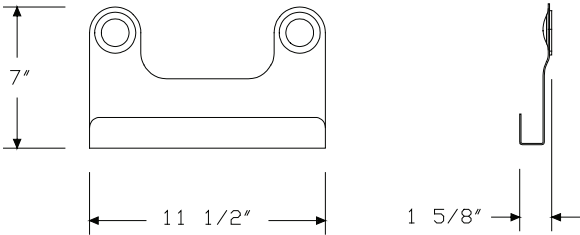

Specification Information

Step 1.
R7411. \$360

Resolve® Display Components

Document Holder

R7412.

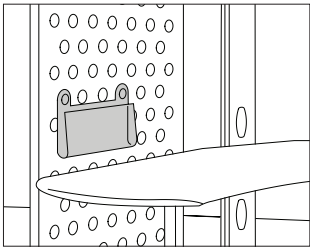

Product Information
Description
This holder attaches to a display screen and holds lightweight papers and folders weighing up to 3 pounds. It has locators for easy attachment to and removal from the bubbletack™ display screen. The holder is translucent acrylic. Package contains 6.
Notes
Order display screen (R1420.) separately.
Dimensions

Specification Information
Step 1.
R7412.
\$373

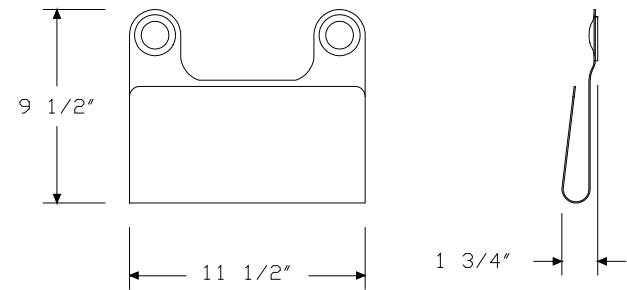

Mirror

R7413.

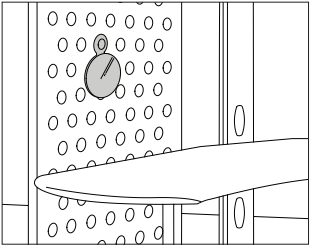

Product Information

Description
This 6"-diameter mirror attaches to a display screen. It has locators for easy attachment to and removal from the bubbletack™ display screen. Frame is translucent acrylic. Package contains 6.

Notes
Order display screen (R1420.) separately.

Dimensions

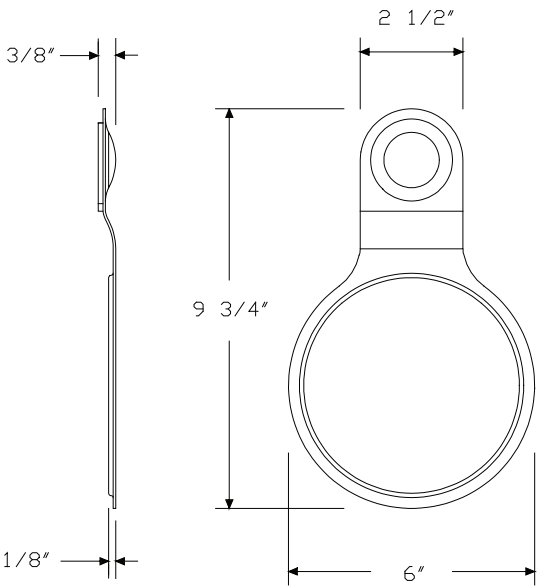

Specification Information

Step 1.
R7413. \$321

Resolve® Display Components

Utility Hook

R7414.

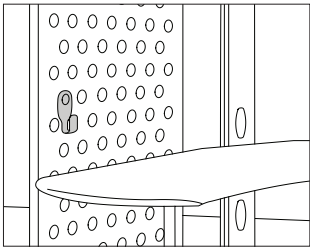

Product Information
Description
This hook attaches to a display screen and holds lightweight items like keys, headphones, or ID tags weighing up to 1 pound. It has 1 locator for easy attachment to and removal from the bubbletack™ display screen. The hook is translucent acrylic. Package contains 6.
Notes
Order display screen (R1420.) separately.
Dimensions

Specification Information
Step 1.
R7414.
\$308

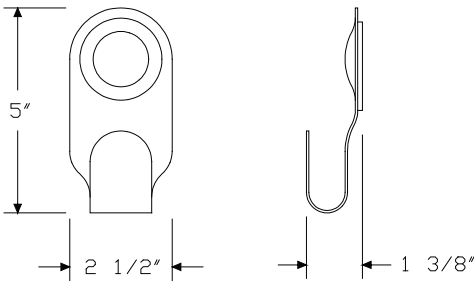

Support Arm Task Light

R6140.
R6141.

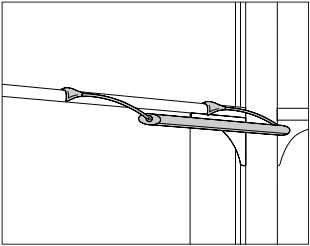

Product Information

Description

This light mounts on an upper support arm and provides overhead task lighting to 1 side of a boomerang™ work surface. The light has a rapid-start shielded electronic ballast, T5 fluorescent lamp with a 3500° Kelvin color temperature, and 9' cord. The light cord and switch are located on the right side. The lamp has a refractive Holophane™ lens and the lamp's housing tilts from a level position to 45° backward. The 30"-wide light has a 14-watt lamp; the 42"-wide light has a 21-watt lamp. It is UL listed and UL Canada listed. Mounting hardware and 2 cord management clips are included.

Notes

42"-wide lights cannot be used back to back on 48"-long support arm.

Dimensions

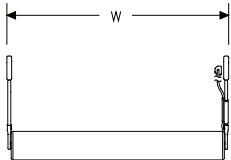
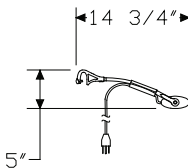

Specification Information

Step 1.

R614

Step 2. Code Requirements

- 0. meets local codes including Canada and New York City
- 1. meets Chicago codes

Step 3. Width

- 30 30" wide
- 42 42" wide

Prices for Steps 1-3.

R6140. 30	\$642
42	\$684

R6141. 30	\$751
42	\$801

Step 4. Finish

8Q	folkstone grey	+\$0
LU	soft white	+\$0
CN	metallic champagne	+\$0
EH	metallic bronze	+\$0
MS	metallic silver	+\$0

Pole Lamp

R6310.
R6311.

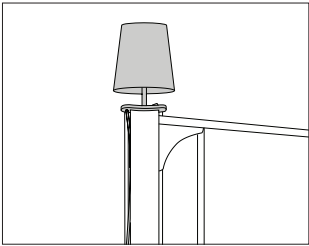

Product Information
Description
This lamp mounts on top of a short pole and provides indirect lighting. It has an energy-efficient 13-watt compact fluorescent lamp with a 3000° Kelvin color temperature. The lamp has an on/off switch in the base, a 9' electrical cord, a 120-volt magnetic ballast with a disconnect plug next to the ballast, and a white lampshade. The lamp replaces the top cap on the short pole. It is UL listed and UL Canada listed. Attachment hardware is included.
Notes
Lamp has a .3-amp draw.
Lamp for Chicago codes (R6311.) has a reset, circuit-breaker plug.
To manage cords down face of short pole, order 1 of the following separately:
<ul style="list-style-type: none">• Cable cover (R1361.)• Cable management clips (R1362.)
When using lamp on nonpowered short pole, order nonpowered power/data channel (R1351.) separately to route cable to adjacent powered pole.
Dimensions

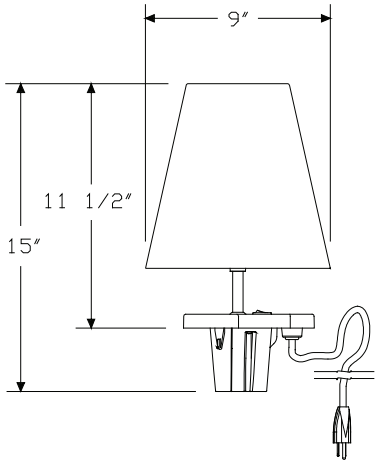

Specification Information
Step 1.
R631
Step 2. Code Requirements
0. meets local codes including New York City
1. meets Chicago codes
Prices for Steps 1-2.
R6310.
R6311.
Step 3. Post Finish
8Q folkstone grey
CN metallic champagne
EH metallic bronze
LU soft white
MS metallic silver
Step 4. Top Cap Finish
3G brownstone
8Q folkstone grey
CL cool grey neutral
LU soft white
WL sandstone
WN warm grey neutral

Index by Product Name

Resolve® System	
Acoustical Insert	page(s) 43
Add-On Ladder Shelf	81
Arm Attachment Bracket, Cabinet	77
Back-to-Back Attachment Bracket, Cabinets	75
Back-to-Back Attachment Brackets, Ladder Shelves	83
Bookshelf	86
Bookshelf Divider	88
Boomerang™ Work Surface	52
Boundary Screen	39
Bud Vase	94
Cabinet Drawer	74
Cabinet File Frame	73
Cabinet Shelf	72
Cabinet, Arm Attached	69
Cabinet, Pole Attached	67
Cable Bag	37
Cable Cover	35
Cable Management Clip	36
Cable Manager	65
Canopy	50
Ceiling Power/Data Entry	15
Ceiling Power/Data Entry, New York City	18
Coat Hook	93
Communication Port Faceplate Extender	38
Controlled Duplex Receptacle	31
Controlled Receptacle Decal (12 per sheet)	32
Cord Holder	66
Data Faceplate Housing	34
Display Screen	41
Document Holder	101
Duplex Receptacle	30
Equipment Table	63
Extended Boomerang™ Work Surface	54
Fixed Truss	12
Flag	98
Flag Arm	97
Floor/Wall Power Entry	14
Floor/Wall Power Entry, New York City	17
Freestanding Boomerang™ Work Surface	57
Freestanding Extended Boomerang™ Work Surface	59
In-Line Pole	9
Input Table	61
Ladder Shelf	79
Ladder Shelf Divider	82
Ledge	100

Marker Board	96
Marker Screen	44
Mirror	102
Nesting Rolling Screen	47
Picture Holder	99
Pole Attachment Bracket, Cabinet	76
Pole Lamp	105
Pole Shelf	84
Power Block	29
Power Entry Plate	20
Power Harness, Short Pole	28
Power Harness, Tall Pole	27
Power Jumper Conversion Kit, Fixed Truss	25
Power Jumper Conversion Kit, Power/Data Channel	23
Power Jumper Conversion Kit, Sliding Truss	26
Power Pass-Through Bracket	24
Power/Data Channel	22
Receptacle Box/Cover	21
Replacement Fabric for Canopy	51
Replacement Fabric for Rolling Screen	49
Rolling Screen	45
Seismic Clip	10
Short Pole	7
Signage	95
Simplex Receptacle	33
Sliding Truss	13
Support Arm Task Light	104
Support Arms	11
Swivel Tray Set	91
Tall Pole	5
Tool Rail	89
Utility Hook	103
Work Surface Bracket	56

Index by Product Number

G1189. Communication Port Faceplate Extender	page(s) 38
G7314. Bookshelf	86
G7332. Bookshelf Divider	88
G9999. Controlled Receptacle Decal (12 per sheet)	32
R1110. Tall Pole	5
R1120. Short Pole	7
R1140. In-Line Pole	9
R1190. Seismic Clip	10
R1210. Support Arms	11
R1220. Fixed Truss	12
R1230. Sliding Truss	13
R1311. Duplex Receptacle	30
R1311M Controlled Duplex Receptacle	31
R1312. Simplex Receptacle	33
R1313. Receptacle Box/Cover	21
R1320. Floor/Wall Power Entry	14
R1321. Floor/Wall Power Entry, New York City	17
R1325. Power Entry Plate	20
R1331. Ceiling Power/Data Entry, New York City	18
R1332. Ceiling Power/Data Entry	15
R1341. Power Jumper Conversion Kit, Power/Data Channel	23
R1345. Power Jumper Conversion Kit, Fixed Truss	25
R1346. Power Jumper Conversion Kit, Sliding Truss	26
R1351. Power/Data Channel	22
R1352. Power Pass-Through Bracket	24
R1360. Data Faceplate Housing	34
R1361. Cable Cover	35
R1362. Cable Management Clip	36
R1364. Cable Manager	65
R1365. Cable Bag	37
R1366. Cord Holder	66
R1380. Power Harness, Tall Pole	27
R1381. Power Harness, Short Pole	28
R1382. Power Block	29
R1410. Boundary Screen	39
R1412. Acoustical Insert	43
R1420. Display Screen	41
R1430. Canopy	50
R1432. Replacement Fabric for Canopy	51
R1441. Rolling Screen	45
R1442. Nesting Rolling Screen	47
R1444. Replacement Fabric for Rolling Screen	49
R1450. Marker Screen	44
R2100. Boomerang™ Work Surface	52
R2104. Extended Boomerang™ Work Surface	54
R2105.	



R2190. Work Surface Bracket	56
R2600. Input Table	61
R2650. Freestanding Boomerang™ Work Surface	57
R2654. Freestanding Extended Boomerang™ Work Surface	59
R2655.	
R2720. Equipment Table	63
R3211. Cabinet, Pole Attached	67
R3221. Cabinet, Arm Attached	69
R3222.	
R3230. Cabinet Shelf	72
R3231. Cabinet File Frame	73
R3232. Cabinet Drawer	74
R3291. Back-to-Back Attachment Bracket, Cabinets	75
R3293. Pole Attachment Bracket, Cabinet	76
R3294. Arm Attachment Bracket, Cabinet	77
R3312. Ladder Shelf	79
R3320. Add-On Ladder Shelf	81
R3390. Ladder Shelf Divider	82
R3391. Back-to-Back Attachment Brackets, Ladder Shelves	83
R3610. Tool Rail	89
R3620. Swivel Tray Set	91
R6140. Support Arm Task Light	104
R6141.	
R6310. Pole Lamp	105
R6311.	
R7100. Flag	98
R7310. Pole Shelf	84
R7410. Picture Holder	99
R7411. Ledge	100
R7412. Document Holder	101
R7413. Mirror	102
R7414. Utility Hook	103
R7420. Coat Hook	93
R7421. Bud Vase	94
R7422. Signage	95
R7423. Flag Arm	97
R7424. Marker Board	96



20-Day or Less/Assigned Lead-Time Order Information

20-Day or Less and Assigned Lead-Time Programs

20-day or less and assigned lead-time products are designed for established Herman Miller dealers with pre-approved credit.

Products are distributed from multiple manufacturing facilities across the United States. All products and options not designated by an Assigned Lead-Time icon  will ship in 20 business days or less after being acknowledged by Herman Miller. Products and options designated by an  are on the assigned lead-time program and will ship in 20 days, less than 20 days, or more than 20 days from order acknowledgement.

Ordering Procedure

Please place orders through Order Manager. If this is not available to you, place orders through mail or fax. Verbal purchase orders will not be accepted.

Order Entry fax number for Passage®, 5000 Series, and Meridian® Filing and Storage: (616) 846 9236.

Order Entry fax number for all other products:
(616) 654 3085.

For more information, contact your Customer Care representative at:
(866) 854 3048 EXT 3400.

Shipments and Delivery

Per Herman Miller Terms and Conditions.

Changes and Cancellation

Per Herman Miller Terms and Conditions.



Keyed-Alike Information

Keyed-Alike Locks

All components with locks may be specified keyed alike. Products with keyed-alike locks will be shipped with lock chassis installed.

Installation of lock cylinders will be on-site according to instructions provided. Herman Miller, Inc., will not be responsible for lock cylinder installation.

When specifying product keyed-alike, include separate lines on your order for the lock cylinders.

For Action Office®, Ethospace®, Passage®, Quadrant®, Resolve®, and Supplemental products, list cylinder part number and key number (232092-XXX); select a key number (or numbers) between 226 and 427, excluding numbers 408 and 412.

The following products require a different lock cylinder part number. Specify UKY001-XXX for these products only; select a key number (or numbers) between 226 and 427, excluding numbers 408 and 412.

A3013.

A3053.

G5180.

G5181.

G5280.

The keys provided in 232092-XXX and UKY001-XXX kits work with either cylinder type, provided the key numbers match.

For Tu® Storage, Canvas Office Landscape®, 5000 Series, and Meridian® Storage, see the following charts.

Keyed-alike locks are field installed.

To order keyed-alike locks for Action Office® Series 1 and 2 door panels, please contact Customer Care.

A master key can be used to open any lock on an attached or freestanding component. In addition, a removal key or lock change tool is required to remove lock plugs. Customers interested in ordering master keys, removal keys, or lock change tools should contact Customer Care.

For Canvas overhead and lower storage units, specify as follows:

Specification Code	Part Number	Color	Lock Series
KA	1B2JK7-XXX ¹	chrome	UM series 226-427

For Canvas Metal Storage, Meridian Storage, Tu Storage, and 5000 Series desk components with pedestals, specify as follows:

Specification Code	Key Number	Color	Lock Series
KA	232092-XXX ¹	black	UM series 226-427
KA	1B2JK7-XXX ¹	chrome	UM series 226-427

For 5000 Series flipper door unit with bezel or credenza storage cabinet with bezel, specify as follows:

Specification Code	Key Number	Color	Lock Series
KA	232092-XXX ¹	black	UM series 226-427

Key Number:

XXX¹ = a key number between 226 and 427 (excluding 408 and 412)

Vary Easy Program

Program Overview

Vary Easy is a program designed to help dealers specify standard products with a larger breadth of options. For example, depending on the type of product being specified, choices include additional size, finish, edge types, and cable management features. Vary Easy 3D, specIT, and third-party text-based specification packages support the Vary Easy program. Vary Easy 3D enables designers to create a 3D image, CAD symbols, and a price book page. A Vary Easy product number is assigned for each product as the user selects specific options. Once the product is completely specified, the order can be submitted via Kiosk's Order Manager or a dealer's business system.

Accessing and Specifying Vary Easy

To view the full product vocabulary, go to the Vary Easy Product Offering on Kiosk. To specify Vary Easy, go to the Vary Easy 3D website on Kiosk, specIT, or your third-party text-based specification package.

Once you've made your product line selection, continue to follow through each option and enter the specific options that represent the product you need. When the product is fully specified, Vary Easy will generate an orderable product number and instantly calculate a price.

Note: Failure to completely specify a product will cause a delay in order acknowledgements. Be sure to make a selection for all options offered.

The acknowledgement process for Vary Easy products is the same as for any standard order. Vary Easy products ship with a standardized lead time and are competitively priced.

For more information, contact your Customer Care Line at (866) 854 3048 EXT 3400.

Fire Retardancy — Resolve® System

Fire Retardancy for Resolve Products

The products listed below, when covered with the textiles identified below, meet the Class A requirements for flame spread and smoke development as specified by the National Fire Protection Association (NFPA) in the 2009 Life Safety Code No. 101, and the Underwriters Laboratories requirements for use with energy distribution components (listed by UL under Office Furnishings 1286).

Product	Textile
Boundary Screen	Multiscrim™
	DOT® Collection
Display Screen	Bubbletack™

The fabrics listed below, when used on the products identified below, meet the Class A requirements for flame spread and smoke development as specified by the National Fire Protection Association (NFPA) in the 2009 Life Safety Code No. 101.

Product	Textile
Rolling Screen	Multiscrim and Scrim Trim
	DOT Collection
Canopy	Multiscrim and Scrim?Trim
	DOT Collection
Flag	Multiscrim
	DOT Collection

Stain-to-Match Program

Stain-to-Match Program

Program Overview

The Stain-to-Match program gives you the option of using veneer finishes that are not listed in the standard offering. The program allows Herman Miller to match a customer's existing recut or natural veneer, or create a new finish that is unique to an installation.

Specific information on approval, ordering, pricing, and warranty for the Stain-to-Match program is listed below. Questions and requests for assistance may be directed to Herman Miller Options at:
(800) 654 3910

Stain-to-Match Process

1. Fill out the Options Stain-to-Match Request Form and send along with a color sample (2" x 3" minimum) to the Herman Miller Options Applications Team at the address provided on the form. The form can be found on Omni.
2. Within 7-10 working days, Herman Miller Options will send a sample of the color-matched stain on Herman Miller veneer to the requester for the customer's signed approval.
3. If the sample meets the customer's approval, sign the reverse side of the sample, scan and email the approval to:
options@hermanmiller.com.
4. After the stain has been approved, a formal quotation with special number and pricing can be provided, or the product can be specified through the Vary Easy program, if available. Work with the Options team on final product needs and how to specify.
5. A purchase order can then be placed.

Stain-to-Match Warranty

Herman Miller warrants its products to be free from defects in craftsmanship from the date of delivery for the applicable warranty period. Herman Miller is responsible for the physical properties of the veneers available through the Stain-to-Match program, which include:

- STA: Stain-to-Match on Recut Ash
- STB: Stain-to-Match on Beech
- STC: Stain-to-Match on Cherry
- STD: Stain-to-Match on Oak
- STK: Stain-to-Match on Reltech Anigre (Geiger)
- STM: Stain-to-Match on Recut Mahogany
- STP: Stain-to-Match on Maple
- STU: Stain-to-Match on Walnut (Geiger)

See your specification tool for product specific finish offering limitations.

Customer's Own Material Order Information — Resolve® System

Customer's Own Material

Program Overview

The Customer's Own Material (COM) program gives you the option of using textiles other than those listed. Herman Miller will test textiles for application to Herman Miller products and will process orders for those with approved COM textiles only. COM textiles are on assigned lead times.

Omni lists an overview of fabrics that have been tested and indicates whether or not they were approved for application to Herman Miller products.

Specific information on the terms and conditions, testing, approval, and ordering process for COM is listed below. Questions about the COM program and requests for assistance may be directed to your COM representative at:

(616) 654 3400

(866) 854 3048 EXT 6543400

Customer's Own Material Warranty

Herman Miller does not warrant COM textiles. COM textiles are tested for application only; they are not tested for performance. The Herman Miller warranty does apply to the underlying products.

Suppliers of COM textiles are responsible for color consistency within commercial tolerances, UV stability, and resistance to soiling and perspiration.

Customer's Own Material Pricing

COM is a Category 1 fabric. There are no application charges for COM fabrics.

Ordering and payment for COM textile yardage are the responsibility of the customer and the textile supplier.

If desired, Herman Miller will purchase COM textiles directly from True Textiles, C.F. Stinson, Luna Textiles, Maharam, and Momentum Textiles to simplify ordering and shipment. For this service, refer to the Supplier Connection program.

Application Note

Herman Miller does not guarantee that Customer's Own Material (COM) fabric patterns will align across panels/tiles or from one screen to the next. We also do not guarantee that COM fabric designs will be positioned consistently in the same location across several panels, tiles, or screens.

COM Testing Guidelines

Herman Miller uses an automated process to cut the fabric for use on the Resolve® Boundary Screens (R1410.). To determine whether COM textiles will withstand this, we must subject them to the cutting process. In addition, since the design of the Resolve Boundary Screen is highly demanding with regard to the physical properties of the fabric used, the COM must pass our fabric qualification tests before it is approved. *Note: Within the Resolve product line, COM may be applied only to the Boundary Screens and flags.*

Test Prioritization, Response Time, and Capacity Limits

- pending orders will receive priority over general submittals for COM approval
- customers are to be notified of test results within 10 business days
- COM testing has a capacity of 10 fabrics per week; if the number of requests exceeds this capacity, lead time for notification of test results may be extended beyond the normal 10 business days

Test Sample Specifications

- sample must be a minimum of 14 yards of **machine rolled** fabric that represents the width and tension the fabric will have when coming directly from the manufacturer
- roll must have as little damage as possible: a damaged roll can increase the likelihood of a fabric not passing the testing process
- “telescoping”—the degree to which the fabric creeps down the roll, creating a telescope look—is not to exceed one half inch
- linear patterns (defined as a fabric that requires alignment across the screen) are not recommended and alignment of the pattern will not be guaranteed

Include with the Sample Roll

- 12-inch memo sample from the fabric supplier
- material content specifications for process safety reasons

Customer's Own Material Order Information — Resolve® System

continued

Fabric Parameters

The following known parameters automatically disqualify COM fabrics from use on Boundary Screens:

- vinyl content
- greater than 20 percent nylon content
- rayon and nylon blends
- greater than 10 percent wool content

Note: When combining standard Herman Miller Boundary Screens with COM Boundary Screens, it is suggested that the COM screens be placed back-to-back with another Resolve screen of the same size. This hides a one-sided fabric or a larger fold near the stitching. This isn't necessary when the back of the screen is hidden by architecture or other objects.

Textile Approval

1. Select a COM textile and a Herman Miller product.
2. If your textile is not listed in Omni, obtain a test number from a COM representative at (616) 654 3400 or (866) 854-3048 EXT 6543400. You can also submit your request within Omni. Please have the following information ready before calling: textile name, number, pattern, roll width, and the product you will apply it to.
3. Herman Miller will notify you of approval or disapproval within 10 business days from receipt of the test yardage.

Ordering Products with COM

1. Refer to the specific products to determine the yardage required for COM textiles.
2. If your textile is not listed in Omni, call a COM representative at (616) 654 3400 or (866) 854 3048 EXT 6543400. The representative will assign an identification number for your textile (ID#) and will verify yardage requirements for your order.
Note: Yardage requirements are based on nondirectional, 60"-wide textiles. See the boundary screen product information for yardage requirements for each height. 3 additional yards of textile are required per order when applying COM to boundary screens (required for lead-in material used in application process).
Example: When ordering 20 60"-high boundary screens with COM, order 30 yards COM + 3 additional yards = 33 yards COM for application on 20 boundary screens.
3. Enter your order on Order Manager in Omni.
4. Upon receipt of your purchase order, Herman Miller will send you a PO acknowledgment.
5. Arrangements must be made for the textiles to be shipped from the supplier to Herman Miller for application to the Herman Miller products. Textiles must be tagged with the assigned identification number and the roll yardage quantity. See Omni for shipping procedures and current shipping addresses or contact a COM representative at (616) 654 3400 or (866) 854-3048 EXT 6543400.

Products will be scheduled for production when COM textiles are received at Herman Miller. Standard lead times in effect at that time will apply.

Note: If textiles are to be purchased directly by Herman Miller through the Supplier Connection program, Herman Miller will handle the ordering and shipping process and will schedule your order for production upon receipt of your purchase order (dependent on textile availability). Refer to the Supplier Connection program for more information.

Customer's Own Material Order Information — Resolve® System

continued

Supplier Connection

Program Overview

The Supplier Connection program is a service offered by Herman Miller to purchase approved COM textiles directly from True Textiles, C.F. Stinson, Luna Textiles, Maharam, and Momentum Textiles. When you select a textile through this program, Herman Miller will facilitate the ordering, scheduling, and shipment of the textile directly with the supplier.

Suppliers included in the Supplier Connection program keep an active inventory of textiles that are pre-approved for application to Herman Miller products. Pre-approval applies only to the suitability of a textile for manufacturing and application to a Herman Miller product. Omni lists an overview of fabrics that have been tested and indicates whether or not they were approved for application to Herman Miller products.

Specific information on the terms and conditions, testing, approval, and ordering process for the Supplier Connection program is listed below. Questions and requests for assistance may be directed to your COM representative at:

(616) 654 3400

(866) 854 3048 EXT 6543400

Supplier Connection Warranty

Textiles purchased by Herman Miller through the Supplier Connection program are COM and are not warranted by Herman Miller. COM textiles are tested for application only; they are not tested for performance. The Herman Miller warranty does apply to the underlying products.

Suppliers of COM textiles are responsible for color consistency within commercial tolerances, UV stability, and resistance to soiling and perspiration.

Supplier Connection Pricing

Textiles purchased by Herman Miller through the Supplier Connection program are COM. COM is a Category 1 fabric. There are no application charges for COM fabrics.

Payment for textiles purchased by Herman Miller through the Supplier Connection program is the responsibility of the customer or dealer. Herman Miller will invoice the order at the supplier's prices published at the time of the order.

Textile Approval

1. Refer to Omni to identify the approval status of the textile. If your textile is not listed, contact the COM Department to request testing for application to Herman Miller products.
2. Herman Miller will notify you of approval or disapproval in approximately 10 days from receipt of the test yardage. If the textile is approved, it will be assigned a COM identification number.

Ordering Products with Supplier Connection COM

1. Identify and include the following information on your purchase order:
 - Product number and option
 - Herman Miller's COM identification number
2. Enter your order on Order Manager in Omni.
3. Upon receipt of the purchase order, Herman Miller will process your order and send you a PO acknowledgment. Herman Miller will determine the yardage required to produce your product and will order and schedule for delivery the required textile. Standard lead times in effect at the time the textile is allocated at the supplier will apply to products ordered through this program.



Design on Textile (DOT™) and Customer's Own Image (COI) Order Information

Design on Textile and Customer's Own Image

Program Overview

The Design on Textile (DOT) program gives you the option of selecting unique images from various designers and having the images digitally printed on a textile, or creating new designs through Customer's Own Image (COI). The program is available for Resolve® components only: boundary screens, rolling screens, canopies, and flags. Herman Miller will process orders only for images within the DOT Collection.

A complete documentation of the collection images and examples of COI design applications is available through your Herman Miller dealer or salesperson, the DOT brochure, HermanMiller.com, or Kiosk. The DOT Collection in the appendices has a list of images, their order numbers, and specification notes.

Specific information on the terms and conditions, warranties, and order processes for DOT is listed below.

Textile

The textile is 100% polyester. The base fabric color is white. Canopy and rolling screen products have a pearl grey (8C02) edge banding. Images are not applied to Resolve standard-colored fabrics.

Warranty

Herman Miller warrants the base textile for a period of one year. DOT textiles are not warranted for color consistency. Consistency will be maintained within commercial tolerance, UV stability, and resistance to soiling.

Visual color range is determined by multiple factors including lighting, application process, and image files.

Application Note

Herman Miller does not guarantee that images will be positioned the same across multiple screens, canopies, or flags. We also do not guarantee that patterns will align from one boundary screen to the next.

Material Pricing

DOT is a Category 1 fabric. COI has an upcharge. Pricing of DOT Resolve products and COI upcharges are listed with each product.

Customer's Own Images (COI)

For COI information, contact the Herman Miller COM Department at (866) 854 3048 ext 6543400. COI design specifications and ordering information can be found on HermanMiller.com or Kiosk. Orders are processed through Vary Easy. See Vary Easy Program in Appendices.



Design on Textile (DOT™) Collection

Price Category 1

Boundary Screen DOT - Nature Collection	
100% polyester	
9GA1	Field Caramel
9GA2	Field Kiwi
9GA3	Field Blue
9GA4	Field Bronze
9GAY	Field Warm
9GAZ	Field Cool
9GA0	Water Blue
9GA5	Water Warm
9GA6	Water Cool
9GA7	Water Caramel
9GA8	Water Olive
9GA9	Water Spa
9GAA	Shadow Warm
9GAB	Shadow Cool
9GAC	Shadow Caramel
9GAD	Shadow Kiwi
9GAE	Shadow Spa
9GAF	Shadow Blue
9GAG	Shadow Purple
9GAH	Stems Warm
9GAJ	Stems Cool
9GAK	Stems Olive
9GAL	Stems Spa
9GAM	Stems Blue
9GAN	Sea Plant White
9GAP	Sea Plant Warm
9GAR	Sea Plant Cool
9GAS	Sea Plant Caramel
9GAT	Sea Plant Olive
9GAU	Sea Plant Spa
9GAV	Sea Plant Blue

9GAW	Sea Plant Purple
9GAX	Sea Plant Bronze
9GB1	Branch Warm Left
9GB2	Branch Warm Right
9GB3	Branch Cool Left
9GB4	Branch Cool Right
9GB5	Branch Kiwi Left
9GB6	Branch Kiwi Right
9GB7	Branch Spa Left
9GB8	Branch Spa Right
9GBA	Strawflower Warm
9GBB	Strawflower Cool
9GBC	Seascape Warm Left
9GBD	Seascape Warm Right
9GBE	Seascape Cool Left
9GBF	Seascape Cool Right
9GBG	Fossil Warm
9GBH	Fossil Cool
9GBJ	Fossil Caramel
9GBK	Fossil Kiwi
9GBL	Fossil Spa
9GBM	Fossil Blue
9GBN	Fossil Bronze
9GBP	Canal Warm Left
9GBR	Canal Warm Right
9GBS	Canal Cool Left
9GBT	Canal Cool Right
9GBU	Canal Blue Left
9GBV	Canal Blue Right
9GBW	Trees Warm Left
9GBX	Trees Warm Right
9GBY	Trees Cool Left
9GBZ	Trees Cool Right

Boundary Screen DOT	
100% polyester	
9GB0	Girard International Love Heart
9GB9	Girard Daisy Face
9GCA	Girard Old Sun
9GCB	Girard Palace
9GCC	Girard Black & White
9GDA	Ocean Series A
9GDB	Ocean Series B
9GDC	Ocean Series C
9GDD	Ocean Series D
9GDE	Ocean Series E
9GDF	Waterlines Series F
9GDG	Waterlines Series G
9GDH	Waterlines Series H
9GDJ	Reflections Series J
9GDK	Reflections Series K
9GDM	Reflections Series M
9GDP	Reflections Series P
9GE1	Orange Series 1
9GE2	Orange Series 2
9GE3	Orange Series 3
9GEA	Waffle Series A
9GEB	Waffle Series B
9GEC	Waffle Series C
9GH1	Red Sherbet 1
9GH2	Green Sherbet 2
9GH3	Blue Sherbet 3
9GHA	Green Swirl A
9GHB	Red Swirl B
9GHC	Blue Swirl C
9GHD	Suds D
9GHE	Hexagons E
9GHF	Seedburst F
9GHG	Pond View G
9GHH	Refractions H

9GHJ	Fronds J
9GHK	Dandelion K
9GHM	Pods M
9GHR	Workday 1 R
9GHS	Workday 2 S
9GHT	Workday 3 T
9GHU	Tulips U
9GHV	E-Smile V
9GHW	Brackets W
9GHX	Asterisk X
9GHZ	Address Z
9GJ1	Mosaic Series 1
9GJ2	Mosaic Series 2
9GJ3	Mosaic Series 3
9GJ4	Mosaic Series 4
9GJ5	Mosaic Series 5
9GJ6	Mosaic Series 6
9GJ7	Mosaic Series 7
9GJA	Dunes Series A
9GJB	Dunes Series B
9GJC	Dunes Series C
9GJD	Dunes Series D
9GJE	Dunes Series E
9GJF	Dunes Series F
9GJG	Dunes Series G
9GJH	Dunes Series H
9GJJ	Dunes Series J
9GJK	Dunes Series K
9GJM	Dunes Series M
9GM1	Peering Series 1
9GM2	Peering Series 2
9GM3	Peering Series 3
9GMA	Hatch Series A
9GMB	Hatch Series B
9GMC	Hatch Series C
9GMD	Hatch Series D
9GME	Hatch Series E
9GMF	Hatch Series F
9GMG	Hatch Series G
9GMH	Hatch Series H
9GMJ	Hatch Series J
9GMK	Hatch Series K

Design on Textile (DOT™)Collection

continued

Price Category 1

continued

Canopy DOT	
100% polyester	
9JDA	Waterlines Series A
9JDB	Reflections Series B
9JE1	Orange Series 1
9JEA	Waffle Series A
9JEB	Waffle Series B
9JH1	Day Sky 1
9JH2	Petals 2
9JH3	Green Sherbet 3
9JH4	Blue Sherbet 4
9JH5	Red Sherbet 5
9JJ1	Mosaic Series 1
9JJ2	Mosaic Series 2
9JJ3	Mosaic Series 3
9JJA	Dunes Series A
9JM1	Peering Series 1
9JMA	Hatch Series A
9JMB	Hatch Series B

Flag DOT	
100% polyester	
9KB0	Girard International Love Heart
9KB9	Girard Daisy Face
9KCA	Girard Old Sun
9KCB	Girard Palace
9KCC	Girard Black & White
9KDA	Waterlines Series A
9KDB	Reflections Series B
9KE1	Orange Series 1
9KE2	Orange Series 2
9KEA	Waffle Series A
9KH1	N-Scape 1
9KH2	S-Scape 2
9KH3	E-Scape 3
9KH4	W-Scape 4
9KJ1	Mosaic Series 1
9KJ2	Mosaic Series 2
9KJA	Dunes Series A
9KM1	Peering Series 1
9KMA	Hatch Series A
9KMB	Hatch Series B

Rolling Screen DOT	
100% polyester	
9HDA	Reflections Series A
9HDB	Waterlines Series B
9HE1	Orange Series 1
9HE2	Orange Series 2
9HEA	Waffle Series A
9HEB	Waffle Series B
9HH1	Blue Sherbet 1
9HH2	Green Sherbet 2
9HH3	Red Sherbet 3
9HJ1	Mosaic Series 1
9HJ2	Mosaic Series 2
9HJA	Dunes Series A
9HM1	Peering Series 1
9HMA	Hatch Series A
9HMB	Hatch Series B

Notes regarding DOT images:

- To view DOT images and cropping guides, see the DOT brochure or HermanMiller.com.
- 69" x 60" screens will display the full DOT image. Smaller screens, canopies, and flags will display a percentage of the full image based on the size chosen. The cropped versions retain the essence of the full image for most applications, but images should be reviewed in their specified size to assure customers are satisfied.
- All images are cropped from the center/bottom except those noted:
 - 9GHR, 9GHS, and 9GHT have the bottom gray ban removed and are cropped from the center/top.
 - 9GMH is cropped from the center/top.
 - 9GJG is cropped from the upper/left.
 - 9GJH is cropped from the lower/left.
 - 9GJK is cropped from the lower/right.
 - 9GJM is cropped from the upper/right.
- DOT name and images are protected under trademark and copyright laws.
- Copyright in the artwork presented is owned by Herman Miller, Inc., and/or the artist/photographer or other copyright owner. All rights reserved.

Proprietary Textiles Application Chart – Workspaces

• Available

A Assigned lead-time textile.

See page 3 for exception notes.

Price Category 1																																
COM	Customer's Own Material	A	1	1	1	1	1		1	1	1	1		•	1	1	1		1		1	1	1					1	1		3	1
8A__	Bubbletack™																															
2V__	Chain		•	•	•	•	•		•	22	•	•		•	•	•	•		•		•	•						•		•	3	
8T__	Crossing (85__)		2	2	2	•	•		•	•	2	•		•	•	•	•	•	•	•	•	•				•	8	•		•	3	18
95__	Gem		2	2	2	•	•		•	•	2	•		•	•	•												•	•	•	3	•
2I__	Grasscloth		•	•	•	•	•		•	•	•	•		•	•	•	•	•	•	•	•							•	•	•	3	
1MN__	Monologue		2	2	2	•	•		•	•	2	•		•	•	•	•	•	•	•	•							•	•	•		•
8B__	Multiscrim™							•															•		•			•	•	•		
5T__	Resonance		•	•	•	•	•		•	•	•	•		•	•	•												•	•	•		
8C__	Scrim Trim																									•						
22W__	Shade												•																			
2M__	Silkworm		•	•	•	•	•		•	•	•	•		•	•	•												•	•	•	3	
22F__	Slant		6		•		•		•	•		•		•	•	•												•		•	3	
235__	Tailored	A		•	•		•	•		•	•	•		•	•	•												•		•		•
1WS__	Whisper		2	2	2	•	•		•	•	2	•		•	•	•	•	•	•	•	•	•						•	•			•
Price Category 2																																
1CD__	Code		•	•	•	•	•		•	•	•	•		•	•	•											•		•			
3P__	ColorGuard			2		•								•	•	•																•
51__	Cord		•	•	•	•	•		•	•	•	•		•	•	•											•		•	3		
92__	Crepe		2	•	•	•	•		•	•	•	•		•	•	•			•							•	8	•	•		3	•
22Q__	Fish Net			2	2	•	•		•	•	2	•			•				•			•										•
57__	Frost		•	•	•	•	•		•	•	•	•		•	•	•	•		•		•	•						•	•	•	3	
84__	Grosgrain		4	•	•	•	•		•	•	•	•			•	19												•	19	•	3	
4N__	Horizon		2	2	2	•	•		•	•	•	•		•	•	•												•	•	•	3	
1LM__	Loom		2	2	2	•	•		•	•	•			•	•	•	•		•		•	•				•		•				•
1HA__	Medley		2	2	2	•	•		•	•	•	•		•	•	•	•	•	•	•	•				•	8	•	•				•
3A__	Moiré			2	2	•	•		•	22	2	•		•	•	•	•		•		•	•							•	3	•	
1RV__	Rivet		2	2	2	•	•		•	•	2	•		•		•		•		•	•								•	•		•
43__	Tape								•	•	•	•		•		•														•		
8R__	Twist (5S__)		5	2	2	•	•		•	•	2	•		•	•	•	•	•	•	•	•							•	•	•	3	18
22T__	Well Suited			2		•	•		•	2	•																					•
Price Category 3																																
70__	Bento		2	2	2	•			•	2	•		•		•	•	•		•		•	•						•		•	3	•
1FB__	Connection		•	•	•	•	•		•	•	•	•		•	•	•	•			•								•	•	•	3	
1FC__	Current		•	•	•	•	•		•	•	•	•		•	•	•	•			•								•	•	•	3	
8Z__	Glaze		•	•	•	•	•		•	•	•	•		•	•	•												•	•	•	3	
47__	Ground Cloth®		•	•	•	•	•		•	•	•	•		•	•	•	•		•		•	•	14			•	8	•	•	•	3	
5D__	Kira 2		2	2	2	•	•		•	•	2	•		•	•	•	•		•		•	•	14					•	•	•	3	
22R__	Pins and Needles		2	2		•	•		•	•	2	•		•	•	•												•				•
8L__	Savannah		•	20	•	•	•		•	•	•	•		•	•	•							14						•			
8U__	Stitches (5Z__)		2	2	2	•			•	2	•			•	•													•		•	3	18
8W__	Strands		•	•	•	•	•		•	•	•	•		•	•	•	•		•		•	•						•	•	•	3	
22V__	String Plaid		2	2	2	•	•		•	•	2	•		•	•	•	•		•		•	•	•					•				

continued on next page

Proprietary Textiles Application Chart – Workspaces

continued

Proprietary Textiles Application Chart — Workspaces																															
<i>continued</i>																															
	Action Office® Panels/Connectors	Action Office/Ethospace® B-Style Storage	Action Office B-Style Tackboards	Action Office/Ethospace E-Style Storage	Ethospace Tiles/Connectors	Ethospace Work Surface-Attached Screens	Ethospace/Canvas Office Landscape® Privacy Doors	Canvas Tiles/Extended Width Tiles	Canvas B-/E-Style Storage	Canvas Standing Screen and Team Wall Infill	Canvas Signature Screen	Canvas Tackboards	Layout Studio® Framed Screen	Locale® Display Tackboard	Locale Freestanding Screen and Workbase Screen	Locale L-Desk/D-Desk Screens	Pari™ Screens	Prospect™ Exterior Acoustic Pad	Public Office Landscape® Screen/Desk Top Divider	Renew™ Link Screens	Resolve® Boundary Screens/Flags	Resolve Display Screens	Resolve Rolling Screens/Canopies	Exclave® Tackable Boards and Stowage Tackable Backdrop	Exclave Video-Friendly Tackable Boards and Stowage Tackable Backdrop	Intersect® Screens	Thrive® Personal Side Screen	Tu® Wood Storage Cubby Tackboard	5000 Series Storage and Tackboards	Seating	
Price Category 4																															
2X__ Glisten	•	•	•	•	•		•	•	•	•		•	•	•						•						•		•	•		
22L__ Loft A		2	2	•	•		•	•	2	•		•	•	•	•	•	•	•	•	•				•	8		•	•	•	•	
6S__ Quilty	2	2	2	•	•		•	•	2				•	•												•	•	•		3	•
63__ Sironetta	•	•	•	•	•		•	•	•	•		•	•	•	•		•		•	•						•	•	•	•	3	
Price Category 5																															
14A__ Hopsak	2	2	2	•	•		•	2	•			•	•	•										•		•		•		•	
Price Category 6																															
No fabrics available at this time.																															

- 1 Refer to price book appendices and Omni for COM information.
- 2 Available on all products except 54" and 60" wide.
- 3 Fabric is railroaded for all widths.
- 4 Not available on Action Office (AO®) acoustical panels.
- 5 (8R__), (8T__), (85__), and (5S__) not available on AO acoustical panels and not available on 54"- or 60"-wide products.
- 6 Not available on Action Office (AO®) connectors, cable management, and spacers.
- 8 Available in select colors. See the "Proprietary Textile Colors – Workspaces" appendix.
- 14 Not available on Resolve flags.
- 18 Available on seating products in select colors. See the "Proprietary Textile Colors – Seating" appendix.
- 19 Not available in Grosgrain (84__) fabric colors 8401, 8405, and 8413.
- 20 Available only on Ethospace B-Style.
- 22 Not available as railroaded application option for Chain (2Voo) and Moiré (3Aoo) on Canvas Extended Width Tiles.
- 24 Not available on Ethospace cable access tile, cable channel tile, or beltline face tile.

Application Note: Herman Miller cannot guarantee material/pattern alignment in adjacent products. For example, a fabric's pattern may not align from one screen to the next, or from one panel to the next.

Proprietary Textile Colors – Workspaces

Price Category 1

Customer's Own Material
See Order Information in
Appendices.
Assigned lead-time textile. 

Bubbletack™
100% polyester

8A01	Seashell White
8A02	Pearl Grey
8A05	Dune Beige
8A07	Pebble Beige
8A09	Olive Green
8A13	Slate Purple
8A19	Spa Blue
8A24	Sable Grey
8A27	Summer White
8A28	Moth Grey
8A29	Tea Leaf Grey
8A30	Blue Grey
8A31	Dusty Bronze
8A32	Slate Blue
8A33	Caramel Beige
8A34	Kiwi Green

Chain
66" wide
100% recycled polyester

2V01	Pearl
2V02	Oyster
2V03	Wheat
2V04	Linen
2V05	Wicker
2V06	Bamboo
2V07	Sage
2V08	Spring Wood
2V09	Iceberg

Crossing
54" wide
86% antimony-free polyester
14% polyester

8T03	Wicker *
8T04	Porcelain *
8T05	Warm Grey *
8T06	Sepia
8T07	Pumpkin
8T08	Copper
8T09	Cranberry
8T10	Tomato
8T11	Mulberry
8T12	Plum
8T13	Green Apple
8T14	Loden
8T15	Spruce
8T16	Periwinkle
8T17	Cerulean
8T18	Indigo
8T19	Shale *
8T20	Brownstone
8T21	Bark
8T22	Tin *
8T23	Graphite
8T24	Black

Crossing
For workspaces products only.
54" wide
86% antimony-free polyester
14% polyester

8501	Ivory *
8502	Oyster *

* Colors available on Exclave®
Video-friendly Tackable Boards
and Stowage Tackable Backdrop

Gem
54" wide
100% antimony-free polyester

9501	Sesame
9502	Tangerine
9503	Red
9504	Red Violet
9505	Mulberry
9506	Java
9507	Twilight
9508	Bayou
9509	Iris
9510	Berry Blue
9511	Aqua Green
9512	Green Apple
9513	Spruce
9514	Black
9515	Slate Grey
9516	Fog

Grasscloth
66" wide
100% recycled polyester

2I01	Silver Birch
2I02	Pampas
2I03	Sedge
2I07	Lea
2I08	Taro
2I09	Steam Grey
2I10	Cayenne
2I11	Bottle Green
2I12	Surf
2I13	Gravel

Monologue
54" wide
56% recycled polyester
44% polyester

1MN01	Linen
1MN02	Alabaster
1MN03	Truffle
1MN04	Folkstone
1MN05	Silver Pine
1MN06	Slate
1MN07	Seed
1MN08	Yellow Oxide
1MN09	Persimmon
1MN10	Tundra
1MN11	Meadow
1MN12	Blue Sky
1MN13	Blue Spruce
1MN14	Deep Sea

Multiscrim™
60" wide
100% polyester

8B01	Seashell White
8B02	Pearl Grey
8B05	Dune Beige
8B07	Pebble Beige
8B09	Olive Green
8B15	Slate Purple
8B19	Spa Blue
8B24	Sable Grey
8B27	Summer White
8B28	Moth Grey
8B29	Tea Leaf Grey
8B30	Blue Grey
8B31	Dusty Bronze
8B32	Slate Blue
8B33	Caramel Beige
8B34	Kiwi Green

Proprietary Textile Colors – Workspaces

continued

Price Category 1

continued

Resonance

66" wide
100% polyester
5T04 Greige
5T05 Porcelain
5T06 Alabaster
5T15 Iris
5T28 Sugar
5T47 Tobacco
5T54 Saltbush
5T57 Seed
5T58 Sepia
5T59 Tundra
5T60 Iceberg
5T61 Black
5T62 Chamois
5T63 Citrus
5T64 Tangerine
5T65 Red
5T66 Wild Berry
5T67 Boysenberry
5T68 Pistachio
5T69 Green Apple
5T70 Forest
5T71 Jade
5T72 Blue Green
5T73 Bright Turquoise
5T74 Twilight

Scrim Trim

61" wide
82% polyester
18% spandex
8C01 Seashell White
8C02 Pearl Grey
8C22 Winter Grey
8C24 Sable Grey

Shade

91% polypropylene
9% polyester
22W02 Tin
22W03 Graphite

Silkworm

66" wide
58% recycled polyester
42% polyester
2M01 Cocoon
2M02 Pongee
2M03 Saffron
2M04 Tussah
2M05 Ceylon
2M06 Jasmine
2M07 Shale
2M08 Monsoon

Slant

66" wide
51% polyester
49% recycled polyester
22F01 Beech Nut
22F02 Chamois
22F03 Chartreuse
22F04 Pesto
22F05 Peacock
22F06 Neptune
22F07 Blueberry
22F08 Boysenberry
22F09 Magenta
22F10 Pumpkin
22F11 Cranberry
22F12 Silver Birch
22F13 Bluestone
22F14 Truffle
22F15 Shale

Tailored

Assigned lead-time textile. ^A
54" wide
56% polyester
44% recycled polyester
23501 Studio White
23502 Sugar
23503 Tomato
23504 Orchid
23505 Boysenberry
23506 Chive
23507 Bluegrass
23508 Cobalt
23509 Cadet
23510 Fog
23511 Graphite
23512 Black
23513 Coffee

Whisper

54" wide
73% recycled polyester
27% polyester
1WS01 Sand Dollar
1WS02 Pebble
1WS03 Silver Birch
1WS04 Iceberg
1WS05 Silver Pine
1WS06 Carbon
1WS07 Cumin
1WS08 Adobe
1WS09 Strawberry
1WS10 Blush
1WS11 Eggplant
1WS12 Willow
1WS13 Sea Grass
1WS14 Pool
1WS15 Blueberry

Price Category 2

Code

66" wide
100% Repreve recycled polyester
1CD01 Linen
1CD02 Khaki
1CD03 Iceberg
1CD04 Zinc
1CD05 Blue Black

ColorGuard

54" wide
100% vinyl
3P01 Grey
3P02 Navy
3P03 Spruce ^A
3P04 Jade ^A
3P05 Natural ^A
3P08 Blueberry ^A
3P09 Coal ^A
3P12 Black Plum ^A
3P14 Black
3P15 New Burgundy ^A
3P17 Burgundy ^A
3P19 Slate
3P31 Horizon Blue ^A
3P33 Pumice
3P54 Candy Apple ^A
3P58 Beige ^A
3P66 Deep Clay ^A
3P72 Allspice ^A
3P90 Green Tea ^A
3P93 Camelback ^A
3P96 Manzanita ^A
3P97 Fudge ^A
3PB2 Sea Grass ^A
3PB5 Vizcaya Palm ^A
3PB9 Neptune ^A
3PC7 Bucksuede ^A
3PD4 Otter ^A

^A Assigned lead-time color.

Proprietary Textile Colors – Workspaces

continued

Price Category 2

continued

Cord

66" wide
51% antimony-free polyester
49% polyester
5101 Ivory
5102 White Ash
5103 Linen
5104 Bamboo
5105 Sepia
5106 Wicker
5107 Sesame
5108 Kiwi Green
5109 Bayou
5110 Shade
5111 Spring Wood
5112 Summer White

Crepe

54" wide
100% recycled polyester
9201 Licorice
9203 Smoke
9207 Cherry
9209 Claret
9212 Raisin
9218 Aquamarine
9223 Cadet
9241 Beachglass
9243 Midnight
9244 Artichoke
9248 Warm White *
9249 Stone *
9250 Earth
9251 Fog *
9252 Slate Grey
9253 Yellow Dark
9254 Coral
9255 Blush Grey *
9256 Wild Berry
9257 Clover
9258 Caribbean
9259 Cerulean
9260 Brownstone

* Colors available on Exclave®
Video-friendly Tackable Boards
and Stowage Tackable Backdrop

Crepe continued

9261 Shale
9262 Graphite
9263 Tomato
9264 Green Apple

Fish Net

55" wide
100% recycled polyester
22Q01 Oyster
22Q02 Stone
22Q03 Citrus
22Q04 Curry
22Q05 Chipotle
22Q06 Cherry
22Q07 Fuschia
22Q08 Claret
22Q09 Purple
22Q10 Clover
22Q11 Pesto
22Q12 Peacock
22Q13 Lagoon
22Q14 Twilight
22Q15 Bluestone
22Q16 Storm
22Q17 Black
22Q18 Cocoa

Frost

66" wide
100% recycled polyester
5701 Bisque
5702 Abalone
5703 Porcelain
5704 Honey
5705 Iceberg
5706 Sage
5707 Reed
5708 Steam Grey
5709 Gunmetal
5710 Sable Grey

Grosgrain

66" wide
100% recycled polyester
8401 Pearl *
8402 White Ash
8403 Warm Grey
8404 Khaki
8405 Oyster *
8406 Celadon
8408 Spa Blue
8409 Bud
8410 Kiwi Green
8411 Bayou
8412 Tin
8413 Iceberg *

* Colors not available on Canvas
Dock Mounted Screens, Locale®
Workbase Screen, Public Office
Landscape® Screen/Desk Top
Divider, and Thrive® Personal
Side Screen.

Horizon

54" wide
65% antimony-free polyester
35% polyester
4N01 Rye Grass
4N02 Sugar Pine
4N03 Silver Pine
4N04 White Ash
4N05 Spring Wood
4N06 Tamarack
4N07 Mushroom
4N08 Haystack
4N09 Oat Grass
4N10 Forest Moss
4N11 Hickory
4N12 Beech Nut
4N13 Pine Cone
4N14 Poplar
4N15 Elderberry

Loom

54" wide
100% polyester
1LM01 Linen
1LM02 Brown Sugar and Spice
1LM03 Brick and Mortar
1LM04 Salt and Pepper
1LM05 Black
1LM06 Lemongrass
1LM07 Poppy
1LM08 Wild Berry
1LM09 Loden
1LM10 Jade
1LM11 Deep Sea

Medley

54" wide
100% polyester
1HA01 Stone *
1HA02 Trail
1HA03 Charcoal
1HA04 Cinder
1HA05 Citrus
1HA06 Papaya
1HA07 Chutney
1HA08 Tundra
1HA09 Feather Grey *
1HA10 Chartreuse
1HA11 Loden
1HA12 Peacock
1HA13 Bayou *
1HA14 Blue Grotto
1HA15 Blueberry
1HA22 Khaki
1HA23 Pewter
1HA24 Yellow Oxide
1HA25 Vintage Rose
1HA26 Raspberry
1HA27 Acai Berry

* Colors available on Exclave®
Video-friendly Tackable Boards
and Stowage Tackable Backdrop

Proprietary Textile Colors – Workspaces

continued

Price Category 2

continued

Moiré	
54" wide	
100% recycled polyester	
3A01	Concrete
3A02	Biscotti
3A03	Rattan
3A04	Chambray
3A05	Fern
3A08	Violet
3A09	Zin
3A10	Curry
3A11	Spice
3A12	Cork

Rivet	
54" wide	
100% recycled polyester	
1RV01	Twig
1RV02	Deep Clay
1RV03	Woodrose
1RV04	Otter
1RV05	Hemlock
1RV06	Olive
1RV07	Lagoon
1RV08	Deep Sea
1RV09	Charcoal
1RV10	Grey Brindle

Tape	
66" wide	
52% polypropylene	
48% recycled polyester	
4301	Pearl
4302	Oyster
4303	Wicker
4304	Reed
4305	Straw
4306	Celadon
4307	Alabaster
4308	Bamboo
4309	Feather Grey
4310	Iceberg

Twist	
54" wide	
80% antimony-free polyester	
13% recycled polyester	
7% polyester	
8R05	Wicker
8R10	Poppy
8R14	Tin
8R15	Shale
8R16	Graphite
8R17	Birch
8R18	Sepia
8R22	Blueberry
8R23	Green Apple
8R26	Gunmetal
8R27	Cinder
8R28	Citrus
8R29	Pekoe
8R30	Tangerine
8R31	Red Plum
8R32	Wisteria
8R33	Forest
8R34	Jade Dark
8R35	Waterfall
8R36	Midnight Blue
8R37	Carbon Dark

Twist	
For workspaces products only.	
54" wide	
80% antimony-free polyester	
13% recycled polyester	
7% polyester	
5S01	Pearl
5S02	Ivory
5S03	Oyster

Well Suited	
55" wide	
79% polyester	
21% recycled polyester	
22T01	Oyster
22T02	Raffia
22T03	Peppermint
22T04	Wild Berry
22T05	Spring Green
22T06	Mint
22T07	Periwinkle
22T08	Cool Grey
22T09	Citrus
22T10	Pumpkin
22T11	Red
22T12	Fuschia
22T13	Orchid
22T14	Chartreuse
22T15	Green Apple
22T16	Jade
22T17	Peacock
22T18	Blueberry
22T19	Bluestone
22T20	Mink

Price Category 3

Bento	
54" wide	
100% antimony-free polyester	
7001	Frost
7002	Linen
7003	Khaki
7004	Truffle
7005	Grey Black
7006	Pumpkin
7007	Cranberry
7008	Everglade
7009	Cobalt

Connection	
66" wide	
100% antimony-free polyester	
1FB1	Oyster
1FB2	Linen
1FB3	Iceberg
1FB4	Silver Pine
1FB5	Apricot
1FB6	Cumin
1FB7	Green Apple
1FB8	Slate Blue
1FB9	Metal

Proprietary Textile Colors – Workspaces

continued

Price Category 3

continued

Current	
66" wide	
100% antimony-free polyester	
1FC1	Oyster
1FC2	Linen
1FC3	Iceberg
1FC4	Silver Pine
1FC5	Apricot
1FC6	Cumin
1FC7	Green Apple
1FC8	Slate Blue
1FC9	Metal

Glaze	
66" wide	
100% recycled polyester	
8Z01	Wicker
8Z02	Honey
8Z03	Porcelain
8Z04	Celadon
8Z06	Rye
8Z07	Frost
8Z08	Silver Birch

Ground Cloth®	
66" wide	
100% polyester	
4701	Vapor Grey
4721	Warm White *
4722	Fog *
4723	Straw *
4724	Red Orange *
4725	Wild Berry *
4726	Green Apple *
4727	Caribbean *
4728	Midnight *
4729	Cappuccino *

* Colors available on Exclave®
Video-friendly Tackable Boards
and Stowage Tackable Backdrop

Kira 2	
54" wide	
100% recycled polyester	
5D11	Flaxen
5D12	Papyrus
5D13	Oasis
5D14	Incense
5D15	Ash
5D16	Falcon

Pins and Needles	
58" wide	
76% recycled polyester	
24% polyester	
22R01	Day and Night
22R02	Night and Day

Savannah	
66" wide	
76% recycled polyester	
24% polypropylene	
8L01	Pearl
8L02	Oyster
8L03	Wheat
8L04	Jute
8L05	Bamboo
8L06	Metal
8L07	Linen
8L08	Celadon
8L09	Moss
8L10	Frost
8L11	Shale
8L12	Pewter

Stitches	
54" wide	
54% polyester	
46% recycled polyester	
8U02	Rye
8U03	Khaki
8U04	Honey
8U05	Cattail
8U06	Pumpkin
8U07	Brick
8U08	Cool Grey
8U09	Slate Blue
8U10	Juniper
8U11	Evening Blue
8U12	Charcoal
8U13	Kiwi Green
8U14	Olive
8U15	Pesto
8U16	Cocoa
8U17	Seed

Stitches	
For workspaces products only.	
54" wide	
54% polyester	
46% recycled polyester	
5Z01	White Ash

Strands	
66" wide	
100% recycled polyester	
8W01	Pebble
8W02	Porcelain
8W03	Taupe
8W04	Honey
8W05	Khaki
8W06	Rye
8W07	Wicker
8W08	Tin
8W09	Cool Grey

String Plaid	
54" wide	
100% recycled polyester	
22V01	Warm White on Khaki
22V02	Mint on Yellow Green
22V03	Mist on Blue Grey
22V04	Sky Blue on Red
22V05	Lime on Magenta
22V06	Bright Green on Green
22V07	Aqua Blue on Cerulean
22V08	Ivory on Black

Proprietary Textile Colors – Workspaces

continued

Price Category 4

Glisten	
66" wide	
84% polyester	
16% recycled polyester	
2X02 Rye	
2X05 Iceberg	
2X09 Pewter	
2X10 Ash	
Loft	
Assigned lead-time textile. A	
54" wide	
100% wool	
22L01	Heathered Light Green
22L02	Heathered Dark Green
22L03	Heathered Turquoise
22L04	Heathered Navy
22L05	Heathered Orange
22L06	Heathered Red
22L07	Heathered Tan *
22L08	Heathered Grey *
22L09	Heathered Blue *
22L10	Heathered Brown
22L11	Heathered Dark Grey
22L12	Heathered Denim

* Colors available on Exclave®
Video-friendly Tackable Boards
and Stowage Tackable Backdrop

Quilty	
56" wide	
100% antimony-free polyester	
GreenShield	
6S03 Khaki	
6S04 Straw	
6S07 Brick	
6S10 Mink	
6S11 Green Apple	
6S13 Indigo	
6S14 Zinc	
6S15 Slate	
6S16 Beachwood	
6S17 Paprika	
6S18 Plum	
6S19 Juniper	
6S20 Grey Black	

Sironetta	
66" wide	
100% recycled polyester	
6301 Acapella	
6302 Sonata	
6303 Interlude	
6304 Legato	
6308 Harmony	
6309 Ensemble	

Price Category 5

Hopsak	
56" wide	
100% recycled polyester	
14A20	Black
14A22	Raw Umber Dark
14A26	Grey Blue Dark
14A30	Sepia Dark
14A38	Emerald Dark
14A39	Yellow Dark
14A40	Orange
14A41	Sienna
14A42	Olive Green Dark
14A43	Crimson
14A44	Crimson Dark Dark
14A45	Violet Dark
14A46	Pink Dark Dark
14A47	Ultramarine Dark
14A48	Cobalt Blue
14A49	Terra Cotta
14A50	Ochre Dark

For more information about our products and services or to see a list of dealers, please visit us at HermanMiller.com or call (800) 851 1196.

© 2018 Herman Miller, Inc., Zeeland, Michigan

® **HermanMiller**, 3D Intelligent, AO, Action Office, Aeron, ArcSpan, Aside, Avall, Avive, Bubble Lamps, Canvas Office Landscape, Caper, Celle, Co/Struc, Daisiyone, Distil, Eames, Eco-Dematerialized, Embody, Envelop, Equa 2, Ergon 3, Ethospace, Exclave, Fine-Tune, FlexFront, Flo, Formcoat, Formwork, Ground Cloth, Herman Miller for the Home, Herman Miller for Healthcare, Intersect, Kinemat, Lapjack, Layout Studio, Lifework, Limerick, Live Unframed, Living Office, Locale, Maharam, Meridian, Mirra, Passage, Pellicle, Perspectives, PostureFit, Public Office Landscape, Resolve, Rodney, Sayl, Setu, Thrive, Tu, Wishbone, and Y-Tower are among the registered trademarks of Herman Miller, Inc., and its owned subsidiaries.

™ 8Z Pellicle, About Face, AireWeave, Albert, Backfit, Bubbletack, Burdick Group, Butterfly Back, Celeste, Cellular Suspension, Clam, Compass, Connect, Cubert, DOT, Duracare, Durawrap, Eames Soft Pad, EnhancedAccess, Everywhere, Flex-Edge, Flute, Harmonic, Herman Miller Select, Hopsak 2, Intent, Iota, Jaw, Keyless Entry, Keyn Chair Group by Herman Miller, Latitude, Locale, Logic Mini, Logic Power Access Solutions, Live OS, Loop, Lyris, Lyris 2, Made-to-Measure Storage, Metaform Portfolio, Mora, Motia, Multiscrim, Nelson, Pari, Pixelated Support, Plex, PostureFit SL, Prospect, Q, Renew, Sense, Soft Pad, Stackable, Stackable Storage, Striad, Swoop, Tone, TriFlex, Twist, Ubi, Verus and Wireframe are among the trademarks of Herman Miller, Inc., and its owned subsidiaries.

SM Herman Miller Options is among the service marks of Herman Miller, Inc.

Alexander Girard® is a registered trademark of The Alexander Girard Estate.

Chemsurf® is a registered trademark of Wilsonart International.

Corian® is a registered trademark of E. I. du Pont de Nemours and Company Corporation.

Crypton® is a registered trademark of Crypton, Inc.

DACRON® is a registered trademark of INVISTA S.a r.l.

Edelman® Leather is a registered trademark of Edelman Leather, Inc.

FENIX NTM® is a registered trademark of Arpa Industriale S.p.A.

FLEXNET™ is a trademark of Milliken & Company.

Floor Saver Glide® is a registered trademark of Carpin Manufacturing, Inc.

Geiger® is a registered trademark, and Bumper™, Saiba™, and Ward Bennett™ are trademarks, of Geiger International.

Goetz™ is a trademark of Mark W. Goetz.

Hang-It-All® is a registered trademark of Lucia Eames Demetrios, d.b.a. Eames Office.

Holophane® is a registered trademark of Holophane.

Ingeo™ is a trademark of Cargill Dow LLC.

iPad® is a registered trademark of Apple, Inc.

LifeSize® is a registered trademark of LifeSize Communications, Inc.

Magis®, Bombo®, and Me Too® are registered trademarks of Magis S.p.A.

Microsoft® and Natural® Keyboard are registered trademarks of Microsoft Corporation.

Noguchi® and the Noguchi table configuration (trade dress) are registered trademarks, and Rudder Table™ is a trademark, of The Isamu Noguchi Foundation and Garden Museum.

Place Textiles® is a registered trademark of Place Textiles.

SuperSeat™ is a trademark of Dahti Seating, a division of ITW.